

Tokyo Big Sight

Overview of Exhibition Facilities

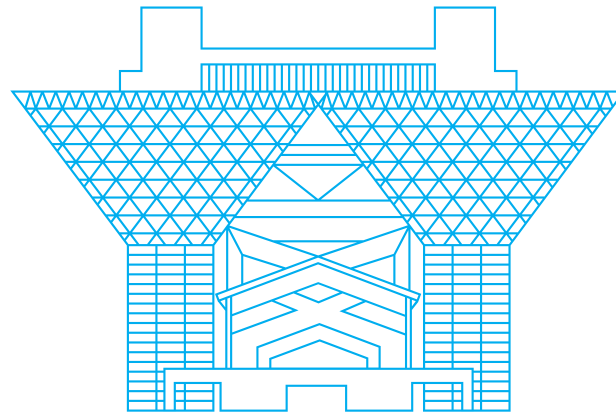

TOKYO BIG SIGHT



INDEX

Floor Plan of Entire Exhibition Facilities 1- 2

East Exhibition Building

Floor Plan of East Exhibition Building	3- 4
East Hall 1	5- 6
East Hall 2	7- 8
East Hall 3	9-10
East Hall 4	11-12
East Hall 5	13-14
East Hall 6	15-16

New East Exhibition Building

East Hall 7	17-18
East Hall 8	19-20
Link Space	21-22

West Exhibition Building

Floor Plan of West Exhibition Building	23-24
West Hall 1	25-26
West Hall 2	27-28
West Hall 3	29-30
West Hall 4	31-32
Atrium	33-34
Rooftop Exhibition Area	35-36

South Exhibition Building

Floor Plan of South Exhibition Building	37-38
South Hall 1	39-40
South Hall 2	41-42
South Hall 3	43-44
South Hall 4	45-46

* The dimensions given are calculated based on the center line of walls and hallways.

Floor Plan of Entire Exhibition Facilities

First Floor Plan

Official name	Tokyo International Exhibition Center	
Common name	Tokyo Big Sight	
Venue size	Total site area	265,751.63 m ²
	Total building area	185,348.54 m ²
	Total floor area	316,992.81 m ²
Size of exhibition facilities	Indoor exhibition area	115,420 m ²
	East Exhibition Hall	51,380 m ² (6 halls)
	East Newexhibition Hall	14,760 m ² (2 halls)
	West Exhibition Hall	29,280 m ² (4 halls)
	South Exhibition Hall	20,000 m ² (4 halls)
	Rooftop exhibition area	6,000 m ²

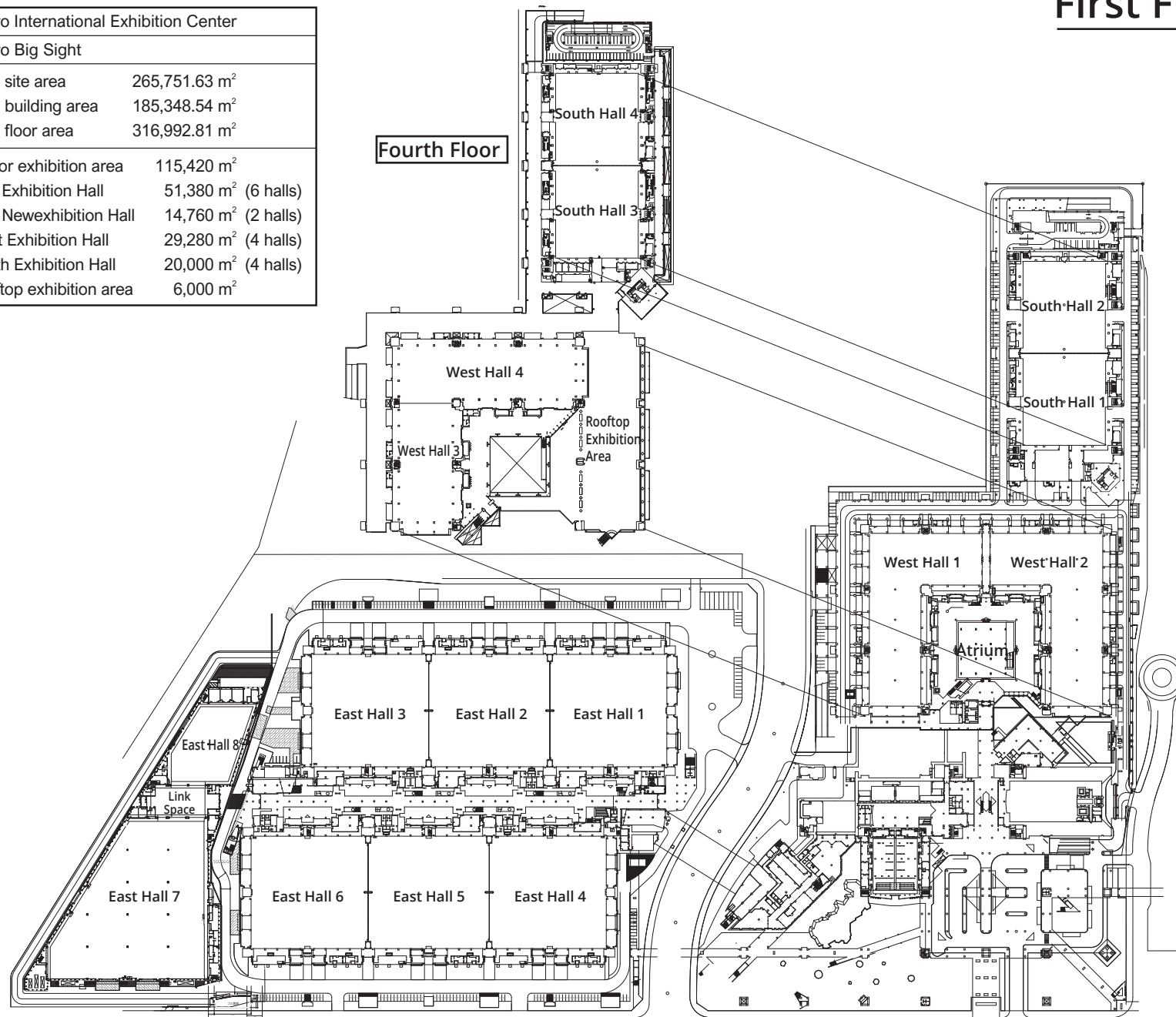

Second Floor Plan

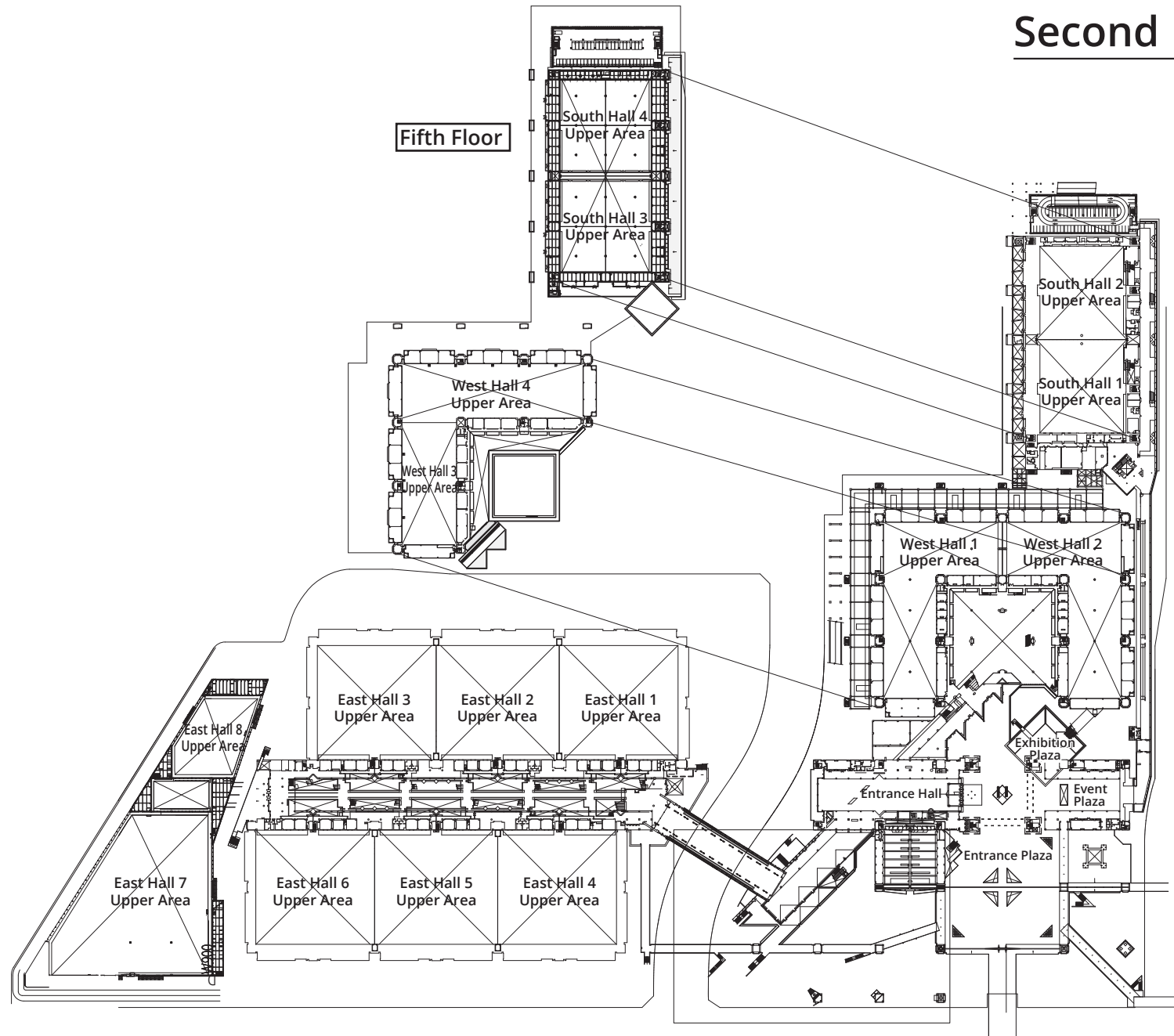

Floor Plan of East Exhibition Building and New East Exhibition Building

First Floor Plan

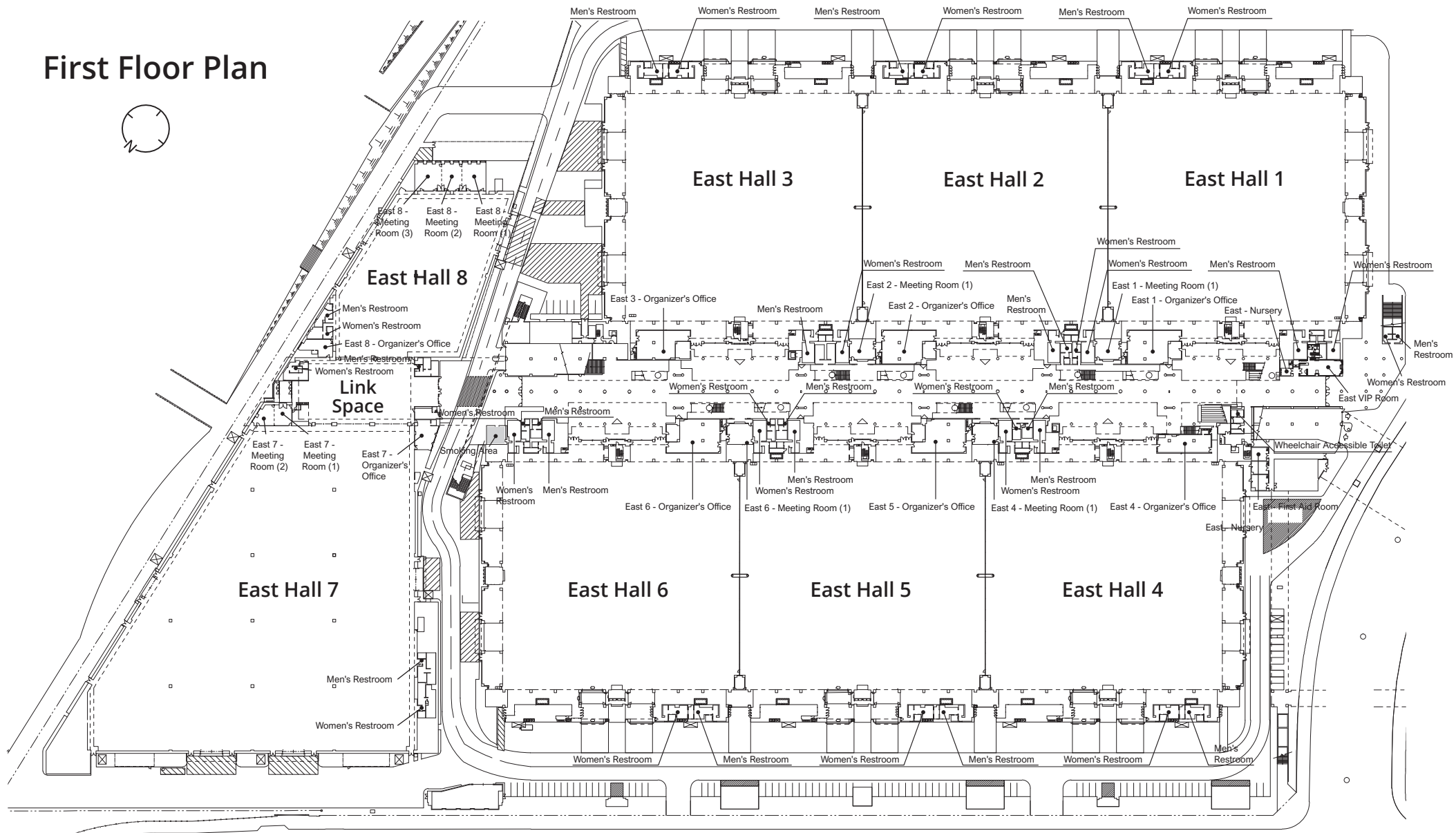

Second Floor Plan

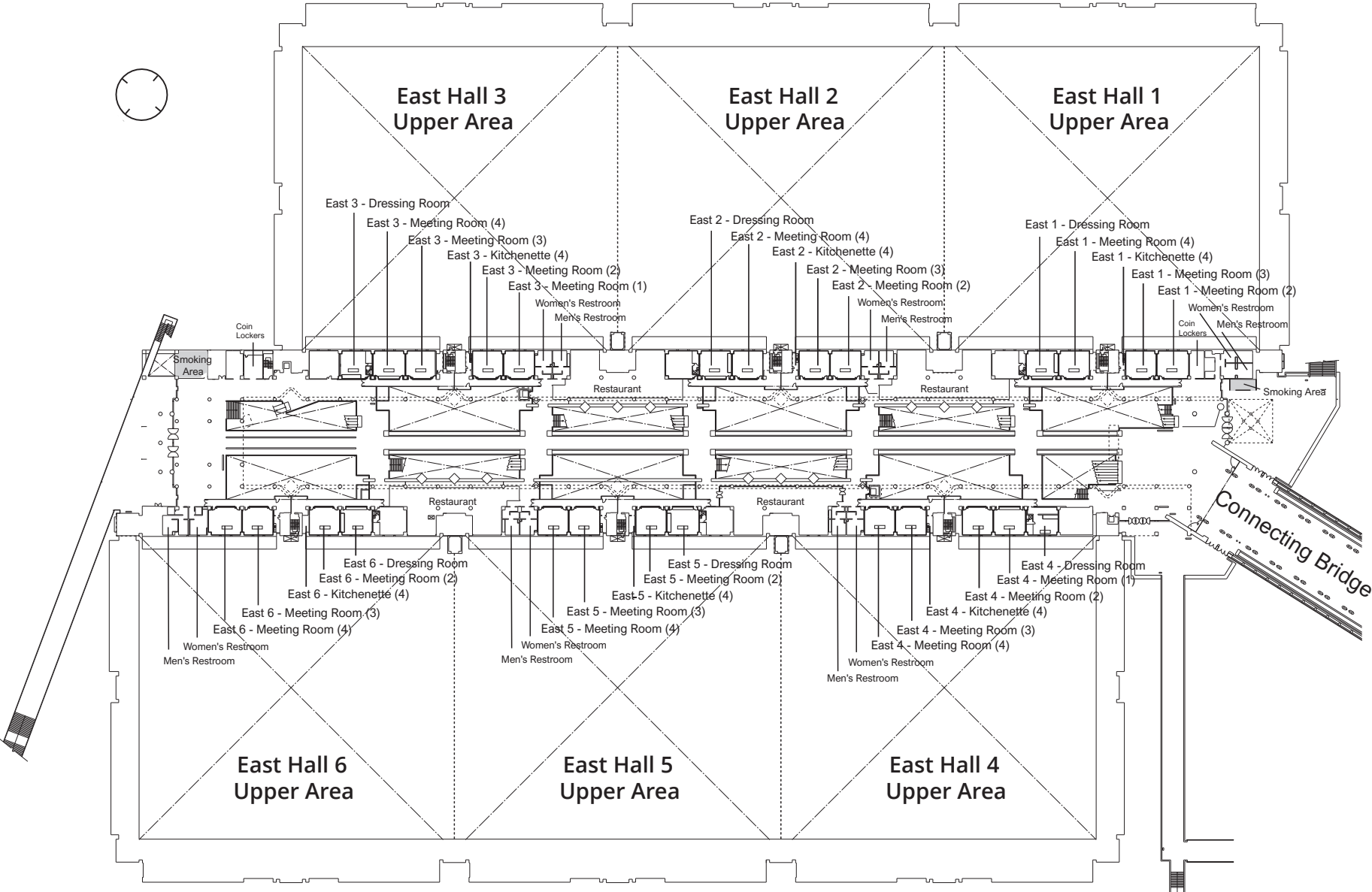

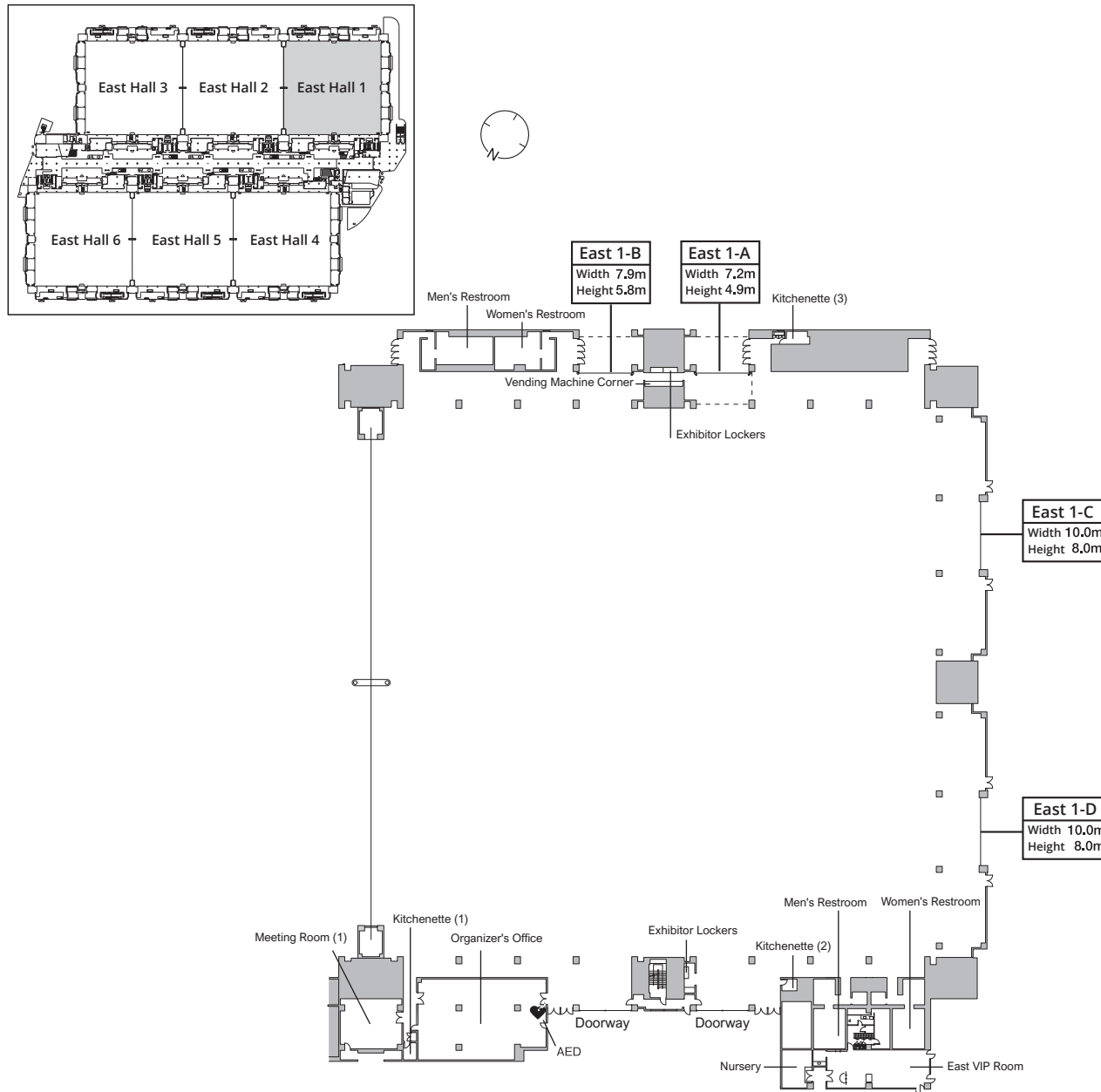

1. Building Facilities

◆Hall exhibition area	8,670 m ²
◆Ceiling height	17 to 31 m
◆Floor construction	Concrete
◆Floor load	5 t/m ²
◆Anchor bolt placement	Possible (Max depth 60 mm, Max size 16 ø)
◆Freight entrances	4 locations (Windbreak shutter at position A)
◆No. of pits	8 main pits (electrical) 8 main pits (mechanical) 4 subsidiary pits

[Side rooms]

1F Organizer's Office (228 m ²)	Meeting Room (1) (69 m ²)
2F Meeting Room (2) (66 m ²)	Meeting Room (3) (63 m ²)
Meeting Room (4) (63 m ²)	Dressing Room (62 m ²)

Total Rooms: 6

*Note Side room areas are calculated based on the internal dimensions.

2. Electrical Facilities *Accessed from electrical service pits in the floor

◆Transformer substations	S12, S13
◆Transformer capacity	Power 500kVA × 4 Lighting 300kVA × 6 200kVA × 2
◆Hall ceiling lighting	HID lighting

3. Communication Facilities * Accessed from subsidiary electrical pits in the floor

◆TV broadcast outlets	64
◆Communication facility outlets	104
◆Communication lines	Analog lines INS 64, high-speed broadband data links

4. Broadcast Facilities * Installed in the organizer's office

◆Input	1 microphone, 1 double cassette player, 1 CD/SD/USB player, 1 CD player 1 AUX (Note: A separate mixer amp is required when using as a microphone input)
◆Intercom	May broadcast to or receive from any hall

5. Machinery

	Outlets inside the exhibition hall	Outlets outside the exhibition hall
Water supply valves Water pressure 3~5Kg/cm ² (0.25~0.49 MPa) (Maximum flow rate 35m ³ /h)	14 locations (2 lines north and south) 1 meter/1 line (1) Main mechanical pit terminal (50ø × 1 BV/location) (2) Header inside mechanical trench (25ø × 3 BV/location) (80ø main pipe)	2 locations (meter must be attached) Truck yard side, wall-mounted (50ø × 1 BV/location)
Drainage outlets	Each pipe drains into a main mechanical pit	Discharges into a 600 □ outside drainage container (150ø drainage pipe)
Compressed air valves and pipe diameter	14 locations/1 line (100ø main pipe) Header inside mechanical trench (50ø × 1 BV/location) (25ø × 3 BV/location)	2 locations/1 line Truck yard side, wall-mounted (100ø × 1 BV/location) (For attachment of compressors, etc.)
Coolant water valves and pipe diameter	7 locations/1 line (125ø main pipe) Header inside mechanical trench (80ø × 1 BV/location) (Truck yard only) (50ø × 1 BV/location)	1 location/1 line Truck yard side, wall-mounted (150ø × 1 BV/location) (For attachment of cooling tower, etc.)
Secondary fire hydrants and diameter	4 locations Inside subsidiary mechanical pits (25ø × 1 fire hose socket/location) (50ø × 1 GV/location)	None

*BV: Ball Valve *BFV: Butterfly Valve *MPa: Megapascals (unit of pressure) *GV: Gate Valve

6. Sanitary Facilities

◆Hall Restrooms

	Men's Restrooms (2 locations)			Women's Restrooms (2 locations)		
	Truck yard side	Galleria side	Total	Truck yard side	Galleria side	Total
Toilet stalls (Western style)	5 (-3)	4 (★1)	9	8 (+3)	12	20
Toilet stalls (Japanese style)	1	1	2	1	1	2
Urinals	9	9	18	1	1	2
Wash basins	4	6	10	5	8	13
Wheelchair accessible toilet	1	1	2	1	1	2
Baby bed	1	1	2	1	1	2

* Truck yard side toilets can be changed
using the movable partition
* ★...Number of ostomate support toilets
included in a total

◆Kitchenette

Inside the hall	Next to the organizer's office	Rooms on the second floor	Total
2	1	1	4

7. Ventilation Equipment

◆Air conditioners	8 per hall		
◆Air conditioning capabilities			
Cooling	8,037 MJ/h	Supplied air (SA)	400,000 m ³ /h
Outside air (OA)	92,000 m ³ /h	Heating	2,813 MJ/h
Recycled air (RA)	400,000 m ³ /h	Exhaust air (EA)	92,000 m ³ /h
Humidification	352 kg/h		

8. Fire Prevention Equipment

◆Indoor fire extinguishers	5 locations
◆Outdoor fire extinguishers	2 locations
◆Fire detector scanning devices	2 locations (one each in the galleria and truck yard side, located 15.5 m above ground)
◆Water cannon system	2 locations (one each in the galleria and truck yard side, located 7.7 m above ground) * The water cannon system links with the abovementioned fire detector scanning devices to automatically extinguish fires
◆Sprinkler system	Sprinkler heads mounted on the ceiling of the main hall and other related rooms
◆Fire alarm system	• Automatic fire alarm system: Fire detectors mounted on the lower ceiling of the main hall and other related rooms • Fire alarm system: Mounted on the walls of the main hall (manually operated with a push button)
◆Smoke control system	• Main hall: Smoke windows installed in the upper areas of the hall • Organizer's offices: Smoke control openings installed (forced smoke control by fans)
◆Fire extinguishers	8 dry chemical extinguishers, 7 fortified liquid extinguishers
◆AED (Automated External Defibrillator)	• Organizer's office

9. Other Facilities Inside the Hall

◆Drink vending machine corner	1 location
◆Garbage disposal	1 location (truck yard)
◆Exhibitor lockers	2 locations

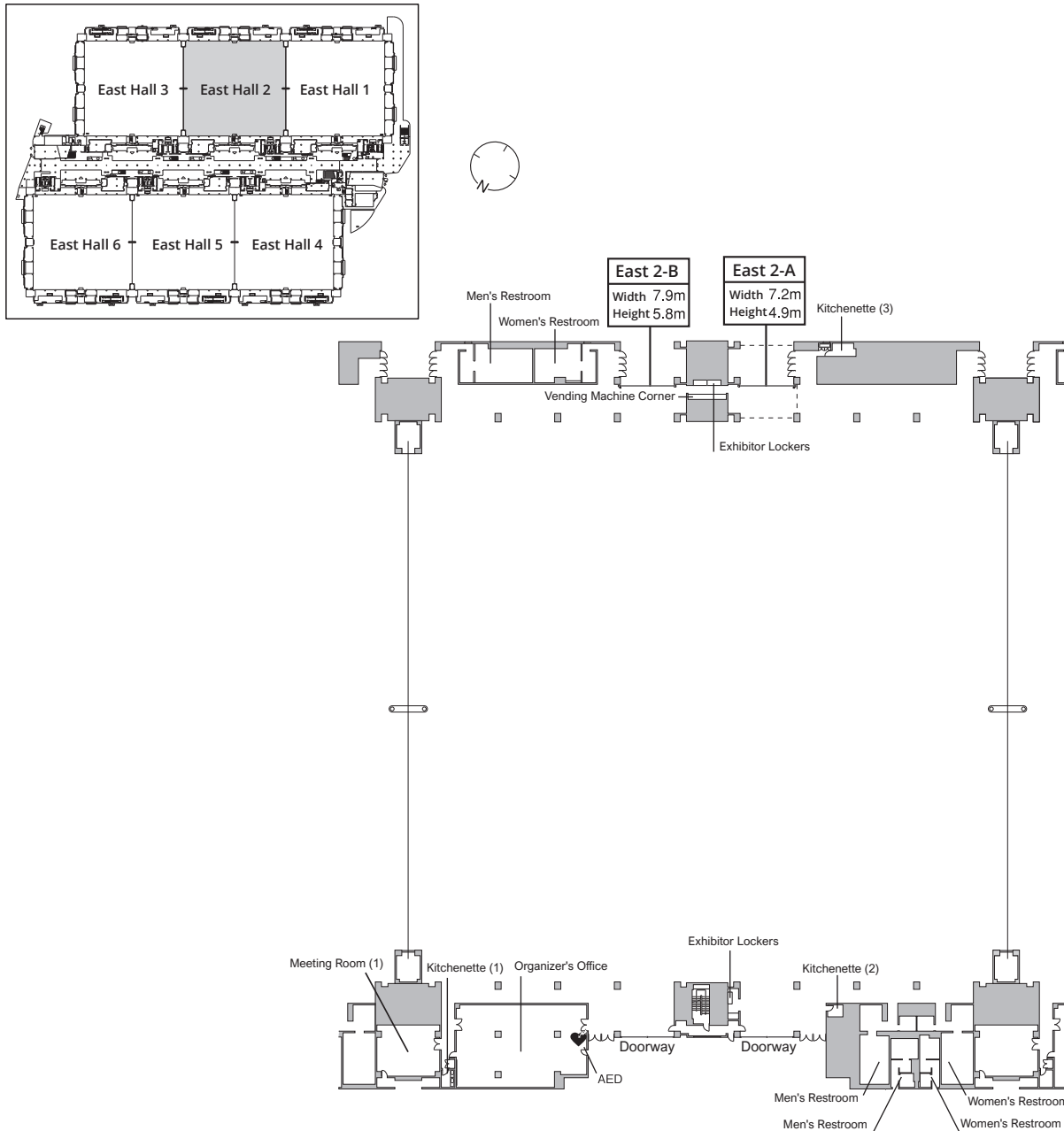

1. Building Facilities

♦Hall exhibition area	8,350 m ²
♦Ceiling height	17 to 31 m
♦Floor construction	Concrete
♦Floor load	5 t/m ²
♦Anchor bolt placement	Possible (Max depth 60 mm, Max size 16 ø)
♦Freight entrances	2 locations (Windbreak shutter at position A)
♦No. of pits	8 main pits (electrical) 7 main pits (mechanical) 4 subsidiary pits

[Side rooms]

1F Organizer's Office (227 m ²)	Meeting Room (1) (69 m ²)
2F Meeting Room (2) (63 m ²)	Meeting Room (3) (63 m ²)
Meeting Room (4) (63 m ²)	Dressing Room (62 m ²)

Total Rooms: 6

*Note Side room areas are calculated based on the internal dimensions.

2. Electrical Facilities *Accessed from electrical service pits in the floor

♦Transformer substations	S13, S19
♦Transformer capacity	Power 500kVA × 4 Lighting 300kVA × 6 200kVA × 2
♦Hall ceiling lighting	HID lighting

3. Communication Facilities * Accessed from subsidiary electrical pits in the floor

♦TV broadcast outlets	64
♦Communication facility outlets	104
♦Communication lines	Analog lines INS 64, high-speed broadband data links

4. Broadcast Facilities * Installed in the organizer's office

♦Input	1 microphone, 1 double cassette player, 1 CD/SD/USB player, 1 CD player 1 AUX (Note: A separate mixer amp is required when using as a microphone input)
♦Intercom	May broadcast to or receive from any hall

5. Machinery

	Outlets inside the exhibition hall	Outlets outside the exhibition hall
Water supply valves Water pressure 3~5Kg/cm ² (0.25~0.49 MPa) (Maximum flow rate 35m ³ /h)	14 locations (2 lines north and south) 1 meter/1 line (1) Main mechanical pit terminal (50ø × 1 BV/location) (2) Header inside mechanical trench (25ø × 3 BV/location) (80ø main pipe)	2 locations (meter must be attached) Truck yard side, wall-mounted (50ø × 1 BV/location)
Drainage outlets	Each pipe drains into a main mechanical pit	Discharges into a 600 □ outside drainage container (150ø drainage pipe)
Compressed air valves and pipe diameter	14 locations/1 line (100ø main pipe) Header inside mechanical trench (50ø × 1 BV/location) (25ø × 3 BV/location)	2 locations/1 line Truck yard side, wall-mounted (100ø × 1 BFV/location) (For attachment of compressors, etc.)
Coolant water valves and pipe diameter	7 locations/1 line (125ø main pipe) Header inside mechanical trench (80ø × 1 BFV/location) (Truck yard only) (50ø × 1 BV/location)	2 locations/1 line Truck yard side, wall-mounted (150ø × 1 BFV/location) (For attachment of cooling tower, etc.)
Secondary fire hydrants and diameter	4 locations Inside subsidiary mechanical pits (25ø × 1 fire hose socket/location) (50ø × 1 GV/location)	None

*BV: Ball Valve *BFV: Butterfly Valve *MPa: Megapascals (unit of pressure) *GV: Gate Valve

6. Sanitary Facilities

◆Hall Restrooms

	Men's Restrooms (2 locations)			Women's Restrooms (2 locations)		
	Truck yard side	Galleria side	Total	Truck yard side	Galleria side	Total
Toilet stalls (Western style)	5 (-3)	4 (★1)	9	8 (+3)	12 (★1)	20
Toilet stalls (Japanese style)	1	1	2	1	1	2
Urinals	9	10	19	1	1	2
Wash basins	4	6	10	5	8	13
Wheelchair accessible toilet	1	1	2	1	1	2
Baby bed	1	1	2	1	1	2

* Truck yard side toilets can be changed
using the movable partition
* ★...Number of ostomate support toilets
included in a total

◆Kitchenette

Inside the hall	Next to the organizer's office	Rooms on the second floor	Total
2	1	1	4

7. Ventilation Equipment

◆Air conditioners	8 per hall		
◆Air conditioning capabilities			
Cooling	8,037 MJ/h	Supplied air (SA)	400,000 m ³ /h
Outside air (OA)	92,000 m ³ /h	Heating	2,813 MJ/h
Recycled air (RA)	400,000 m ³ /h	Exhaust air (EA)	92,000 m ³ /h
Humidification	352 kg/h		

8. Fire Prevention Equipment

◆Indoor fire extinguishers	5 locations
◆Outdoor fire extinguishers	2 locations
◆Fire detector scanning devices	2 locations (one each in the galleria and truck yard side, located 15.5 m above ground)
◆Water cannon system	2 locations (one each in the galleria and truck yard side, located 7.7 m above ground) * The water cannon system links with the abovementioned fire detector scanning devices to automatically extinguish fires
◆Sprinkler system	Sprinkler heads mounted on the ceiling of the main hall and other related rooms
◆Fire alarm system	• Automatic fire alarm system: Fire detectors mounted on the lower ceiling of the main hall and other related rooms • Fire alarm system: Mounted on the walls of the main hall (manually operated with a push button)
◆Smoke control system	• Main hall: Smoke windows installed in the upper areas of the hall • Organizer's offices: Smoke control openings installed (forced smoke control by fans)
◆Fire extinguishers	7 dry chemical extinguishers, 7 fortified liquid extinguishers
◆AED (Automated External Defibrillator)	• Organizer's office

9. Other Facilities Inside the Hall

◆Drink vending machine corner	1 location
◆Garbage disposal	1 location (truck yard)
◆Exhibitor lockers	2 locations

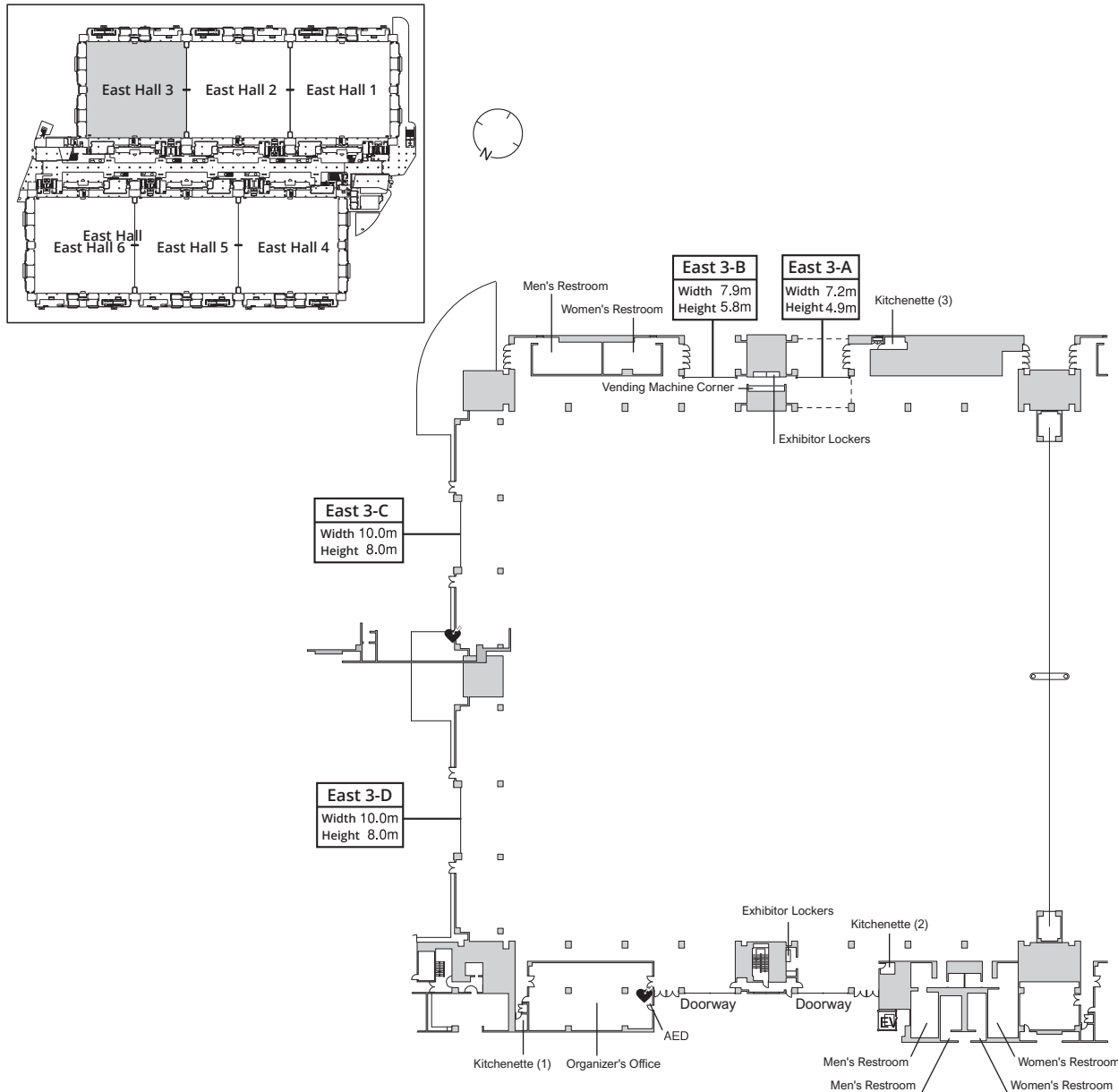

1. Building Facilities

♦Hall exhibition area	8,670 m ²
♦Ceiling height	17 to 31 m
♦Floor construction	Concrete
♦Floor load	5 t/m ²
♦Anchor bolt placement	Possible (Max depth 60 mm, Max size 16 ø)
♦Freight entrances	4 locations (Windbreak shutter at position A)
♦No. of pits	8 main pits (electrical) 8 main pits (mechanical) 4 subsidiary pits

[Side rooms]

1F Organizer's Office (203 m ²)	
2F Meeting Room (1) (63 m ²)	Meeting Room (2) (63 m ²)
Meeting Room (3) (63 m ²)	Meeting Room (4) (62 m ²)
Dressing Room (66 m ²)	

Total Rooms: 6

*Note Side room areas are calculated based on the internal dimensions.

2. Electrical Facilities *Accessed from electrical service pits in the floor

♦Transformer substations	S14, S20
♦Transformer capacity	Power 500kVA × 4 Lighting 300kVA × 6 200kVA × 2
♦Hall ceiling lighting	HID lighting

3. Communication Facilities * Accessed from subsidiary electrical pits in the floor

♦TV broadcast outlets	64
♦Communication facility outlets	104
♦Communication lines	Analog lines INS 64, high-speed broadband data links

4. Broadcast Facilities * Installed in the organizer's office

♦Input	1 microphone, 1 double cassette player, 1 CD/SD/USB player, 1 CD player 1 AUX (Note: A separate mixer amp is required when using as a microphone input)
♦Intercom	May broadcast to or receive from any hall

5. Machinery

	Outlets inside the exhibition hall	Outlets outside the exhibition hall
Water supply valves Water pressure 3~5Kg/cm ² (0.25~0.49 MPa) (Maximum flow rate 35m ³ /h)	14 locations (2 lines north and south) 1 meter/1 line (1) Main mechanical pit terminal (50ø × 1 BV/location) (2) Header inside mechanical trench (25ø × 3 BV/location) (80ø main pipe)	2 locations (meter must be attached) Truck yard side, wall-mounted (50ø × 1 BV/location)
Drainage outlets	Each pipe drains into a main mechanical pit	Discharges into a 600 □ outside drainage container (150ø drainage pipe)
Compressed air valves and pipe diameter	14 locations/1 line (100ø main pipe) Header inside mechanical trench (50ø × 1 BV/location) (25ø × 3 BV/location)	2 locations/1 line Truck yard side, wall-mounted (100ø × 1 BFV/location) (For attachment of compressors, etc.)
Coolant water valves and pipe diameter	7 locations/1 line (125ø main pipe) Header inside mechanical trench (80ø × 1 BFV/location) (Truck yard only) (50ø × 1 BV/location)	1 location/1 line Truck yard side, wall-mounted (150ø × 1 BFV/location) (For attachment of cooling tower, etc.)
Secondary fire hydrants and diameter	4 locations Inside subsidiary mechanical pits (25ø × 1 fire hose socket/location) (50ø × 1 GV/location)	None

*BV: Ball Valve *BFV: Butterfly Valve *MPa: Megapascals (unit of pressure) *GV: Gate Valve

6. Sanitary Facilities

◆Hall Restrooms

	Men's Restrooms (2 locations)			Women's Restrooms (2 locations)		
	Truck yard side	Galleria side	Total	Truck yard side	Galleria side	Total
Toilet stalls (Western style)	5 (-3)	4 (★1)	9	8 (+3)	12 (★1)	20
Toilet stalls (Japanese style)	1	1	2	1	1	2
Urinals	9	10	19	1	1	2
Wash basins	4	6	10	5	8	13
Wheelchair accessible toilet	1	1	2	1	1	2
Baby bed	1	1	2	1	1	2

* Truck yard side toilets can be changed
using the movable partition
* ★...Number of ostomate support toilets
included in a total

◆Kitchenette

Inside the hall	Next to the organizer's office	Rooms on the second floor	Total
2	1	1	4

7. Ventilation Equipment

◆Air conditioners	8 per hall		
◆Air conditioning capabilities			
Cooling	8,037 MJ/h	Supplied air (SA)	400,000 m ³ /h
Outside air (OA)	92,000 m ³ /h	Heating	2,813 MJ/h
Recycled air (RA)	400,000 m ³ /h	Exhaust air (EA)	92,000 m ³ /h
Humidification	352 kg/h		

8. Fire Prevention Equipment

◆Indoor fire extinguishers	5 locations
◆Outdoor fire extinguishers	2 locations
◆Fire detector scanning devices	2 locations (one each in the galleria and truck yard side, located 15.5 m above ground)
◆Water cannon system	2 locations (one each in the galleria and truck yard side, located 7.7 m above ground) * The water cannon system links with the abovementioned fire detector scanning devices to automatically extinguish fires
◆Sprinkler system	Sprinkler heads mounted on the ceiling of the main hall and other related rooms
◆Fire alarm system	• Automatic fire alarm system: Fire detectors mounted on the lower ceiling of the main hall and other related rooms • Fire alarm system: Mounted on the walls of the main hall (manually operated with a push button)
◆Smoke control system	• Main hall: Smoke windows installed in the upper areas of the hall • Organizer's offices: Smoke control openings installed (forced smoke control by fans)
◆Fire extinguishers	9 dry chemical extinguishers, 8 fortified liquid extinguishers
◆AED (Automated External Defibrillator)	• Organizer's office

9. Other Facilities Inside the Hall

◆Drink vending machine corner	1 location
◆Garbage disposal	1 location (truck yard)
◆Exhibitor lockers	2 locations

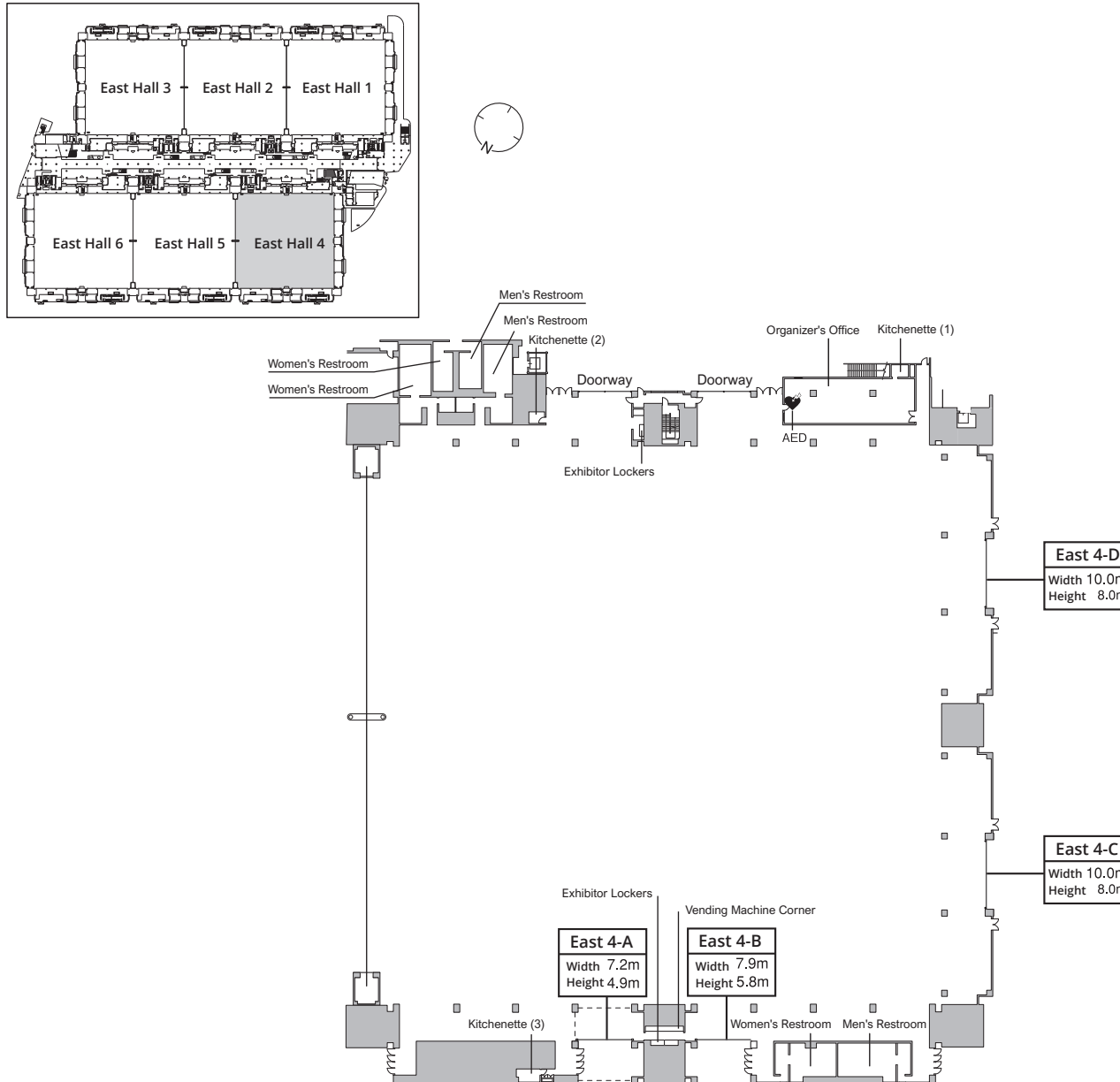

1. Building Facilities

◆Hall exhibition area	8,670 m ²
◆Ceiling height	17 to 31 m
◆Floor construction	Concrete
◆Floor load	5 t/m ²
◆Anchor bolt placement	Possible (Max depth 60 mm, Max size 16 ø)
◆Freight entrances	4 locations (Windbreak shutter at position A)
◆No. of pits	8 main pits (electrical) 8 main pits (mechanical) 4 subsidiary pits

[Side rooms]

1F	Organizer's Office (125 m ²)	
2F	Meeting Room (1) (62 m ²)	Meeting Room (2) (63 m ²)
	Meeting Room (3) (63 m ²)	Meeting Room (4) (63 m ²)
	Dressing Room (38 m ²)	

Total Rooms: 6

*Note Side room areas are calculated based on the internal dimensions.

2. Electrical Facilities *Accessed from electrical service pits in the floor

◆Transformer substations	S17, S23
◆Transformer capacity	Power 500kVA × 4 Lighting 300kVA × 6 200kVA × 2
◆Hall ceiling lighting	HID lighting

3. Communication Facilities * Accessed from subsidiary electrical pits in the floor

◆TV broadcast outlets	64
◆Communication facility outlets	104
◆Communication lines	Analog lines INS 64, high-speed broadband data links

4. Broadcast Facilities * Installed in the organizer's office

◆Input	1 microphone, 1 double cassette player, 1 CD/SD/USB player, 1 CD player 1 AUX (Note: A separate mixer amp is required when using as a microphone input)
◆Intercom	May broadcast to or receive from any hall

5. Machinery

	Outlets inside the exhibition hall	Outlets outside the exhibition hall
Water supply valves Water pressure 3~5Kg/cm ² (0.25~0.49 MPa) (Maximum flow rate 35m ³ /h)	14 locations (2 lines north and south) 1 meter/1 line (1) Main mechanical pit terminal (50ø × 1 BV/location) (2) Header inside mechanical trench (25ø × 3 BV/location) (80ø main pipe)	2 locations (meter must be attached) Truck yard side, wall-mounted (50ø × 1 BV/location)
Drainage outlets	Each pipe drains into a main mechanical pit	Discharges into a 600 □ outside drainage container (150ø drainage pipe)
Compressed air valves and pipe diameter	14 locations/1 line (100ø main pipe) Header inside mechanical trench (50ø × 1 BV/location) (25ø × 3 BV/location)	2 locations/1 line Truck yard side, wall-mounted (100ø × 1 BV/location) (For attachment of compressors, etc.)
Coolant water valves and pipe diameter	7 locations/1 line (125ø main pipe) Header inside mechanical trench (80ø × 1 BFV/location) (Truck yard only) (50ø × 1 BV/location)	1 location/1 line Truck yard side, wall-mounted (150ø × 1 BFV/location) (For attachment of cooling tower, etc.)
Secondary fire hydrants and diameter	4 locations Inside subsidiary mechanical pits (25ø × 1 fire hose socket/location) (50ø × 1 GV/location)	None

*BV: Ball Valve *BFV: Butterfly Valve *MPa: Megapascals (unit of pressure) *GV: Gate Valve

6. Sanitary Facilities

◆Hall Restrooms

	Men's Restrooms (2 locations)			Women's Restrooms (2 locations)		
	Truck yard side	Galleria side	Total	Truck yard side	Galleria side	Total
Toilet stalls (Western style)	5 (-3)	4 (★1)	9	8 (+3)	12 (★1)	20
Toilet stalls (Japanese style)	1	1	2	1	1	2
Urinals	9	10	19	1	1	2
Wash basins	4	6	10	5	8	13
Wheelchair accessible toilet	1	1	2	1	1	2
Baby bed	1	1	2	1	1	2

* Truck yard side toilets can be changed
using the movable partition
* ★...Number of ostomate support toilets
included in a total

◆Kitchenette

Inside the hall	Next to the organizer's office	Rooms on the second floor	Total
2	1	1	4

7. Ventilation Equipment

◆Air conditioners	8 per hall		
◆Air conditioning capabilities			
Cooling	8,037 MJ/h	Supplied air (SA)	400,000 m ³ /h
Outside air (OA)	92,000 m ³ /h	Heating	2,813 MJ/h
Recycled air (RA)	400,000 m ³ /h	Exhaust air (EA)	92,000 m ³ /h
Humidification	352 kg/h		

8. Fire Prevention Equipment

◆Indoor fire extinguishers	5 locations
◆Outdoor fire extinguishers	2 locations
◆Fire detector scanning devices	2 locations (one each in the galleria and truck yard side, located 15.5 m above ground)
◆Water cannon system	2 locations (one each in the galleria and truck yard side, located 7.7 m above ground) * The water cannon system links with the abovementioned fire detector scanning devices to automatically extinguish fires
◆Sprinkler system	Sprinkler heads mounted on the ceiling of the main hall and other related rooms
◆Fire alarm system	• Automatic fire alarm system: Fire detectors mounted on the lower ceiling of the main hall and other related rooms • Fire alarm system: Mounted on the walls of the main hall (manually operated with a push button)
◆Smoke control system	• Main hall: Smoke windows installed in the upper areas of the hall • Organizer's offices: Smoke control openings installed (forced smoke control by fans)
◆Fire extinguishers	10 dry chemical extinguishers, 6 fortified liquid extinguishers
◆AED (Automated External Defibrillator)	• Organizer's office

9. Other Facilities Inside the Hall

◆Drink vending machine corner	1 location
◆Garbage disposal	1 location (truck yard)
◆Exhibitor lockers	2 locations

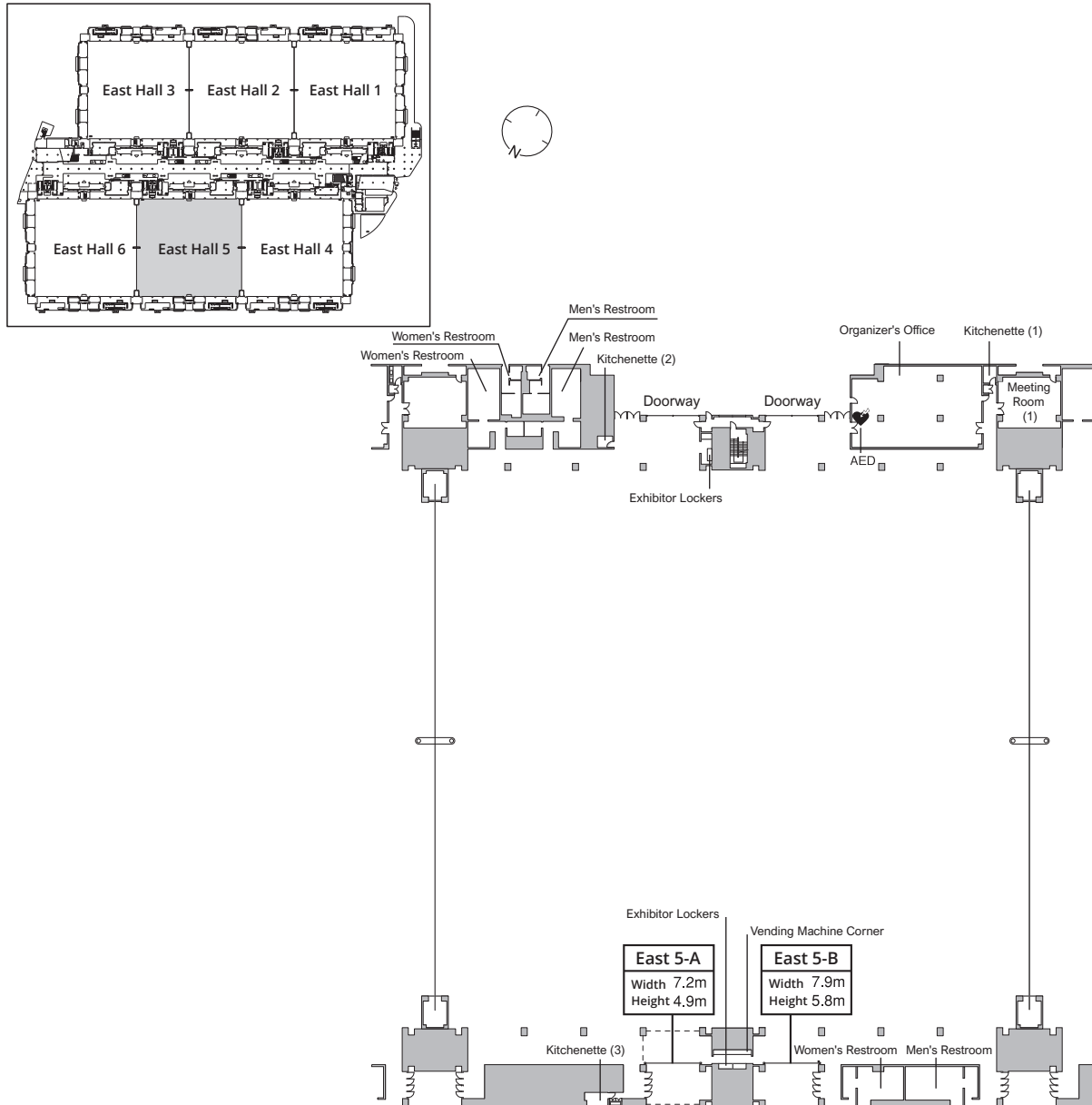

1. Building Facilities

◆Hall exhibition area	8,350 m ²
◆Ceiling height	17 to 31 m
◆Floor construction	Concrete
◆Floor load	5 t/m ²
◆Anchor bolt placement	Possible (Max depth 60 mm, Max size 16 ø)
◆Freight entrances	2 locations (Windbreak shutter at position A)
◆No. of pits	8 main pits (electrical) 7 main pits (mechanical) 4 subsidiary pits

[Side rooms]

1F Organizer's Office (227 m ²)	Meeting Room (1) (69 m ²)
2F Meeting Room (2) (63 m ²)	Meeting Room (3) (63 m ²)
Meeting Room (4) (63 m ²)	Dressing Room (62 m ²)

Total Rooms: 6

*Note Side room areas are calculated based on the internal dimensions.

2. Electrical Facilities *Accessed from electrical service pits in the floor

◆Transformer substations	S16, S22
◆Transformer capacity	Power 500kVA × 4 Lighting 300kVA × 6 200kVA × 2
◆Hall ceiling lighting	HID lighting

3. Communication Facilities * Accessed from subsidiary electrical pits in the floor

◆TV broadcast outlets	64
◆Communication facility outlets	104
◆Communication lines	Analog lines INS 64, high-speed broadband data links

4. Broadcast Facilities * Installed in the organizer's office

◆Input	1 microphone, 1 double cassette player, 1 CD/SD/USB player, 1 CD player 1 AUX (Note: A separate mixer amp is required when using as a microphone input)
◆Intercom	May broadcast to or receive from any hall

5. Machinery

	Outlets inside the exhibition hall	Outlets outside the exhibition hall
Water supply valves Water pressure 3~5Kg/cm ² (0.25~0.49 MPa) (Maximum flow rate 35m ³ /h)	14 locations (2 lines north and south) 1 meter/1 line (1) Main mechanical pit terminal (50ø × 1 BV/location) (2) Header inside mechanical trench (25ø × 3 BV/location) (80ø main pipe)	2 locations (meter must be attached) Truck yard side, wall-mounted (50ø × 1 BV/location)
Drainage outlets	Each pipe drains into a main mechanical pit	Discharges into a 600 □ outside drainage container (150ø drainage pipe)
Compressed air valves and pipe diameter	14 locations/1 line (100ø main pipe) Header inside mechanical trench (50ø × 1 BV/location) (25ø × 3 BV/location)	2 locations/1 line Truck yard side, wall-mounted (100ø × 1 BFV/location) (For attachment of compressors, etc.)
Coolant water valves and pipe diameter	7 locations/1 line (125ø main pipe) Header inside mechanical trench (80ø × 1 BFV/location) (Truck yard only) (50ø × 1 BV/location)	1 location/1 line Truck yard side, wall-mounted (150ø × 1 BFV/location) (For attachment of cooling tower, etc.)
Secondary fire hydrants and diameter	4 locations Inside subsidiary mechanical pits (25ø × 1 fire hose socket/location) (50ø × 1 GV/location)	None

*BV: Ball Valve *BFV: Butterfly Valve *MPa: Megapascals (unit of pressure) *GV: Gate Valve

6. Sanitary Facilities

◆Hall Restrooms

	Men's Restrooms (2 locations)			Women's Restrooms (2 locations)		
	Truck yard side	Galleria side	Total	Truck yard side	Galleria side	Total
Toilet stalls (Western style)	5 (-3)	4 (★1)	9	8 (+3)	12 (★1)	20
Toilet stalls (Japanese style)	1	1	2	1	1	2
Urinals	9	10	19	1	1	2
Wash basins	4	6	10	5	8	13
Wheelchair accessible toilet	1	1	2	1	1	2
Baby bed	1	1	2	1	1	2

* Truck yard side toilets can be changed
using the movable partition

* ★...Number of ostomate support toilets
included in a total

◆Kitchenette

Inside the hall	Next to the organizer's office	Rooms on the second floor	Total
2	1	1	4

7. Ventilation Equipment

◆Air conditioners	8 per hall		
◆Air conditioning capabilities			
Cooling	8,037 MJ/h	Supplied air (SA)	400,000 m ³ /h
Outside air (OA)	92,000 m ³ /h	Heating	2,813 MJ/h
Recycled air (RA)	400,000 m ³ /h	Exhaust air (EA)	92,000 m ³ /h
Humidification	352 kg/h		

8. Fire Prevention Equipment

◆Indoor fire extinguishers	5 locations
◆Outdoor fire extinguishers	2 locations
◆Fire detector scanning devices	2 locations (one each in the galleria and truck yard side, located 15.5 m above ground)
◆Water cannon system	2 locations (one each in the galleria and truck yard side, located 7.7 m above ground) * The water cannon system links with the abovementioned fire detector scanning devices to automatically extinguish fires
◆Sprinkler system	Sprinkler heads mounted on the ceiling of the main hall and other related rooms
◆Fire alarm system	• Automatic fire alarm system: Fire detectors mounted on the lower ceiling of the main hall and other related rooms • Fire alarm system: Mounted on the walls of the main hall (manually operated with a push button)
◆Smoke control system	• Main hall: Smoke windows installed in the upper areas of the hall • Organizer's offices: Smoke control openings installed (forced smoke control by fans)
◆Fire extinguishers	6 dry chemical extinguishers, 5 fortified liquid extinguishers
◆AED (Automated External Defibrillator)	• Organizer's office

9. Other Facilities Inside the Hall

◆Drink vending machine corner	1 location
◆Garbage disposal	1 location (truck yard)
◆Exhibitor lockers	2 locations

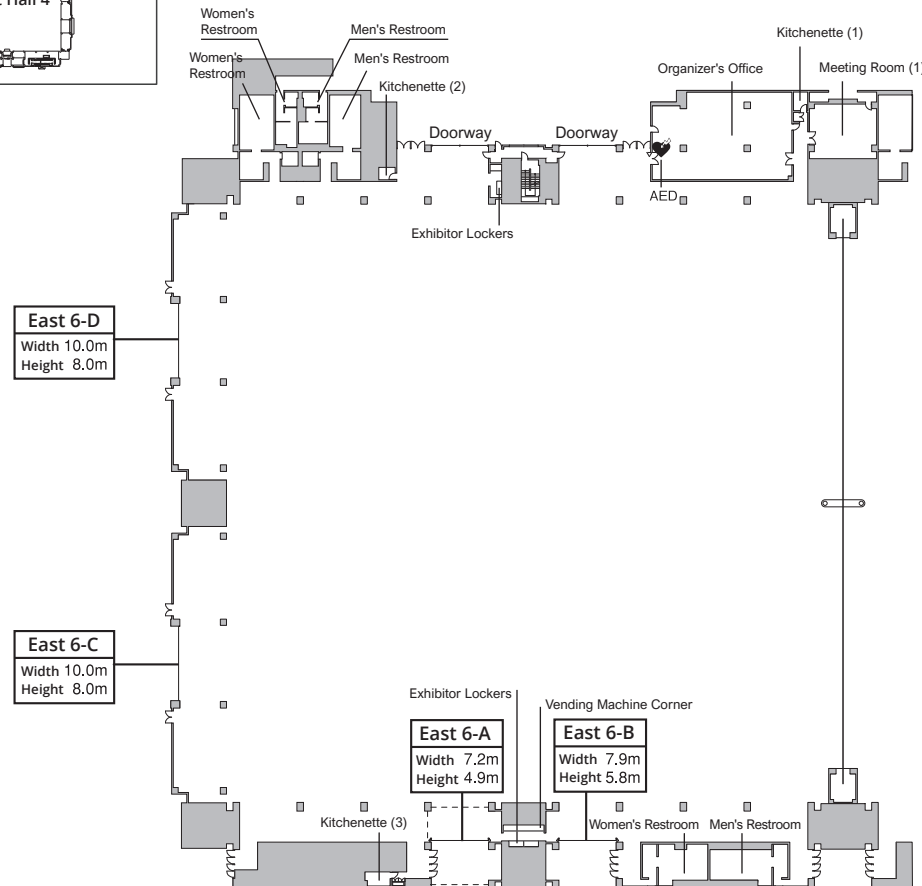
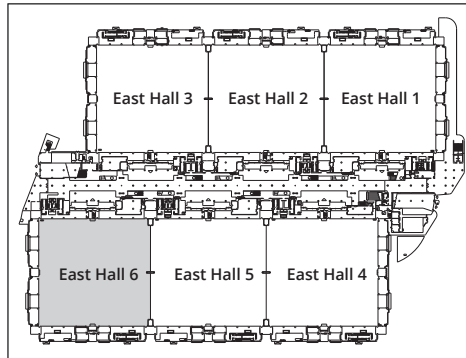

1. Building Facilities

◆Hall exhibition area	8,670 m ²
◆Ceiling height	17 to 31 m
◆Floor construction	Concrete
◆Floor load	5 t/m ²
◆Anchor bolt placement	Possible (Max depth 60 mm, Max size 16 ø)
◆Freight entrances	4 locations (Windbreak shutter at position A)
◆No. of pits	8 main pits (electrical) 8 main pits (mechanical) 4 subsidiary pits

[Side rooms]

1F Organizer's Office (228 m ²)	Meeting Room (1) (69 m ²)
2F Meeting Room (2) (63 m ²)	Meeting Room (3) (63 m ²)
Meeting Room (4) (68 m ²)	Dressing Room (62 m ²)

Total Rooms: 6

*Note Side room areas are calculated based on the internal dimensions.

2. Electrical Facilities *Accessed from electrical service pits in the floor

◆Transformer substations	S15, S21
◆Transformer capacity	Power 500kVA × 4 Lighting 300kVA × 6 200kVA × 2
◆Hall ceiling lighting	HID lighting

3. Communication Facilities * Accessed from subsidiary electrical pits in the floor

◆TV broadcast outlets	64
◆Communication facility outlets	104
◆Communication lines	Analog lines INS 64, high-speed broadband data links

4. Broadcast Facilities * Installed in the organizer's office

◆Input	1 microphone, 1 double cassette player, 1 CD/SD/USB player, 1 CD player 1 AUX (Note: A separate mixer amp is required when using as a microphone input)
◆Intercom	May broadcast to or receive from any hall

5. Machinery

	Outlets inside the exhibition hall	Outlets outside the exhibition hall
Water supply valves Water pressure 3~5Kg/cm ² (0.25~0.49 MPa) (Maximum flow rate 35m ³ /h)	14 locations (2 lines north and south) 1 meter/1 line (1) Main mechanical pit terminal (50ø × 1 BV/location) (2) Header inside mechanical trench (25ø × 3 BV/location) (80ø main pipe)	2 locations (meter must be attached) Truck yard side, wall-mounted (50ø × 1 BV/location)
Drainage outlets	Each pipe drains into a main mechanical pit	Discharges into a 600 □ outside drainage container (150ø drainage pipe)
Compressed air valves and pipe diameter	14 locations/1 line (100ø main pipe) Header inside mechanical trench (50ø × 1 BV/location) (25ø × 3 BV/location)	2 locations/1 line Truck yard side, wall-mounted (100ø × 1 BFV/location) (For attachment of compressors, etc.)
Coolant water valves and pipe diameter	7 locations/1 line (125ø main pipe) Header inside mechanical trench (80ø × 1 BFV/location) (Truck yard only) (50ø × 1 BV/location)	1 location/1 line Truck yard side, wall-mounted (150ø × 1 BFV/location) (For attachment of cooling tower, etc.)
Secondary fire hydrants and diameter	4 locations Inside subsidiary mechanical pits (25ø × 1 fire hose socket/location) (50ø × 1 GV/location)	None

*BV: Ball Valve *BFV: Butterfly Valve *MPa: Megapascals (unit of pressure) *GV: Gate Valve

6. Sanitary Facilities

◆Hall Restrooms

	Men's Restrooms (2 locations)			Women's Restrooms (2 locations)		
	Truck yard side	Galleria side	Total	Truck yard side	Galleria side	Total
Toilet stalls (Western style)	5 (-3)	4 (★1)	9	8 (+3)	12 (★1)	20
Toilet stalls (Japanese style)	1	1	2	1	1	2
Urinals	9	10	19	1	1	2
Wash basins	4	6	10	5	8	13
Wheelchair accessible toilet	1	1	2	1	1	2
Baby bed	1	1	2	1	1	2

* Truck yard side toilets can be changed
using the movable partition
* ★...Number of ostomate support toilets
included in a total

◆Kitchenette

Inside the hall	Next to the organizer's office	Rooms on the second floor	Total
2	1	1	4

7. Ventilation Equipment

◆Air conditioners	8 per hall		
◆Air conditioning capabilities			
Cooling	8,037 MJ/h	Supplied air (SA)	400,000 m ³ /h
Outside air (OA)	92,000 m ³ /h	Heating	2,813 MJ/h
Recycled air (RA)	400,000 m ³ /h	Exhaust air (EA)	92,000 m ³ /h
Humidification	352 kg/h		

8. Fire Prevention Equipment

◆Indoor fire extinguishers	5 locations
◆Outdoor fire extinguishers	2 locations
◆Fire detector scanning devices	2 locations (one each in the galleria and truck yard side, located 15.5 m above ground)
◆Water cannon system	2 locations (one each in the galleria and truck yard side, located 7.7 m above ground) * The water cannon system links with the abovementioned fire detector scanning devices to automatically extinguish fires
◆Sprinkler system	Sprinkler heads mounted on the ceiling of the main hall and other related rooms
◆Fire alarm system	• Automatic fire alarm system: Fire detectors mounted on the lower ceiling of the main hall and other related rooms • Fire alarm system: Mounted on the walls of the main hall (manually operated with a push button)
◆Smoke control system	• Main hall: Smoke windows installed in the upper areas of the hall • Organizer's offices: Smoke control openings installed (forced smoke control by fans)
◆Fire extinguishers	8 dry chemical extinguishers, 8 fortified liquid extinguishers
◆AED (Automated External Defibrillator)	• Organizer's office

9. Other Facilities Inside the Hall

◆Drink vending machine corner	1 location
◆Garbage disposal	1 location (truck yard)
◆Exhibitor lockers	2 locations

New East Exhibition Building East Hall 7

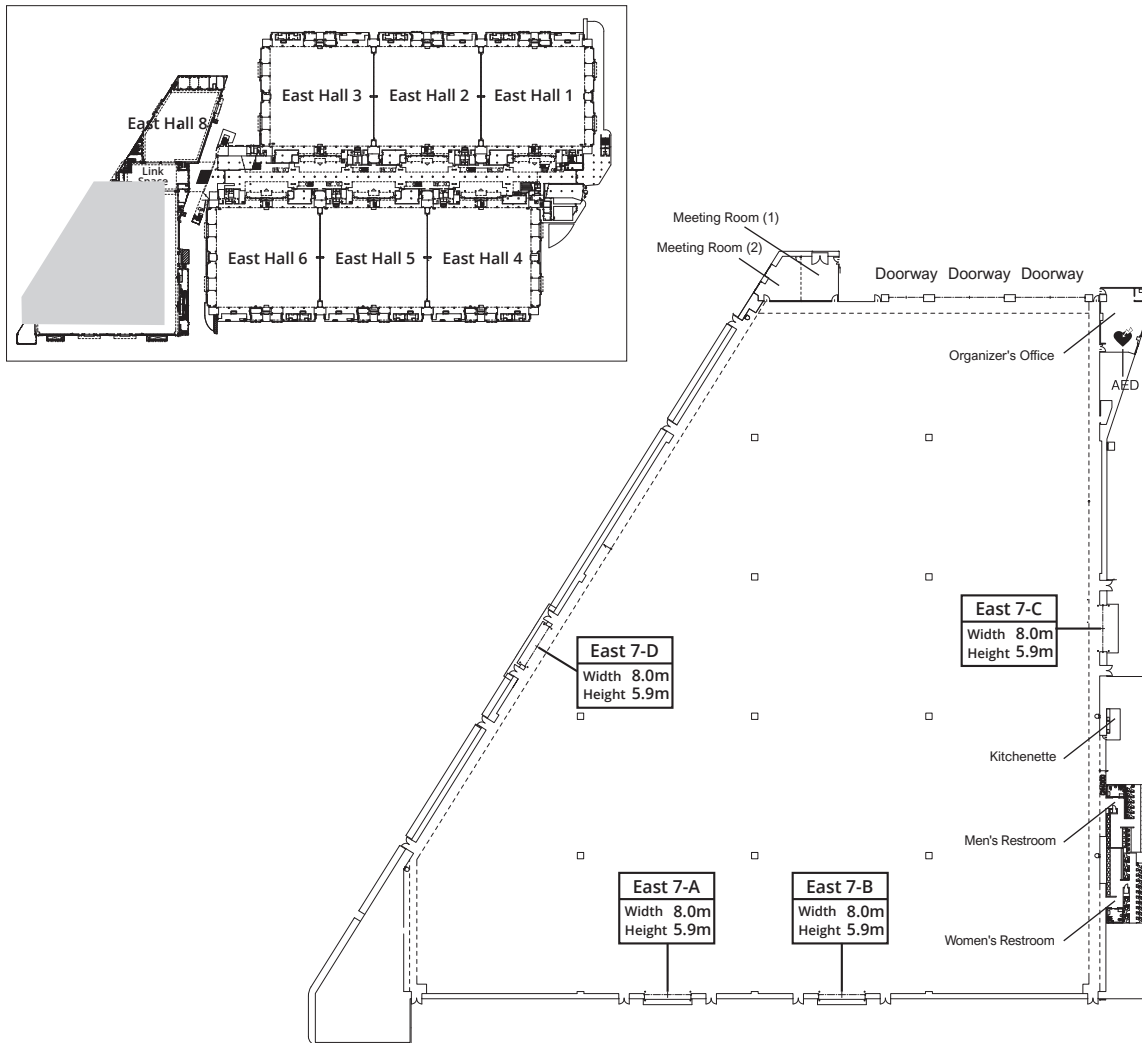

1. Building Facilities

◆Hall exhibition area	11,680 m ²
◆Ceiling height	12 to 13 m
◆Floor construction	Concrete
◆Floor load	5 t/m ²
◆Anchor bolt placement	Possible
◆Freight entrances	4 locations
◆No. of pits	10 main pits (electrical) 9 main pits (mechanical) 8 subsidiary pits

[Side rooms]

Organizer's Office	(84 m ²)
Meeting Room (1)	(55 m ²)
Meeting Room (2)	(54 m ²)

2. Electrical Facilities *Accessed from electrical service pits in the floor

◆Transformer substations	Substation(A), (B)
◆Transformer capacity	Lighting 2000kVA + 1300kVA Power 1500kVA + 1000kVA 500kVA + 500kVA
◆Hall ceiling lighting	LED lighting

3. Communication Facilities * Accessed from subsidiary electrical pits in the floor

◆TV broadcast outlets	47
◆Communication facility outlets	143
◆Communication lines	INS 64, high-speed broadband data links

4. Broadcast Facilities * Installed in the organizer's office

◆Input	1 microphone, 1 double cassette player, 1 CD player, 1 IC player, 1 SD/USB player 1 AUX (Note: A separate mixer amp is required when using as a microphone input)
◆Intercom	May receive from any hall or broadcast to East Hall 7, 8 and Link Space

5. Machinery

	Outlets inside the exhibition hall	Outlets outside the exhibition hall
Water supply valves	14 locations (2 lines east and west) Inside trench (25ø × 3 BV + 50ø × 1 BV) /location	None
Water pressure undecided	Main mechanical pit terminal (50ø × 1 BV) /location (Maximum flow rate 24m³/h)	
Drainage outlets	Each pipe drains into a main mechanical pit (Drainage pipe 150ø)	None
Compressed air valves and pipe diameter	6 locations (2 lines east and west) Inside trench (25ø × 3 BV + 50ø × 1 BV) /location	2 locations/2 line Water tank place (100ø × 1 F / location) (For attachment of compressors, etc.)
Coolant water valves and pipe diameter	None	None
Secondary fire hydrants and diameter	None	None

*BV: Ball Valve *BFV: Butterfly Valve *MPa: Megapascals (unit of pressure) *GV: Gate Valve *F: Flange Part

6. Sanitary Facilities

◆Hall Restrooms

	Men's Restrooms	Women's Restrooms
Toilet stalls (Western style)	6	18
Urinals	19	
Wash basins	11	10
Wheelchair accessible toilet	1 (★1)	1 (★1)
Baby bed	1	1

★...Number of ostomate support toilets included in a total

◆Kitchenette

Inside the hall	Inside the organizer's office
1	1

7. Ventilation Equipment

◆Air conditioners	8 per hall		
◆Air conditioning capabilities			
Cooling	11,952 MJ/h	Supplied air (SA)	73,500 m³/h
Outside air (OA)	18,000 m³/h	Heating	5,457 MJ/h
Recycled air (RA)	71,050 m³/h	Exhaust air (EA)	15,550 m³/h
Humidification	95 kg/h × 4, 42 kg/h × 4		

8. Fire Prevention Equipment

◆Indoor fire extinguishers	9 locations
◆Outdoor fire extinguishers	None
◆Fire detector scanning devices	4 locations
◆Water cannon system	5 locations (located 7.2 m above ground)
◆Sprinkler system	Sprinkler heads mounted on the ceiling of the main hall and other related rooms
◆Fire alarm system	• Automatic fire alarm system: Fire detectors mounted on the lower ceiling of the main hall and other related rooms
◆Smoke control system	• Main hall: Smoke windows installed in the upper areas of the hall • Organizer's offices: None
◆Fire extinguishers	28
◆AED (Automated External Defibrillator)	• Organizer's office

9. Other Facilities Inside the Hall

◆Drink vending machine corner	1 location
◆Garbage disposal	1 location (truck yard)

New East Exhibition Building East Hall 8

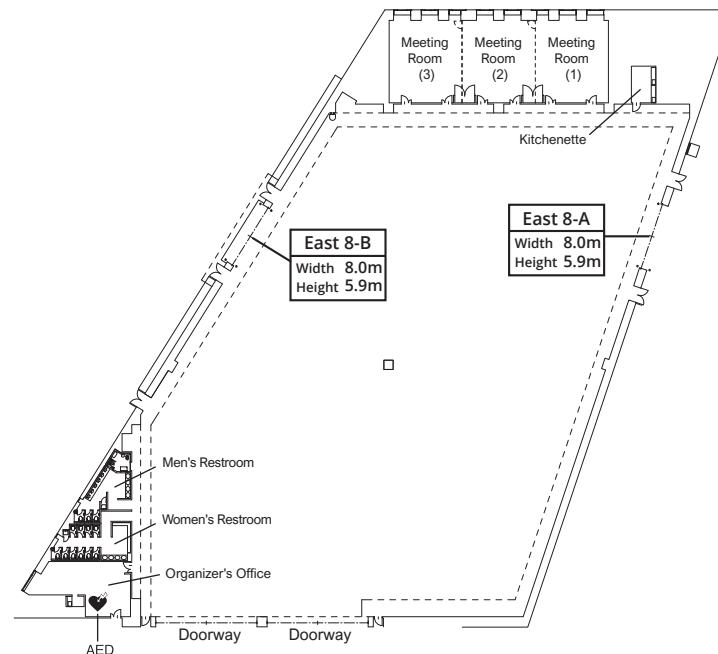
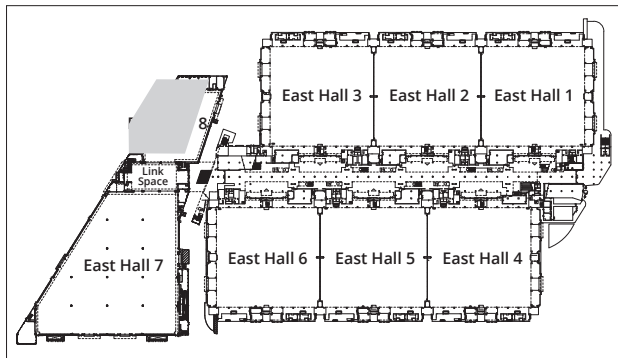

1. Building Facilities

◆Hall exhibition area	3,080 m ²
◆Ceiling height	10 to 12 m
◆Floor construction	Concrete
◆Floor load	5 t/m ²
◆Anchor bolt placement	Possible
◆Freight entrances	2 locations
◆No. of pits	4 main pits (electrical) 5 main pits (mechanical) 4 subsidiary pits

[Side rooms]

Organizer's Office	(65 m ²)
Meeting Room (1)	(94 m ²)
Meeting Room (2)	(94 m ²)
Meeting Room (3)	(94 m ²)

2. Electrical Facilities * Accessed from electrical service pits in the floor

◆Transformer substations	Substation (C)
◆Transformer capacity	Lighting 1300kVA (including Link Space) Power 200V 1000kVA (including Link Space) 200V 500kVA (including Link Space)
◆Hall ceiling lighting	LED lighting

3. Communication Facilities * Accessed from subsidiary electrical pits in the floor

◆TV broadcast outlets	12
◆Communication facility outlets	29
◆Communication lines	INS 64, high-speed broadband data links

4. Broadcast Facilities * Installed in the organizer's office

◆Input	1 microphone, 1 double cassette player, 1 CD player, 1 IC player, 1 SD/USB player 1 AUX (Note: A separate mixer amp is required when using as a microphone input)
◆Intercom	May receive from any hall or broadcast to East Hall 7, 8 and Link Space

5. Machinery

	Outlets inside the exhibition hall	Outlets outside the exhibition hall
Water supply valves	14 locations (1 lines east) Inside trench (25ø × 3 BV + 50ø × 1 BV) /location	None
Water pressure undecided	Main mechanical pit terminal (50ø × 1 BV) /location (Maximum flow rate 24m³/h)	
Drainage outlets	Each pipe drains into a main mechanical pit (Drainage pipe 150ø)	None
Compressed air valves and pipe diameter	6 locations (1 lines east) Inside trench (25ø × 3 BV + 50ø × 1 BV) /location	2 locations/2 line Water tank place (100ø × 1 F / location) (For attachment of compressors, etc.)
Coolant water valves and pipe diameter	None	None
Secondary fire hydrants and diameter	None	None

*BV: Ball Valve *BFV: Butterfly Valve *MPa: Megapascals (unit of pressure) *GV: Gate Valve *F: Flange Part

6. Sanitary Facilities

◆Hall Restrooms

	Men's Restrooms	Women's Restrooms
Toilet stalls (Western style)	3	10
Urinals	6	
Wash basins	4	4
Wheelchair accessible toilet	1* (★1)	1* (★1)
Baby bed	1*	1*

★...Number of ostomate support toilets included in a total

*unisex

◆Kitchenette

Inside the hall	Inside the organizer's office
1	1

7. Ventilation Equipment

◆Air conditioners	2 per hall		
◆Air conditioning capabilities			
Cooling	3,168 MJ/h	Supplied air (SA)	80,000 m³/h
Outside air (OA)	20,000 m³/h	Heating	792 MJ/h
Recycled air (RA)	73,800 m³/h	Exhaust air (EA)	13,800 m³/h
Humidification	69 kg/h		

8. Fire Prevention Equipment

◆Indoor fire extinguishers	5 locations
◆Outdoor fire extinguishers	None
◆Fire detector scanning devices	2 locations
◆Water cannon system	1 locations (located 5.0 m above ground)
◆Sprinkler system	Sprinkler heads mounted on the ceiling of the main hall and other related rooms
◆Fire alarm system	• Automatic fire alarm system: Fire detectors mounted on the lower ceiling of the main hall and other related rooms
◆Smoke control system	• Main hall: Smoke windows installed in the upper areas of the hall • Organizer's offices: None
◆Fire extinguishers	11
◆AED (Automated External Defibrillator)	• Organizer's office

9. Other Facilities Inside the Hall

◆Drink vending machine corner	1 location
◆Garbage disposal	1 location

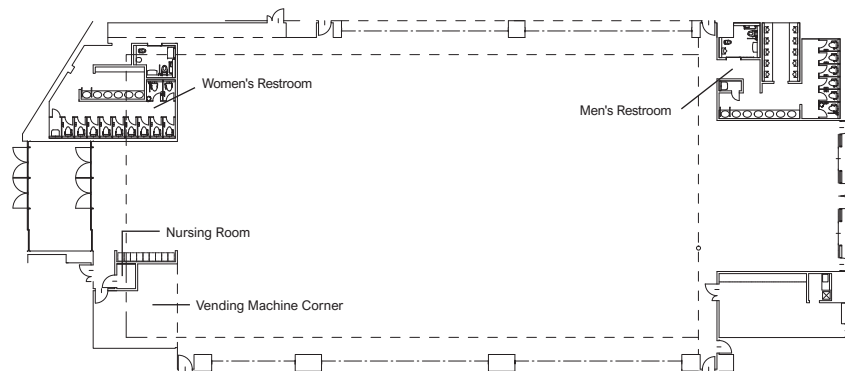
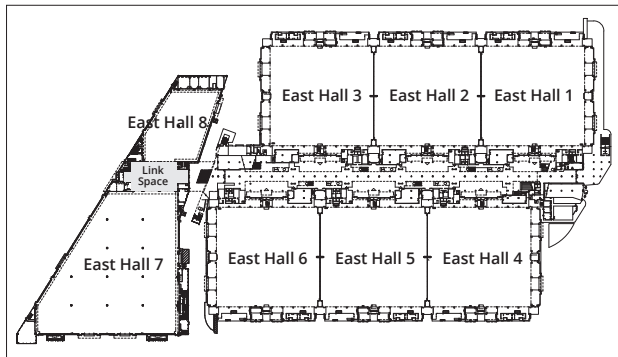

1. Building Facilities

◆Hall exhibition area	1,120 m ²
◆Ceiling height	10 to 12 m
◆Floor construction	Concrete
◆Floor load	5 t/m ²
◆Anchor bolt placement	Not allowed
◆Freight entrances	from East 7 or East 8
◆No. of pits	2 main pits (electrical) 2 main pits (mechanical) 3 subsidiary pits

2. Electrical Facilities *Accessed from electrical service pits in the floor

◆Transformer substations	None
◆Transformer capacity	—
◆Hall ceiling lighting	LED lighting

3. Communication Facilities * Accessed from subsidiary electrical pits in the floor

◆TV broadcast outlets	4
◆Communication facility outlets	7
◆Communication lines	INS 64, high-speed broadband data links

4. Broadcast Facilities

None

5. Machinery

	Outlets inside the exhibition hall
Water supply valves	1 locations (1 lines east) Inside trench (25ø × 3 BV + 50ø × 1 BV) /location
Water pressure undecided	Main mechanical pit terminal (50ø × 1 BV) /location (Maximum flow rate 9m ³ /h) *Link Space is supplied by East Hall 7 water supply system
Drainage outlets	Each pipe drains into a main mechanical pit (Drainage pipe 150ø)
Compressed air valves and pipe diameter	1 locations (1 lines east) Inside trench (25ø × 3 BV + 50ø × 1 BV) /location *Link Space is supplied by East Hall 7 air compressor system
Coolant water valves and pipe diameter	None
Secondary fire hydrants and diameter	None

*BV: Ball Valve *BFV: Butterfly Valve *MPa: Megapascals (unit of pressure) *GV: Gate Valve

6. Sanitary Facilities

♦Hall Restrooms

	Men's Restrooms	Women's Restrooms
Toilet stalls (Western style)	6	11
Urinals	10	
Wash basins	7	6
Wheelchair accessible toilet	1 (★1)	1 (★1)
Baby bed	1	1

★...Number of ostomate support toilets included in a total

♦Kitchenette None

7. Ventilation Equipment

♦Air conditioners	1 per hall		
♦Air conditioning capabilities			
Cooling	1,285 MJ/h	Supplied air (SA)	56,000 m ³ /h
Outside air (OA)	18,000 m ³ /h	Heating	576 MJ/h
Recycled air (RA)	51,300 m ³ /h	Exhaust air (EA)	13,300 m ³ /h
Humidification	56 kg/h		

8. Fire Prevention Equipment

♦Indoor fire extinguishers	None
♦Outdoor fire extinguishers	None
♦Fire detector scanning devices	2 locations
♦Water cannon system	1 locations (located 5.0 m above ground)
♦Sprinkler system	Sprinkler heads mounted on the ceiling of the related rooms
♦Fire alarm system	• Automatic fire alarm system: Fire detectors mounted on the lower ceiling of the main hall and other related rooms
♦Smoke control system	• Main hall: Smoke windows installed in the upper areas of the hall • Organizer's offices: None
♦Fire extinguishers	4

9. Other Facilities Inside the Hall

♦Drink vending machine corner 1 location

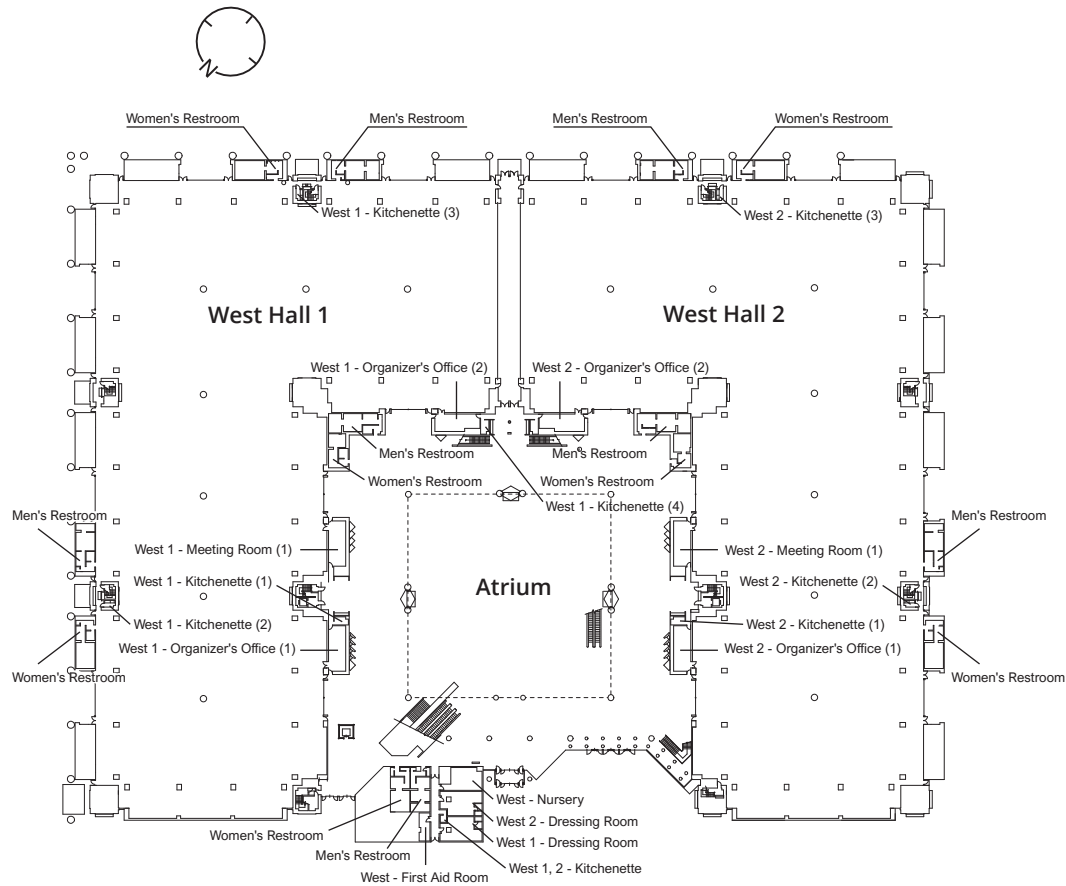

Second Floor Plan

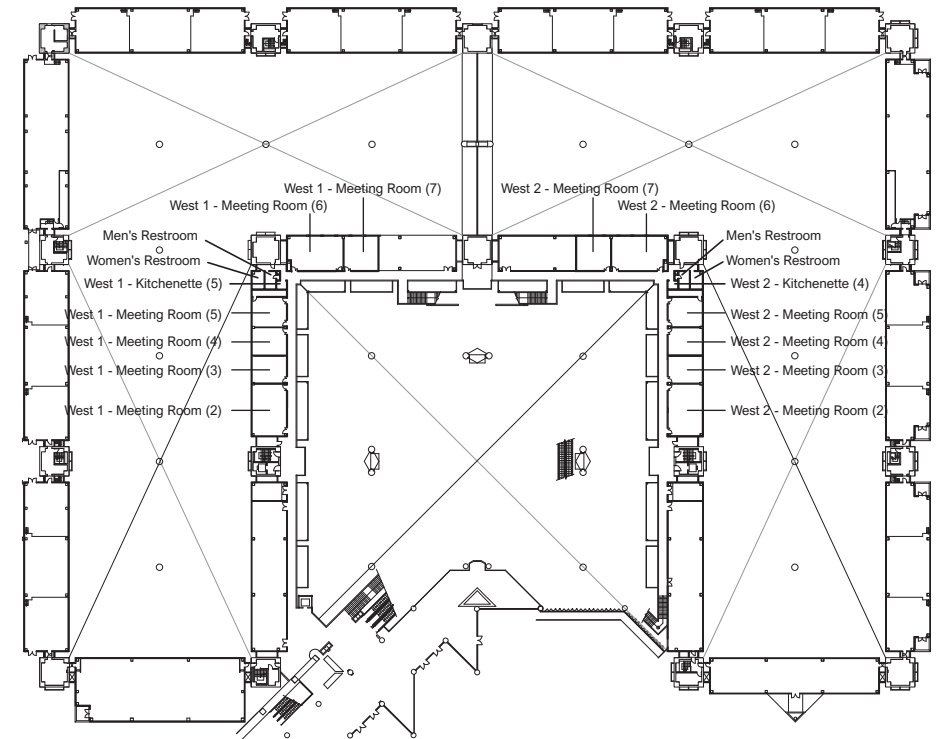

Fourth Floor Plan

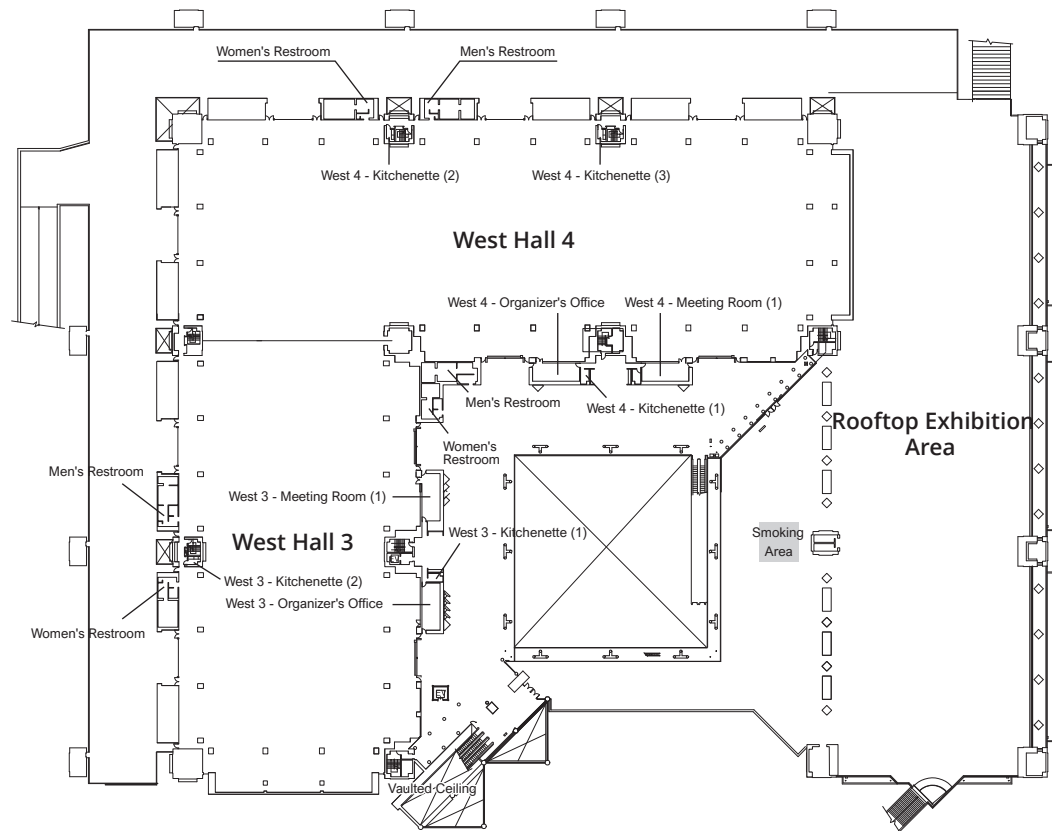

Fifth Floor Plan

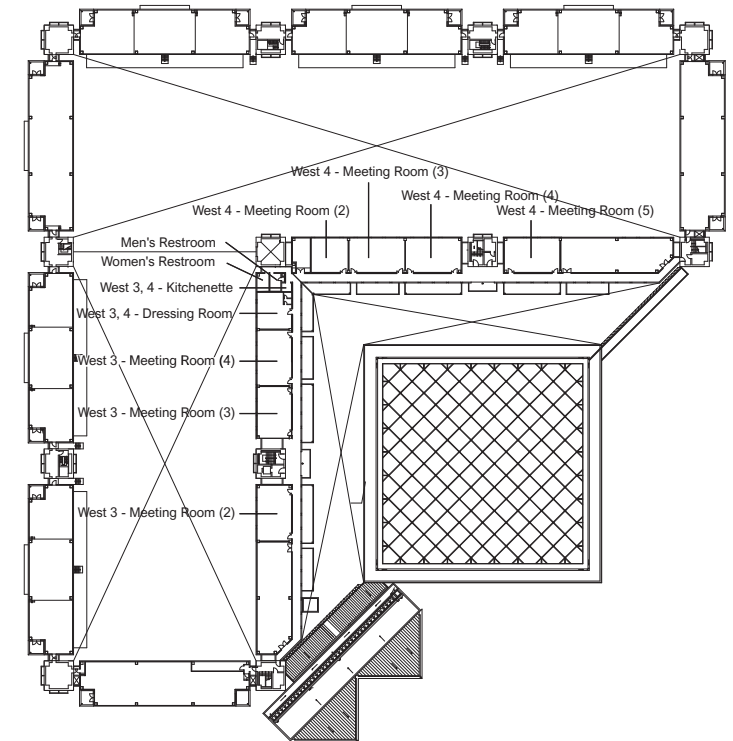

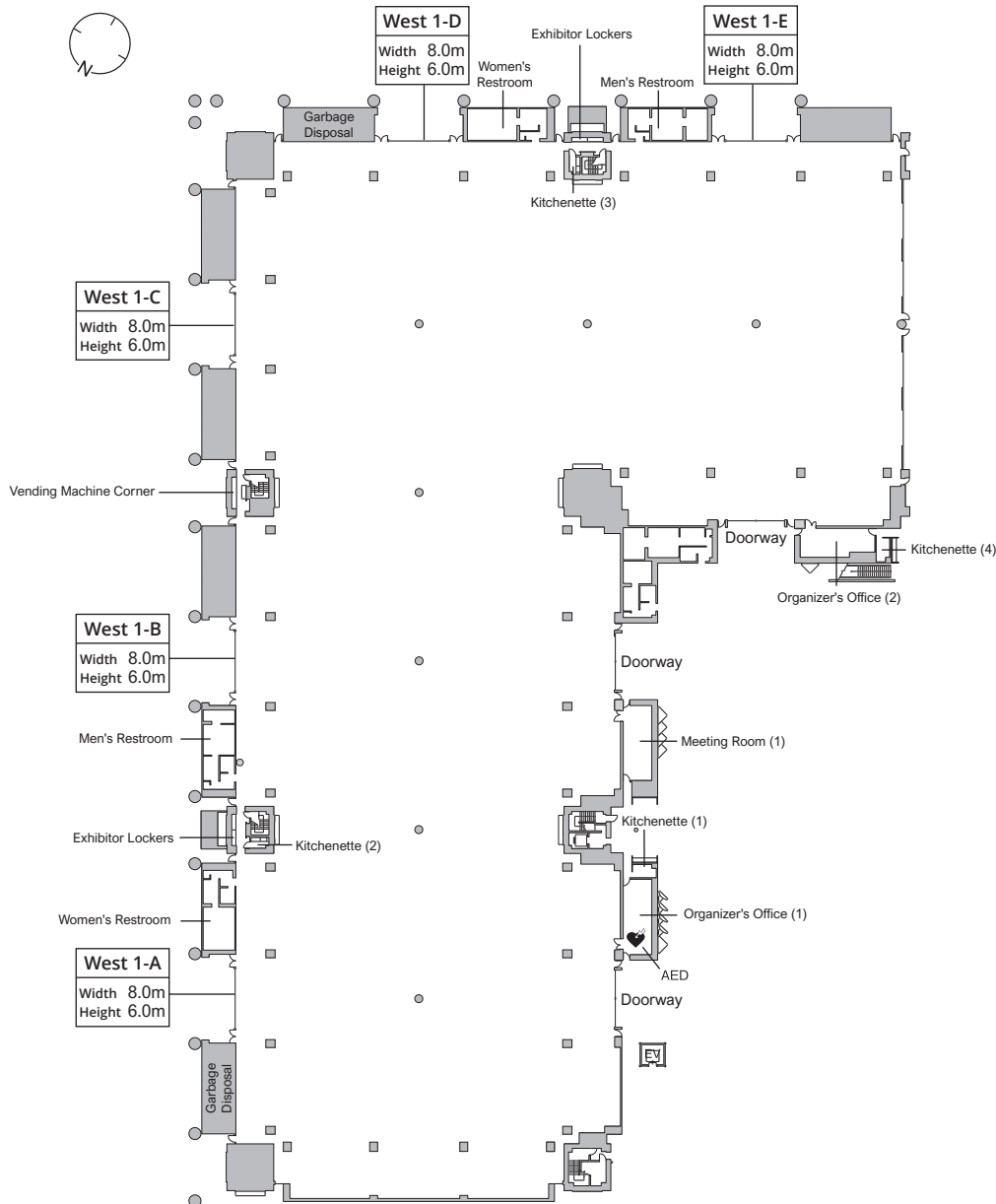
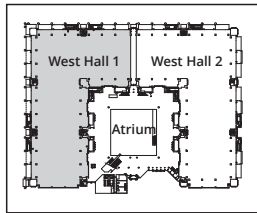

1. Building Facilities

◆Hall exhibition area	8,880 m ²
◆Ceiling height	12 m
◆Floor construction	Concrete
◆Floor load	5 t/m ²
◆Anchor bolt placement	Possible (Max depth 60 mm, Max size 16 ø)
◆Freight entrances	5 locations
◆No. of pits	33 main pits 4 subsidiary pits

[Side rooms]

1F Organizer's Office (1) (38 m ²)	Organizer's Office (2) (36 m ²)
Meeting Room (1) (40 m ²)	Dressing Room (41 m ²)
2F Meeting Room (2) (81 m ²)	Meeting Room (3) (43 m ²)
Meeting Room (4) (43 m ²)	Meeting Room (5) (45 m ²)
Meeting Room (6) (85 m ²)	Meeting Room (7) (53 m ²)

Total Rooms: 10

*Note Side room areas are calculated based on the internal dimensions.

2. Electrical Facilities *Accessed from electrical service pits in the floor

◆Transformer substations	S6, S7
◆Transformer capacity	Power 500kVA × 4 Lighting 300kVA × 6 200kVA × 2
◆Hall ceiling lighting	HID lighting

3. Communication Facilities * Accessed from subsidiary electrical pits in the floor

◆TV broadcast outlets	68
◆Communication facility outlets	102
◆Communication lines	Analog lines INS 64, high-speed broadband data links

4. Broadcast Facilities * Installed in each organizer's office

◆Input	1 microphone, 1 cassette player, 1 CD player with MD, 1 CD rack 1 AUX (Note: A separate mixer amp is required when using as a microphone input)
◆Intercom	May broadcast to or receive from any hall

5. Machinery

	Outlets inside the exhibition hall	Outlets outside the exhibition hall
Water supply valves Water pressure 3~5Kg/cm ² (0.25~0.49 MPa) (Maximum flow rate 54m ³ /h)	15 locations (2 lines) 1 meter/1 line (1) Main mechanical pit terminal (50ø × 1 BV/location) (2) Header inside mechanical trench (50ø × 1 BV/location) (80ø main pipe) (25ø × 3 BV/location)	2 locations (meter must be attached) Truck yard side, wall-mounted (50ø × 1 BV/location)
Drainage outlets	Each pipe drains into a main mechanical pit	Discharges into a 600 □ outside drainage container (150ø drainage pipe)
Compressed air valves and pipe diameter	15 locations/1 line (100ø main pipe) Header inside mechanical trench (50ø × 1 BV/location) (25ø × 3 BV/location)	2 lines (1 location/line) Truck yard side, wall-mounted (100ø × 1 BFV/location) (For attachment of compressors, etc.)
Coolant water valves and pipe diameter	12 locations/1 line (100ø main pipe) Header inside mechanical trench (50ø × 1 BF/location) (25ø × 3 BV/location)	2 lines (1 location/line) Truck yard side, wall-mounted (150ø × 1 BFV/location) (For attachment of cooling tower, etc.)
Secondary fire hydrants and diameter	8 locations Inside subsidiary mechanical pits (25ø × 1 fire hose socket/location) (50ø × 1 GV/location)	None

*BV: Ball Valve *BFV: Butterfly Valve *MPa: Megapascals (unit of pressure) *GV: Gate Valve

6. Sanitary Facilities

◆Hall Restrooms

	Men's Restrooms (2 locations)			Women's Restrooms (2 locations)		
	Shutter AB side	Shutter DE side	Total	Shutter AB side	Shutter DE side	Total
Toilet stalls (Western style)	2	3 (★1)	5	8 (★1)	9 (★1)	17
Toilet stalls (Japanese style)	1	1	2	1	1	2
Urinals	10	11	21	1	1	2
Wash basins	4	5	9	4	9	13
Wheelchair accessible toilet	1	0	1	1	0	1
Baby bed	0	1	1	1	1	2

*★...Number of ostomate support
toilets included in a total

◆Kitchenette

Inside the hall	Next to the organizer's office	Next to the dressing room (shared with West Hall 2)	Rooms on the second floor	Total
2	2	1	1	6

7. Ventilation Equipment

◆Air conditioners	8 per hall		
◆Air conditioning capabilities			
Cooling	7,434 MJ/h	Supplied air (SA)	400,000 m ³ /h
Outside air (OA)	116,000 m ³ /h	Heating	4,533 MJ/h
Recycled air (RA)	400,000 m ³ /h	Exhaust air (EA)	116,000 m ³ /h
Humidification	520 kg/h		

8. Fire Prevention Equipment

◆Indoor fire extinguishers	8 locations
◆Outdoor fire extinguishers	5 locations
◆Sprinkler system	Sprinkler heads mounted on the ceiling of the main hall and other related rooms
◆Fire alarm system	• Automatic fire alarm system: Fire detectors mounted on the lower ceiling of the main hall and other related rooms • Fire alarm system: Mounted on the walls of the main hall (manually operated with a push button)
◆Smoke control system	• Main hall: Smoke windows installed in the upper areas of the hall • Organizer's offices: Smoke control openings installed (forced smoke control by fans)
◆Fire extinguishers	9 dry chemical extinguishers, 9 fortified liquid extinguishers
◆AED (Automated External Defibrillator)	• Organizer's office

9. Other Facilities Inside the Hall

◆Drink vending machine corner	1 location
◆Garbage disposal	2 locations
◆Exhibitor lockers	2 locations

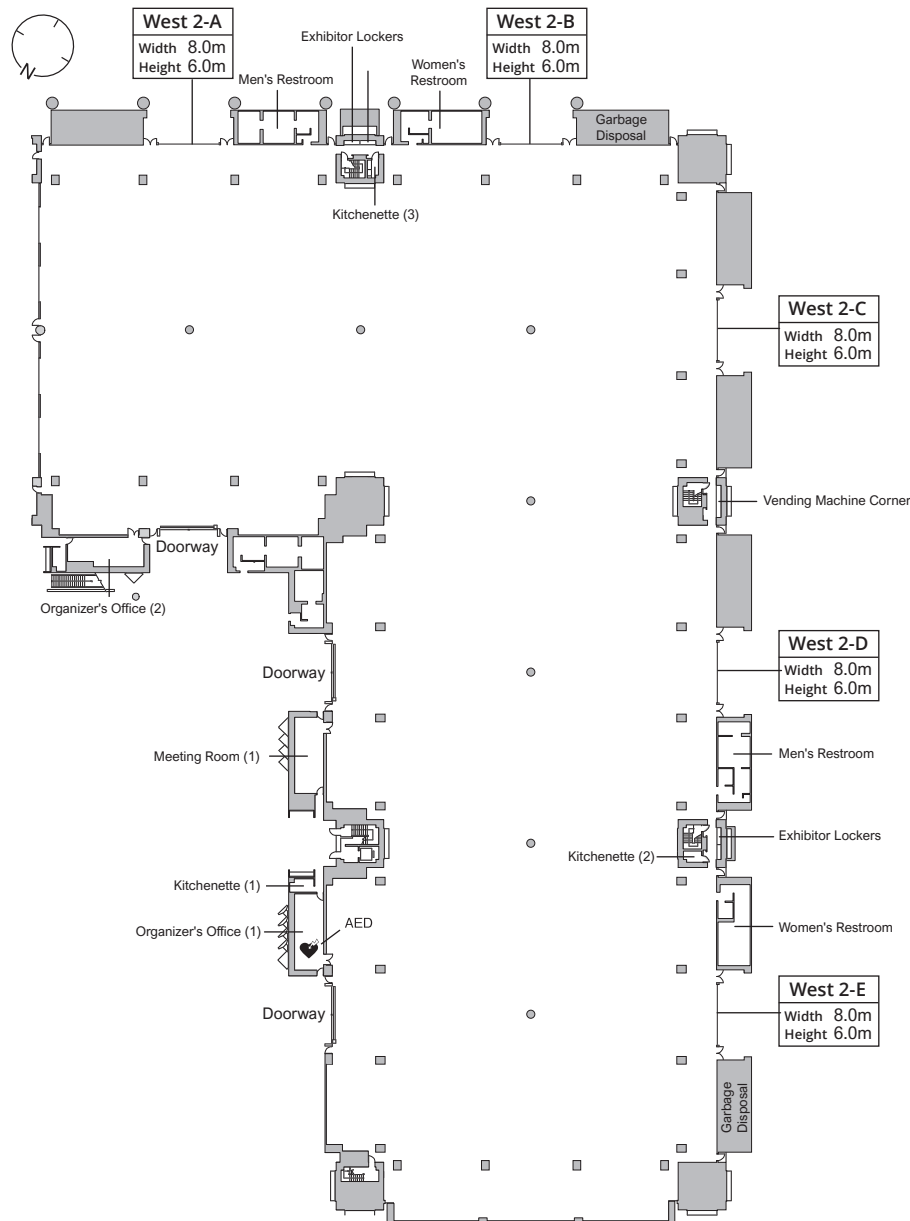
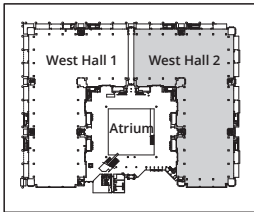

1. Building Facilities

- ◆Hall exhibition area 8,880 m²
- ◆Ceiling height 12 m
- ◆Floor construction Concrete
- ◆Floor load 5 t/m²
- ◆Anchor bolt placement Possible (Max depth 60 mm, Max size 16 ø)
- ◆Freight entrances 5 locations
- ◆No. of pits 33 main pits
4 subsidiary pits

[Side rooms]

- 1F Organizer's Office (1) (38 m²) Organizer's Office (2) (36 m²)
- Meeting Room (1) (40 m²) Dressing Room (41 m²)
- 2F Meeting Room (2) (81 m²) Meeting Room (3) (43 m²)
- Meeting Room (4) (43 m²) Meeting Room (5) (45 m²)
- Meeting Room (6) (85 m²) Meeting Room (7) (53 m²)

Total Rooms: 10

[*Note] Side room areas are calculated based on the internal dimensions.

2. Electrical Facilities *Accessed from electrical service pits in the floor

- ◆Transformer substations S4, S5
- ◆Transformer capacity Power 500kVA × 4
Lighting 300kVA × 6
200kVA × 2

- ◆Hall ceiling lighting HID lighting

3. Communication Facilities * Accessed from subsidiary electrical pits in the floor

- ◆TV broadcast outlets 68
- ◆Communication facility outlets 102
- ◆Communication lines Analog lines
INS 64, high-speed
broadband data links

4. Broadcast Facilities * Installed in each organizer's office

- ◆Input 1 microphone, 1 cassette player,
1 CD player with MD, 1 CD rack
1 AUX
(Note: A separate mixer amp is
required when using as a
microphone input)
- ◆Intercom May broadcast to or receive
from any hall

5. Machinery

	Outlets inside the exhibition hall	Outlets outside the exhibition hall
Water supply valves Water pressure 3~5Kg/cm ² (0.25~0.49 MPa) (Maximum flow rate 54m ³ /h)	15 locations (2 lines) 1 meter/1 line (1) Main mechanical pit terminal (50ø × 1 BV/location) (2) Header inside mechanical trench (50ø × 1 BV/location) (80ø main pipe) (25ø × 3 BV/location)	2 locations (meter must be attached) Truck yard side, wall-mounted (50ø × 1 BV/location)
Drainage outlets	Each pipe drains into a main mechanical pit	Discharges into a 600 □ outside drainage container (150ø drainage pipe)
Compressed air valves and pipe diameter	15 locations/1 line (100ø main pipe) Header inside mechanical trench (50ø × 1 BV/location) (25ø × 3 BV/location)	2 lines (1 location/line) Truck yard side, wall-mounted (100ø × 1 BFV/location) (For attachment of compressors, etc.)
Coolant water valves and pipe diameter	12 locations/1 line (100ø main pipe) Header inside mechanical trench (50ø × 1 BF/location) (25ø × 3 BV/location)	2 lines (1 location/line) Truck yard side, wall-mounted (150ø × 1 BFV/location) (For attachment of cooling tower, etc.)
Secondary fire hydrants and diameter	8 locations Inside subsidiary mechanical pits (25ø × 1 fire hose socket/location) (50ø × 1 GV/location)	None

*BV: Ball Valve *BFV: Butterfly Valve *MPa: Megapascals (unit of pressure) *GV: Gate Valve

6. Sanitary Facilities

◆Hall Restrooms

	Men's Restrooms (2 locations)			Women's Restrooms (2 locations)		
	Shutter AB side	Shutter DE side	Total	Shutter AB side	Shutter DE side	Total
Toilet stalls (Western style)	3 (★1)	2	5	9 (★1)	8 (★1)	17
Toilet stalls (Japanese style)	1	1	2	1	1	2
Urinals	11	10	21	1	1	2
Wash basins	5	4	9	9	4	13
Wheelchair accessible toilet	0	1	1	0	1	1
Baby bed	1	0	1	1	1	2

* ★...Number of ostomate support
toilets included in a total

◆Kitchenette

Inside the hall	Next to the organizer's office	Next to the dressing room (shared with West Hall 1)	Rooms on the second floor	Total
2	1	1	1	5

7. Ventilation Equipment

◆Air conditioners	8 per hall			
◆Air conditioning capabilities				
Cooling	7,434 MJ/h	Supplied air (SA)	400,000 m³/h	
Outside air (OA)	116,000 m³/h	Heating	4,533 MJ/h	
Recycled air (RA)	400,000 m³/h	Exhaust air (EA)	116,000 m³/h	
Humidification	520 kg/h			

8. Fire Prevention Equipment

◆Indoor fire extinguishers	8 locations
◆Outdoor fire extinguishers	5 locations
◆Sprinkler system	Sprinkler heads mounted on the ceiling of the main hall and other related rooms
◆Fire alarm system	• Automatic fire alarm system: Fire detectors mounted on the lower ceiling of the main hall and other related rooms • Fire alarm system: Mounted on the walls of the main hall (manually operated with a push button)
◆Smoke control system	• Main hall: Smoke windows installed in the upper areas of the hall • Organizer's offices: Smoke control openings installed (forced smoke control by fans)
◆Fire extinguishers	9 dry chemical extinguishers, 9 fortified liquid extinguishers
◆AED (Automated External Defibrillator)	• Organizer's office (1)

9. Other Facilities Inside the Hall

◆Drink vending machine corner	1 location
◆Garbage disposal	2 locations
◆Exhibitor lockers	2 locations

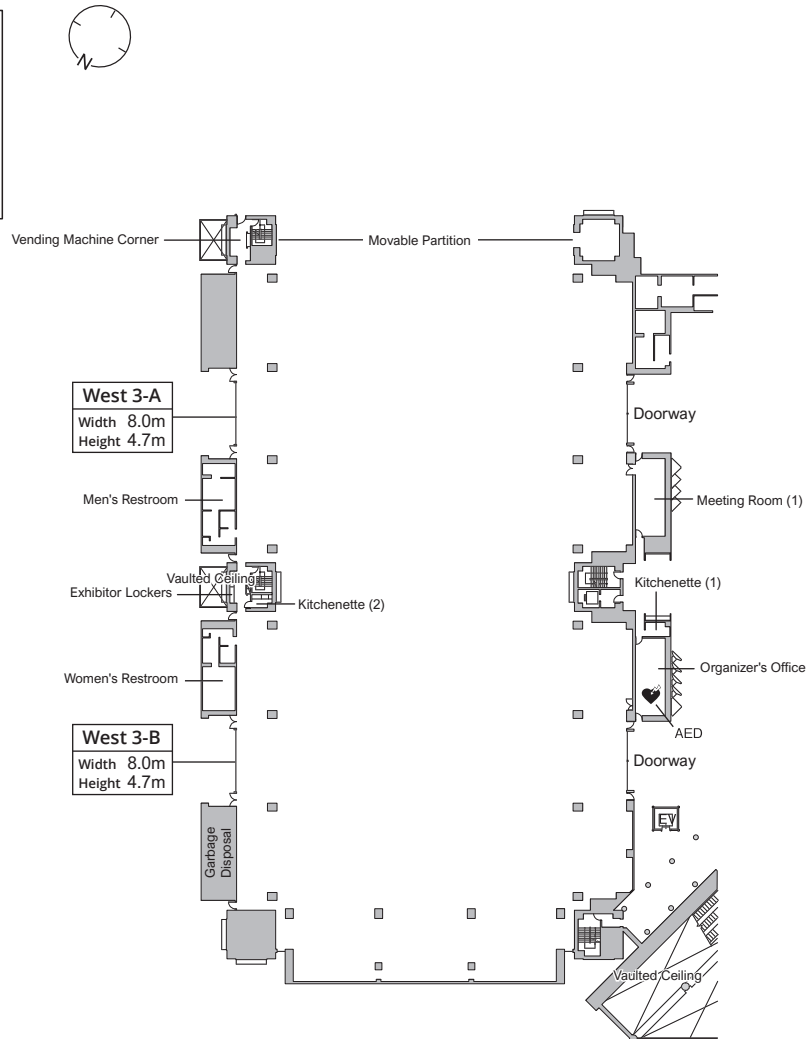
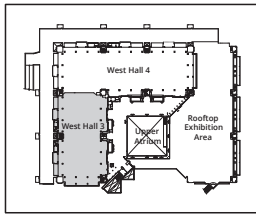

1. Building Facilities

◆Hall exhibition area	4,680 m ²
◆Ceiling height	13 to 18 m
◆Floor construction	Concrete
◆Floor load	2 t/m ²
◆Anchor bolt placement	Possible (Max depth 60 mm, Max size 16 ø)
◆Freight entrances	2 locations
◆No. of pits	9 main pits 2 subsidiary pits

[Side rooms]

4F Organizer's Office (38 m ²)	Meeting Room (1) (40 m ²)
5F Meeting Room (2) (88 m ²)	Meeting Room (3) (81 m ²)
Meeting Room (4) (89 m ²)	
Dressing Room (48 m ²) (shared with West Hall 4)	

Total Rooms: 6

*Note Side room areas are calculated based on the internal dimensions.

*Note Due to the floor surface being made of epoxy, we ask that you use a weak adhesive tape when adhesive tape is required to fix carpeting in place.

2. Electrical Facilities *Accessed from electrical service pits in the floor

◆Transformer substations	S10
◆Transformer capacity	Power 500kVA × 2 Lighting 300kVA × 3
◆Hall ceiling lighting	HID lighting

3. Communication Facilities * Accessed from subsidiary electrical pits in the floor

◆TV broadcast outlets	36
◆Communication facility outlets	70
◆Communication lines	Analog lines INS 64, high-speed broadband data links

4. Broadcast Facilities * Installed in organizer's offices

◆Input	1 microphone, 1 cassette player, 1 CD player with MD, 1 CD rack 1 AUX (Note: A separate mixer amp is required when using as a microphone input)
◆Intercom	May broadcast to or receive from any hall

5. Machinery

	Outlets inside the exhibition hall	Outlets outside the exhibition hall
Water supply valves Water pressure 2~4Kg/cm ² (0.19~0.39 MPa) (Maximum flow rate 54m ³ /h)	8 locations 1 meter/1 line Water supply and drainage junction box in the corner of the hall (25ø × 1 BV/location)	None
Drainage outlets and diameter	8 locations 1 meter/1 line Water supply and drainage junction box in the corner of the hall (80ø × 1 BV/location)	None
Compressed air valves and pipe diameter	None	None
Coolant water valves and pipe diameter	None	None
Secondary fire hydrants and diameter	None	None

6. Sanitary Facilities

♦Hall Restrooms

	Men's Restrooms (1 location)	Women's Restrooms (1 location)
	Truck yard side	Truck yard side
Toilet stalls (Western style)	2	8 (★1)
Toilet stalls (Japanese style)	1	1
Urinals	10	1
Wash basins	4	4
Wheelchair accessible toilet	1	1
Baby bed	0	1

* ★...Number of ostomate support toilets included in a total

♦Kitchenette

Inside the hall	Next to the organizer's office	Rooms on the fifth floor (shared with West Hall 4)	Total
1	1	1	3

7. Ventilation Equipment

♦Air conditioners	4 per hall
♦Air conditioning capabilities	
Cooling	3,817 MJ/h
Outside air (OA)	58,000 m ³ /h
Recycled air (RA)	200,000 m ³ /h
Humidification	260 kg/h
Supplied air (SA)	200,000 m ³ /h
Heating	1,975 MJ/h
Exhaust air (EA)	58,000 m ³ /h

8. Fire Prevention Equipment

♦Indoor fire extinguishers	2 locations
♦Sprinkler system	Sprinkler heads mounted on the ceiling of the main hall and other related rooms
♦Fire alarm system	<ul style="list-style-type: none"> • Automatic fire alarm system: Fire detectors mounted on the lower ceiling of the main hall and other related rooms • Fire alarm system: Mounted on the walls of the main hall (manually operated with a push button)
♦Smoke control system	<ul style="list-style-type: none"> • Main hall: Smoke windows installed in the upper areas of the hall • Organizer's offices: Smoke control openings installed (forced smoke control by fans)
♦Fire extinguishers	4 dry chemical extinguishers, 6 fortified liquid extinguishers
♦AED (Automated External Defibrillator)	• Organizer's office

9. Other Facilities Inside the Hall

♦Drink vending machine corner	1 location
♦Garbage disposal	1 location
♦Exhibitor lockers	1 location

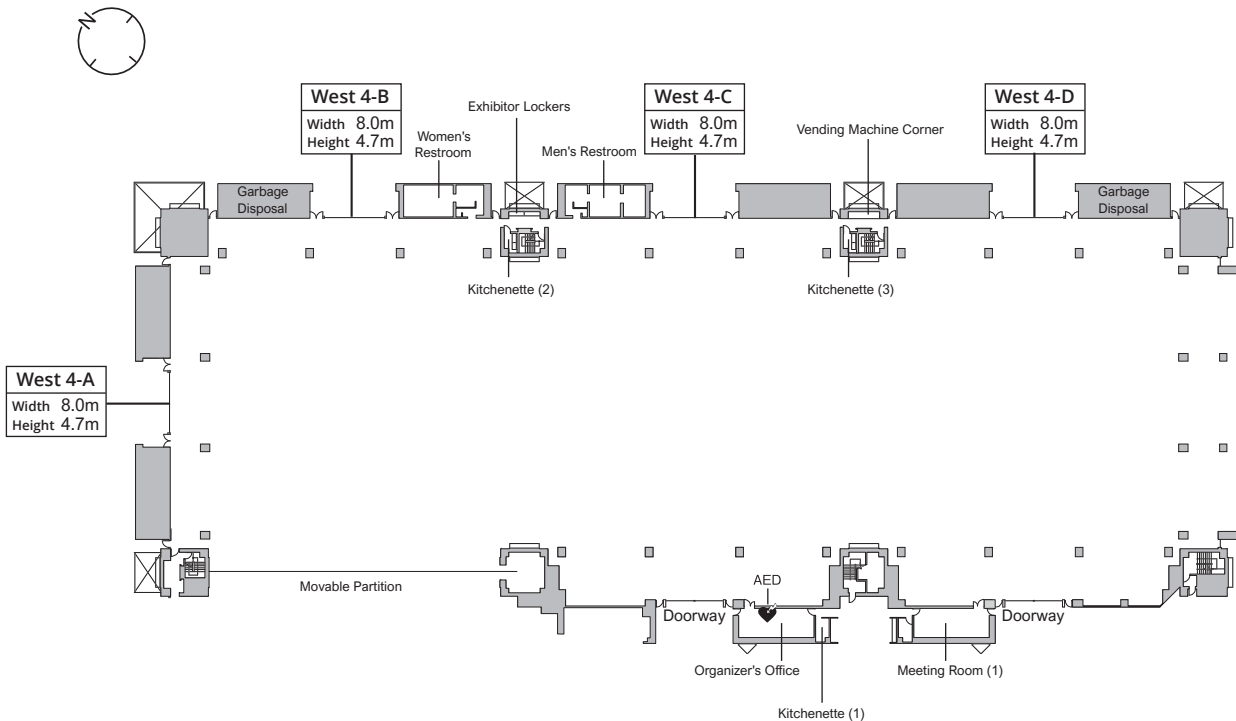
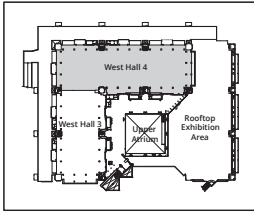

1. Building Facilities

♦Hall exhibition area	6,840 m ²
♦Ceiling height	13 to 18 m
♦Floor construction	Concrete
♦Floor load	2 t/m ²
♦Anchor bolt placement	Possible (Max depth 60 mm, Max size 16 ø)
♦Freight entrances	4 locations
♦No. of pits	13 main pits 2 subsidiary pits

[Side rooms]

4F Organizer's Office (37 m ²)	Meeting Room (1) (40 m ²)
5F Meeting Room (2) (58 m ²)	Meeting Room (3) (87 m ²)
Meeting Room (4) (85 m ²)	Meeting Room (5) (88 m ²)
Dressing Room (48 m ²) (shared with West Hall 3)	

Total Rooms: 7

*Note Side room areas are calculated based on the internal dimensions.

*Note Due to the floor surface being made of epoxy, we ask that you use a weak adhesive tape when adhesive tape is required to fix carpeting in place.

2. Electrical Facilities *Accessed from electrical service pits in the floor

♦Transformer substations	S8, S9
♦Transformer capacity	Power 500kVA × 4 Lighting 300kVA × 6 150kVA × 1
♦Hall ceiling lighting	HID lighting

3. Communication Facilities * Accessed from subsidiary electrical pits in the floor

♦TV broadcast outlets	68
♦Communication facility outlets	102
♦Communication lines	Analog lines INS 64, high-speed broadband data links

4. Broadcast Facilities * Installed in organizer's offices

♦Input	1 microphone, 1 cassette player, 1 CD player with MD, 1 CD rack 1 AUX (Note: A separate mixer amp is required when using as a microphone input)
♦Intercom	May broadcast to or receive from any hall

5. Machinery

	Outlets inside the exhibition hall	Outlets outside the exhibition hall
Water supply valves Water pressure 2~4Kg/cm ² (0.19~0.39 MPa) (Maximum flow rate 54m ³ /h)	11 locations 1 meter/1 line Water supply and drainage junction box in the corner of the hall (25ø × 1 BV/location)	None
Drainage outlets and diameter	11 locations 1 meter/1 line Water supply and drainage junction box in the corner of the hall (80ø × 1 BV/location)	None
Compressed air valves and pipe diameter	None	None
Coolant water valves and pipe diameter	None	None
Secondary fire hydrants and diameter	None	None

6. Sanitary Facilities

◆Hall Restrooms

	Men's Restrooms (1 location)	Women's Restrooms (1 location)
	Truck yard side	Truck yard side
Toilet stalls (Western style)	3 (★1)	9 (★1)
Toilet stalls (Japanese style)	1	1
Urinals	10	1
Wash basins	5	9
Wheelchair accessible toilet	0	0
Baby bed	1	1

* ★...Number of ostomate support toilets included in a total

◆Kitchenette

Inside the hall	Next to the organizer's office	Rooms on the fifth floor (shared with West Hall 3)	Total
2	1	1	4

7. Ventilation Equipment

◆Air conditioners	4 per hall		
◆Air conditioning capabilities			
Cooling	5,726 MJ/h	Supplied air (SA)	300,000 m ³ /h
Outside air (OA)	87,000 m ³ /h	Heating	2,966 MJ/h
Recycled air (RA)	300,000 m ³ /h	Exhaust air (EA)	87,000 m ³ /h
Humidification	390 kg/h		

8. Fire Prevention Equipment

◆Indoor fire extinguishers	2 locations
◆Sprinkler system	Sprinkler heads mounted on the ceiling of the main hall and other related rooms
◆Fire alarm system	<ul style="list-style-type: none"> Automatic fire alarm system: Fire detectors mounted on the lower ceiling of the main hall and other related rooms Fire alarm system: Mounted on the walls of the main hall (manually operated with a push button)
◆Smoke control system	<ul style="list-style-type: none"> Main hall: Smoke windows installed in the upper areas of the hall Organizer's offices: Smoke control openings installed (forced smoke control by fans)
◆Fire extinguishers	7 dry chemical extinguishers, 6 fortified liquid extinguishers
◆AED (Automated External Defibrillator)	Organizer's office

9. Other Facilities Inside the Hall

◆Drink vending machine corner	1 location
◆Garbage disposal	2 locations
◆Exhibitor lockers	1 location

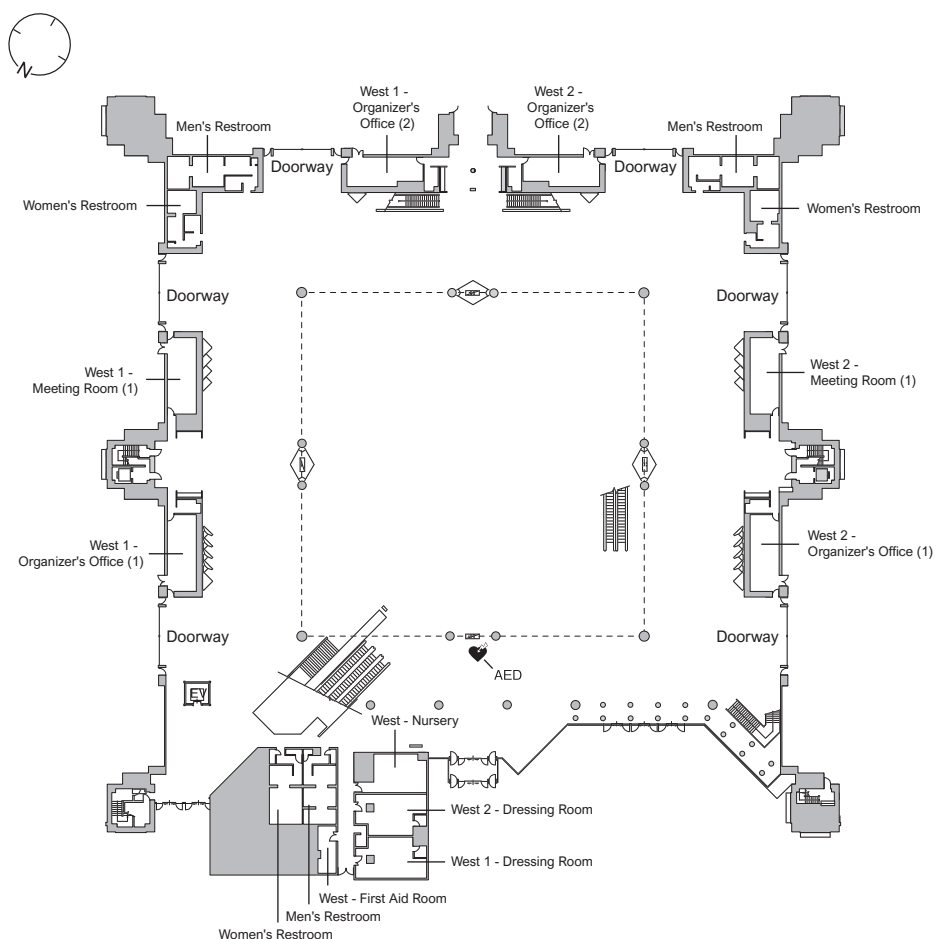
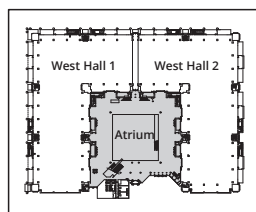

1. Building Facilities

◆Exhibition area	2,000 m ²
◆Ceiling height	23 m
◆Floor construction	Artificial tiling
◆Floor load	0.36 t/m ²
◆Anchor bolt placement	Not allowed (hooks available)

2. Electrical Facilities *Accessed from electrical service pits in the floor

◆Transformer substations	S24
◆Transformer capacity	Power 500kVA × 1 Lighting 300kVA × 2
◆Ceiling lighting	HID lighting

3. Communication Facilities * Accessed from subsidiary electrical pits in the floor

◆TV broadcast outlets	1
◆Communication facility outlets	1
◆Communication lines	Analog lines INS 64, high-speed broadband data links

4. Broadcast Facilities * Please consult with us before using.

◆Input	Can be controlled by installing a multi-purpose remote control
◆Intercom	May receive from any hall

5. Machinery

	Outlets inside the exhibition hall	Outlets outside the exhibition hall
Water supply valves Water pressure	None	None
Drainage outlets	None	None
Compressed air valves and pipe diameter	None	None
Coolant water valves and pipe diameter	None	None
Secondary fire hydrants and diameter	None	None

6. Sanitary Facilities

♦Atrium Restrooms

	Men's Restrooms (3 locations)				Women's Restrooms (3 locations)			
	West 1 side	West 2 side	Side of service entrance	Total	West 1 side	West 2 side	Side of service entrance	Total
Toilet stalls (Western style)	5 (-2)	5 (-3)	3	13	4 (+2)	5 (+3)	6 (★1)	15
Toilet stalls (Japanese style)	1	1	1	3	1	1	1	3
Urinals	9	10	6	25	1	1	1	3
Wash basins	4	8	3	15	4	7	4	15
Wheelchair accessible toilet	1	0	0	1	1	0	0	1
Baby bed	1	1	1	3	1	1	1	3

* West 1 side and 2 side toilets can be changed using the movable partition

* ★...Number of ostomate support toilets included in a total

7. Ventilation Equipment

♦Air conditioners	10 per hall		
♦Air conditioning capabilities			
Cooling	4,102 MJ/h	Supplied air (SA)	240,000 m³/h
Outside air (OA)	74,000 m³/h	Heating	2,750 MJ/h
Recycled air (RA)	223,000 m³/h	Exhaust air (EA)	74,000 m³/h
Humidification	350 kg/h		

8. Fire Prevention Equipment

♦Indoor fire extinguishers	6 locations
♦Sprinkler system	Sprinkler heads mounted on the ceiling
♦Fire alarm system	• Automatic fire alarm system: Discrete photoelectric sensors mounted on ceiling catwalk
	• Fire alarm system: Mounted on the walls (manually operated with a push button)
♦Smoke control system	• Smoke windows installed in upper areas of the Atrium
♦Fire extinguishers	7 dry chemical extinguishers, 6 fortified liquid extinguishers
♦AED (Automated External Defibrillator)	1 location

9. Other Facilities Inside the Hall

♦Public telephone corner	2 locations
♦Drink vending machine corner	6 locations

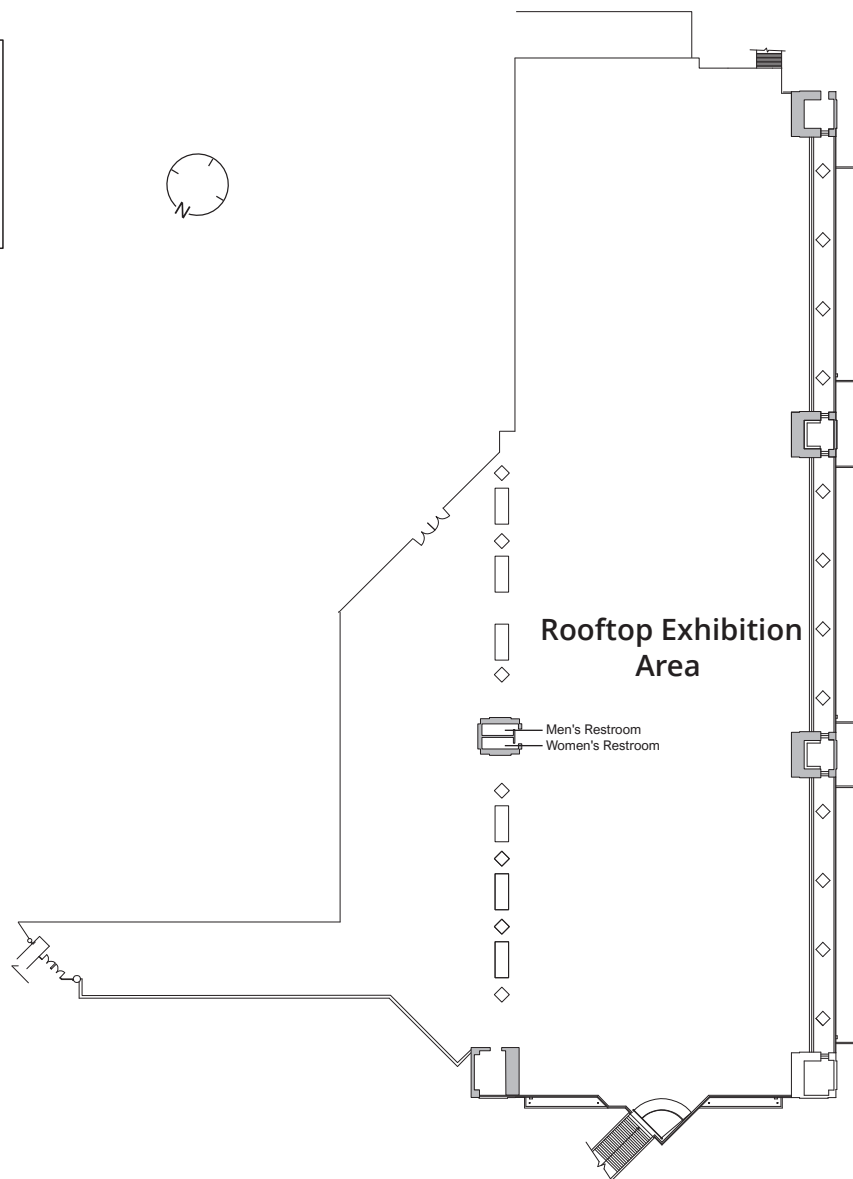
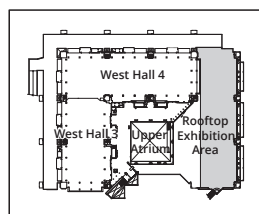

1. Building Facilities

- ◆Exhibition area 6,000 m²
- ◆Floor construction Rigid urethane
- ◆Floor load 2 t/m²
- ◆Anchor bolt placement Not allowed (hooks available)

2. Electrical Facilities

- ◆Transformer substations S8
- ◆Transformer capacity

Power	500kVA × 1 (shared with West Hall 4)
	300kVA × 1
Lighting	300kVA × 2 (shared with West Hall 4)
	200kVA × 1

* Please consult with us about nighttime lighting.

3. Communication Facilities

- ◆TV broadcast outlets 1
- ◆Communication facility outlets 1
- ◆Communication lines

Analog lines
INS 64, high-speed
broadband data links

* Accessed from subsidiary electrical pits in the floor

4. Broadcast Facilities

- ◆Intercom May receive from any hall

5. Machinery

	Rooftop exhibition area outlets
Water supply valves Water pressure 2~4Kg/cm ² (0.19~0.39 MPa) (Maximum flow rate 54m ³ /h)	2 locations 1 meter/1 line Inside the pipe shaft (25ø × 1 BV/location)
Drainage outlets and diameter	2 locations 1 meter/1 line Inside the pipe shaft (80ø × 1 BV/location) * Water may not be discharged onto the roof. Please connect to the water service pipe.
Compressed air valves and pipe diameter	None
Coolant water valves and pipe diameter	None
Secondary fire hydrants and diameter	None

*BV: Ball Valve *MPa: Megapascals (unit of pressure)

7. Ventilation Equipment

◆Mobile dry chemical fire hydrants 13 locations

6. Sanitary Facilities

◆Restrooms

	Men's Restrooms (2 locations)			Women's Restrooms (2 locations)		
	Rooftop exhibition area	4F lobby	Total	Rooftop exhibition area	4F lobby	Total
Toilet stalls (Western style)	1	5 ⁽⁻³⁾ (★1)	6	2	4 ⁽⁺²⁾ (★1)	6
Toilet stalls (Japanese style)	0	1	1	0	1	1
Urinals	2	10	12	0	0	0
Wash basins	2	4	6	2	4	6
Wheelchair accessible toilet	0	1	1	0	1	1
Baby bed	0	1	1	0	1	1

* 4F lobby toilets can be changed using the movable partition

* ★...Number of ostomate support toilets included in a total

First Floor Plan

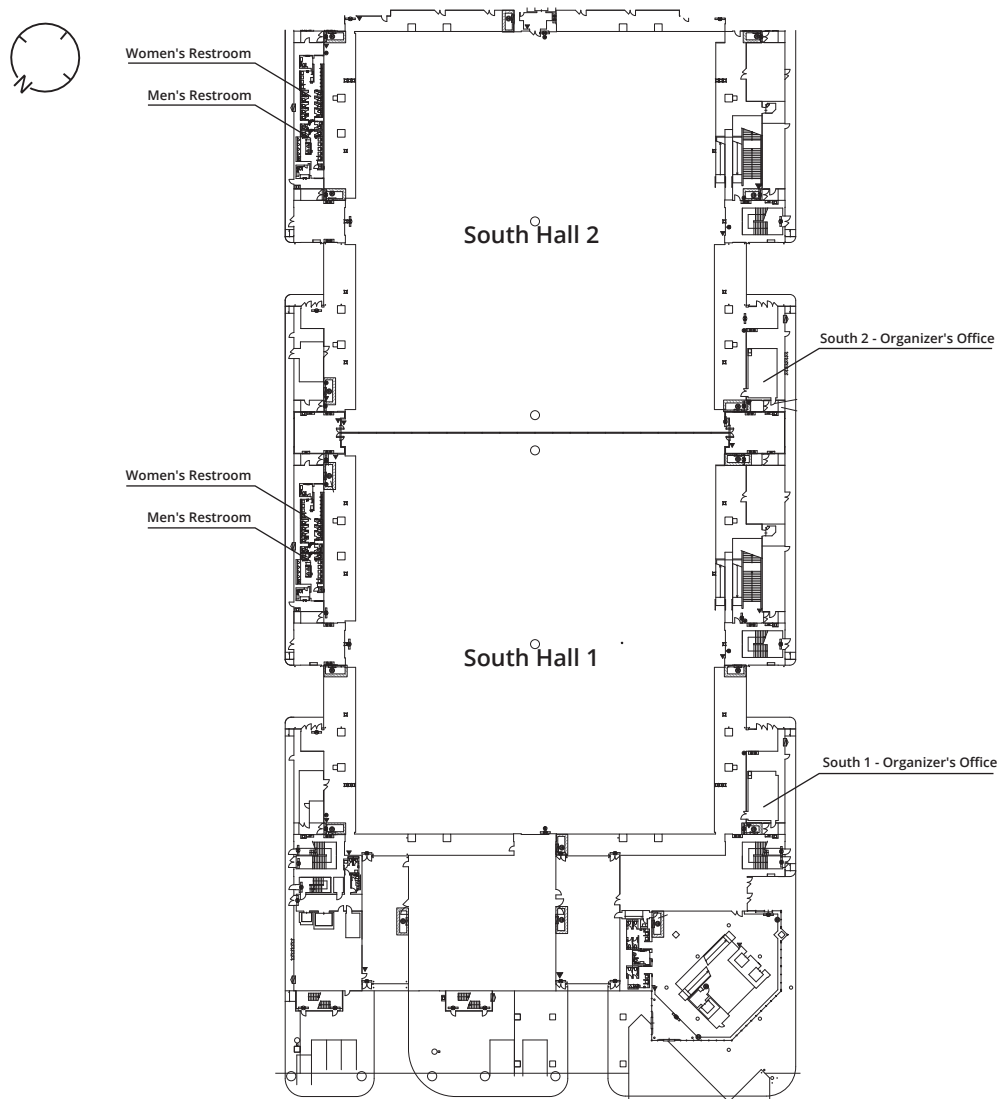

Second Floor Plan

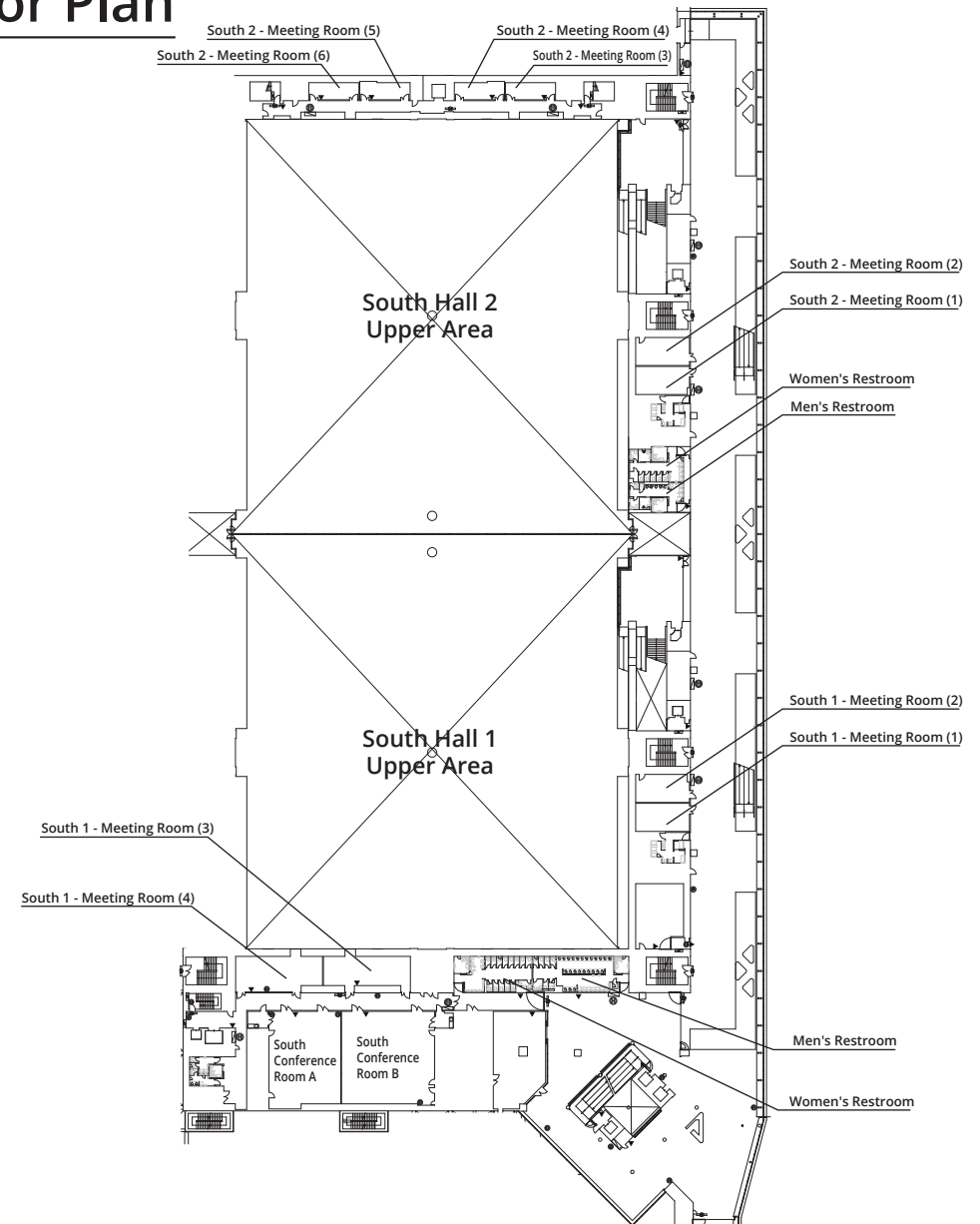

Forth Floor Plan

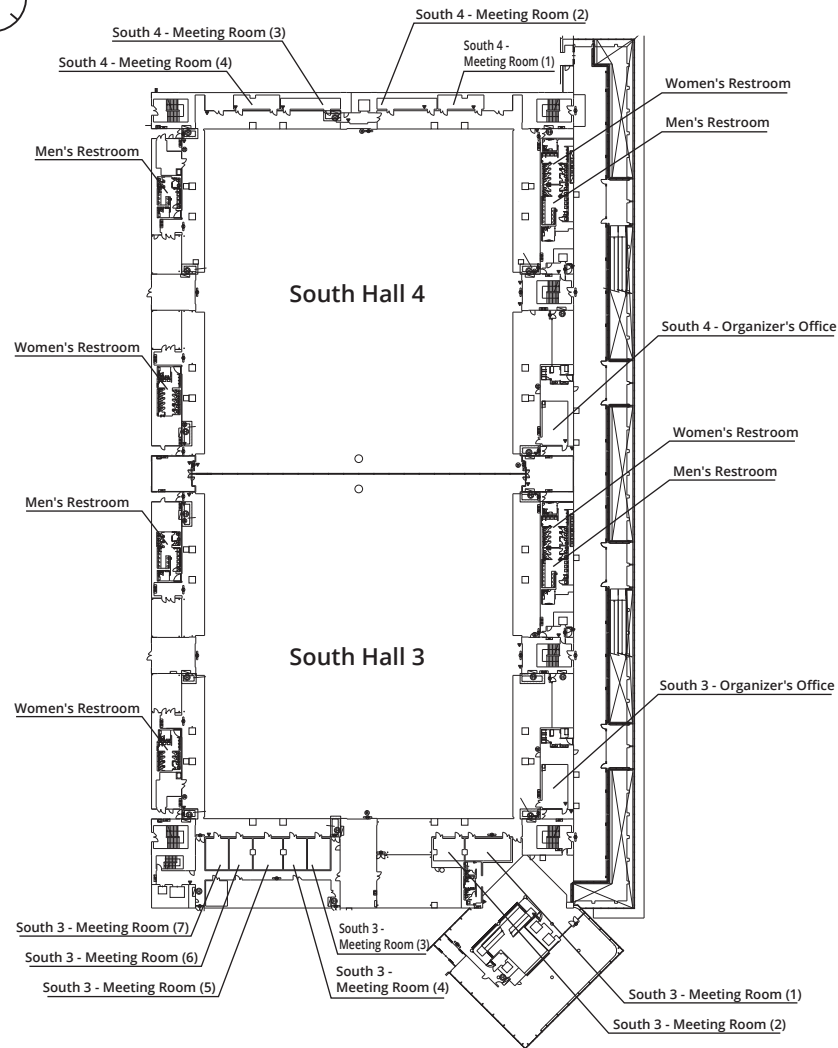

Fifth Floor Plan

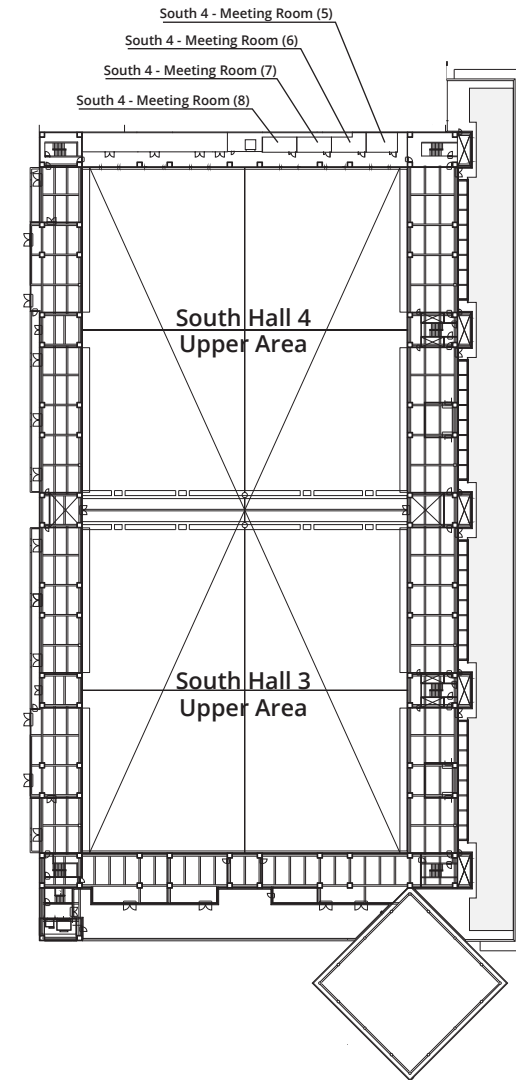

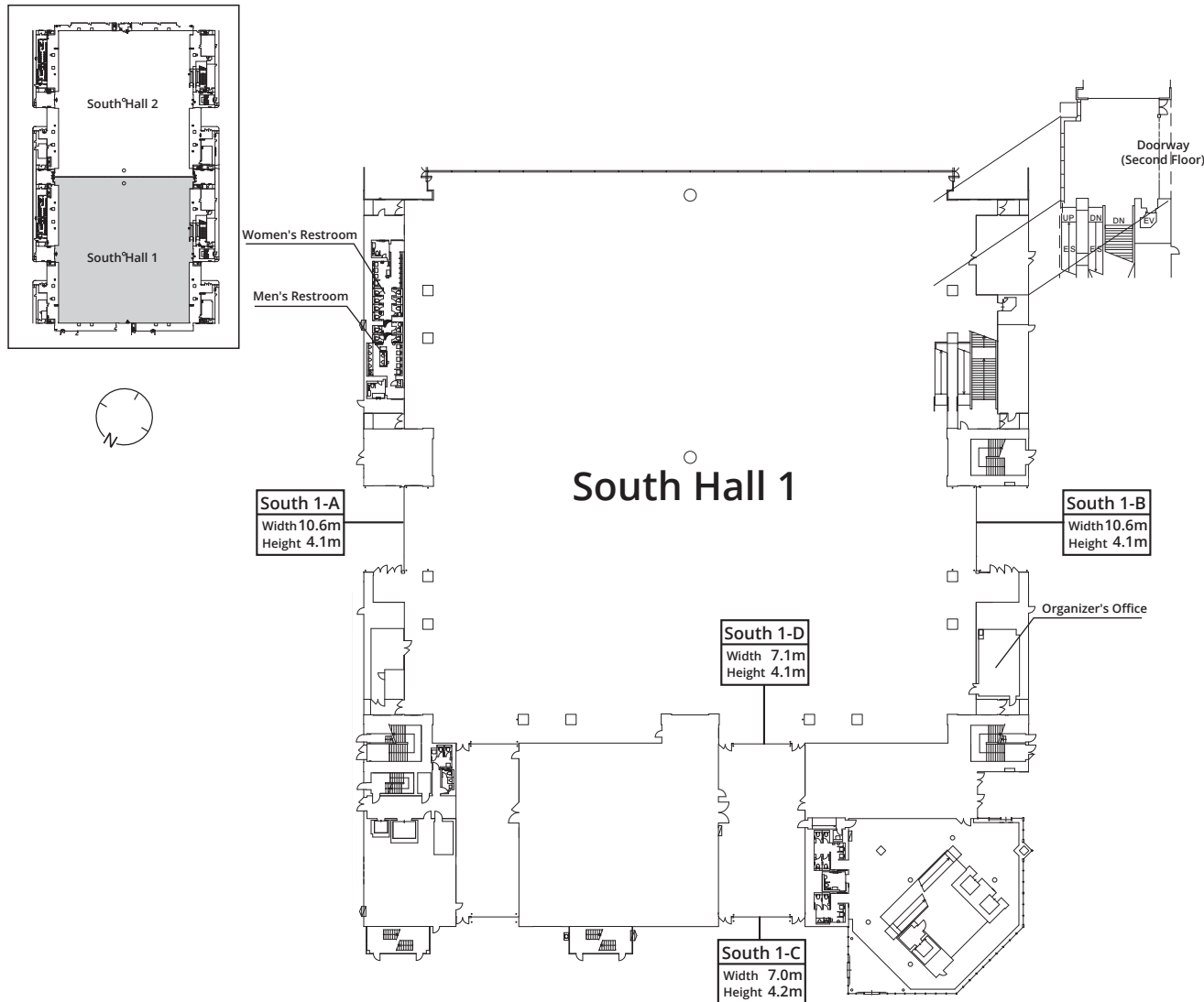

1. Building Facilities

◆ Hall exhibition area	5,000 m ²
◆ Ceiling height	12 m
◆ Floor construction	Concrete
◆ Floor load	5 t/m ²
◆ Anchor bolt placement	Possible (Max depth 60 mm, Max size 16 ø)
◆ Freight entrances	3 locations
◆ No. of pits	11 main pits 2 subsidiary pits

[Side rooms]

1F Organizer's Office (41 m ²)	
2F Meeting Room (1) (40 m ²)	Meeting Room (2) (40 m ²)
Meeting Room (3) (72 m ²)	Meeting Room (4) (80 m ²)

Total Rooms: 5

*Note Side room areas are calculated based on the internal dimensions.

2. Electrical Facilities *Accessed from electrical service pits in the floor

◆ Transformer substations	SS41
◆ Transformer capacity	Power 750kVA × 1 500kVA × 1 500kVA (400v) × 1
	Lighting 500kVA × 1 300kVA × 3
◆ Hall ceiling lighting	LED lighting

3. Communication Facilities * Accessed from subsidiary electrical pits in the floor

◆ TV broadcast outlets	36
◆ Communication facility outlets	TEL:66 LAN:36
◆ Communication lines	Analog lines INS 64, high-speed broadband data links

4. Broadcast Facilities * Installed in the organizer's office

◆ Input	1 microphone, 1 cassette player, 1 CD player with MD, 1 CD rack 1 AUX (Note: A separate mixer amp is required when using as a microphone input)
◆ Intercom	May broadcast to or receive from any hall

5. Machinery

	Outlets inside the exhibition hall	Outlets outside the exhibition hall
Water supply valves Water pressure 3~5Kg/cm ² (0.25~0.49 MPa) (Maximum flow rate 35m ³ /h)	10 locations (2 lines) 1 meter/1 line Main mechanical pit terminal (25ø × 1 BV/location) Inside trench (50ø × 1 BV/location) (80ø main pipe)	None
Drainage outlets	Connect to drainpipes in plumbing and wiring pit.	None
Compressed air valves and pipe diameter	10 locations/1 line Main mechanical pit terminal (50ø × 1 BV/location) Inside trench (50ø × 1 BV/location)	2 lines (1 locations/1 line) Truck yard side, wall-mounted (100ø × 1 BFV/location) (For attachment of compressors, etc.)
Coolant water valves and pipe diameter	10 locations/1 line Inside trench (100ø × 1 BFV/location)	2 lines (1 locations/1 line) Truck yard side, wall-mounted (100ø × 1 BFV/location) (For attachment of cooling tower, etc.)
Secondary fire hydrants and diameter	None	None

*BV: Ball Valve *BFV: Butterfly Valve *MPa: Megapascals (unit of pressure) *GV: Gate Valve

6. Sanitary Facilities

◆Hall Restrooms

	Men's Restrooms (1 locations)	Women's Restrooms (1 locations)
	Shutter A side	Shutter A side
Toilet stalls (Western style)	4(-2) (★1)	7(+2) (★1)
Urinals	7	0
Wash basins	5	4
Wheelchair accessible toilet	1	1
Baby bed	1	1

* Can be changed using the movable partition

* ★...Number of ostomate support toilets included in a total

◆Kitchenette

Inside the organizer's office	Next to the first-aid room (shared with South Hall 2)	Total
1	1	2

7. Ventilation Equipment

◆Air conditioners	16 per hall		
◆Air conditioning capabilities			
Cooling	4,936 MJ/h	Supplied air (SA)	288,000 m ³ /h
Outside air (OA)	38,800 m ³ /h	Heating	1,763 MJ/h
Recycled air (RA)	288,000 m ³ /h	Exhaust air (EA)	32,800 m ³ /h
Humidification	276.8 kg/h		

8. Fire Prevention Equipment

◆Indoor fire extinguishers	7 locations
◆Outdoor fire extinguishers	3 locations
◆Sprinkler system	Sprinkler heads mounted on the lower ceiling of the main hall and the ceiling of other related rooms
◆Fire alarm system	<ul style="list-style-type: none"> Automatic fire alarm system: Fire detectors mounted on the lower ceiling of the main hall and other related rooms Fire alarm system: Mounted on the walls of the main hall (manually operated with a push button)
◆Smoke control system	<ul style="list-style-type: none"> Main hall: Smoke windows installed in the upper areas of the hall Organizer's offices: Smoke control openings installed (forced smoke control by fans)
◆Fire extinguishers	5 dry chemical extinguishers, 8 fortified liquid extinguishers
◆AED (Automated External Defibrillator)	Organizer's office

9. Other Facilities Inside the Hall

◆Garbage disposal	1 location
-------------------	------------

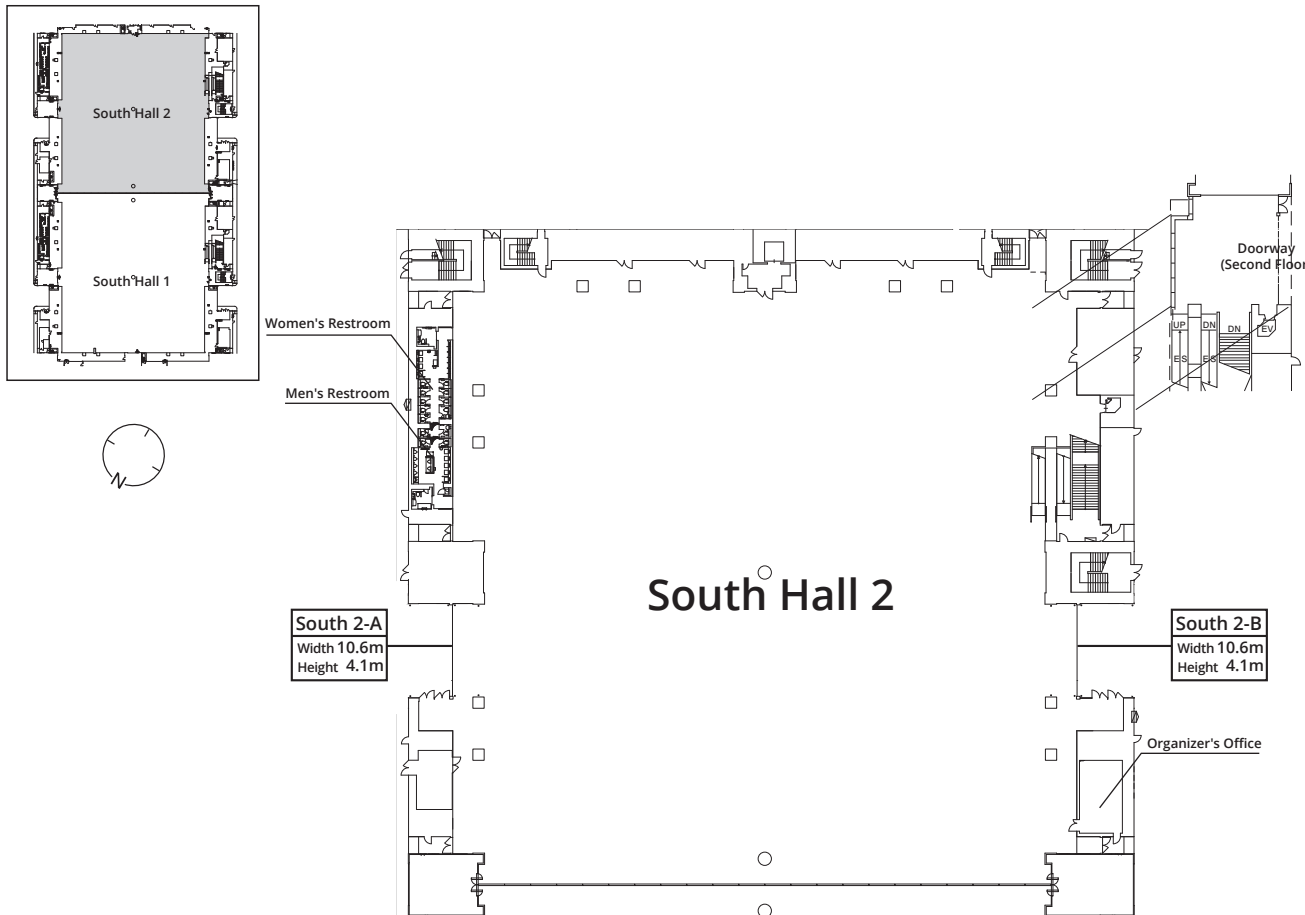

1. Building Facilities

◆ Hall exhibition area	5,000 m ²
◆ Ceiling height	12 m
◆ Floor construction	Concrete
◆ Floor load	5 t/m ²
◆ Anchor bolt placement	Possible (Max depth 60 mm, Max size 16 ø)
◆ Freight entrances	2 locations
◆ No. of pits	11 main pits 2 subsidiary pits

[Side rooms]

1F Organizer's Office (41 m ²)	
2F Meeting Room (1) (40 m ²)	Meeting Room (2) (40 m ²)
Meeting Room (3) (23 m ²)	Meeting Room (4) (23 m ²)
Meeting Room (5) (23 m ²)	Meeting Room (6) (23 m ²)
Total Rooms: 7	

*Note Side room areas are calculated based on the internal dimensions.

2. Electrical Facilities

◆ Transformer substations	SS42
◆ Transformer capacity	Power 750kVA × 1 500kVA × 1 500kVA (400v) × 1
	Lighting 500kVA × 1 300kVA × 3
◆ Hall ceiling lighting	LED lighting

3. Communication Facilities

◆ TV broadcast outlets	36
◆ Communication facility outlets	TEL:66 LAN:36
◆ Communication lines	Analog lines INS 64, high-speed broadband data links

4. Broadcast Facilities

◆ Input	1 microphone, 1 cassette player, 1 CD player with MD, 1 CD rack 1 AUX (Note: A separate mixer amp is required when using as a microphone input)
◆ Intercom	May broadcast to or receive from any hall

5. Machinery

	Outlets inside the exhibition hall	Outlets outside the exhibition hall
Water supply valves Water pressure 3~5Kg/cm ² (0.25~0.49 MPa) (Maximum flow rate 35m ³ /h)	10 locations (2 lines) 1 meter/1 line Main mechanical pit terminal (25ø × 1 BV/location) Inside trench (50ø × 1 BV/location) (80ø main pipe)	None
Drainage outlets	Connect to drainpipes in plumbing and wiring pit.	None
Compressed air valves and pipe diameter	10 locations/1 line Main mechanical pit terminal (50ø × 1 BV/location) Inside trench (50ø × 1 BV/location)	2 lines (1 locations/1 line) Truck yard side, wall-mounted (100ø × 1 BFV/location) (For attachment of compressors, etc.)
Coolant water valves and pipe diameter	10 locations/1 line Inside trench (100ø × 1 BFV/location)	2 lines (1 locations/1 line) Truck yard side, wall-mounted (100ø × 1 BFV/location) (For attachment of cooling tower, etc.)
Secondary fire hydrants and diameter	None	None

*BV: Ball Valve *BFV: Butterfly Valve *MPa: Megapascals (unit of pressure) *GV: Gate Valve

6. Sanitary Facilities

◆Hall Restrooms

	Men's Restrooms (1 locations)	Women's Restrooms (1 locations)
	Shutter A side	Shutter A side
Toilet stalls (Western style)	4(-2) (★1)	9(+2) (★1)
Urinals	7	0
Wash basins	5	4
Wheelchair accessible toilet	1	1
Baby bed	1	1

* Can be changed using the movable partition

* ★...Number of ostomate support toilets included in a total

◆Kitchenette

Inside the organizer's office	Next to the first-aid room (shared with South Hall 1)	Total
1	1	2

7. Ventilation Equipment

◆Air conditioners	16 per hall		
◆Air conditioning capabilities			
Cooling	4,936 MJ/h	Supplied air (SA)	288,000 m ³ /h
Outside air (OA)	38,800 m ³ /h	Heating	1,763 MJ/h
Recycled air (RA)	288,000 m ³ /h	Exhaust air (EA)	32,000 m ³ /h
Humidification	276.8 kg/h		

8. Fire Prevention Equipment

◆Indoor fire extinguishers	7 locations
◆Outdoor fire extinguishers	2 locations
◆Sprinkler system	Sprinkler heads mounted on the lower ceiling of the main hall and the ceiling of other related rooms
◆Fire alarm system	<ul style="list-style-type: none"> Automatic fire alarm system: Fire detectors mounted on the lower ceiling of the main hall and other related rooms Fire alarm system: Mounted on the walls of the main hall (manually operated with a push button)
◆Smoke control system	<ul style="list-style-type: none"> Main hall: Smoke windows installed in the upper areas of the hall Organizer's offices: Smoke control openings installed (forced smoke control by fans)
◆Fire extinguishers	5 dry chemical extinguishers, 8 fortified liquid extinguishers
◆AED (Automated External Defibrillator)	Organizer's office

9. Other Facilities Inside the Hall

◆Garbage disposal	1 location
-------------------	------------

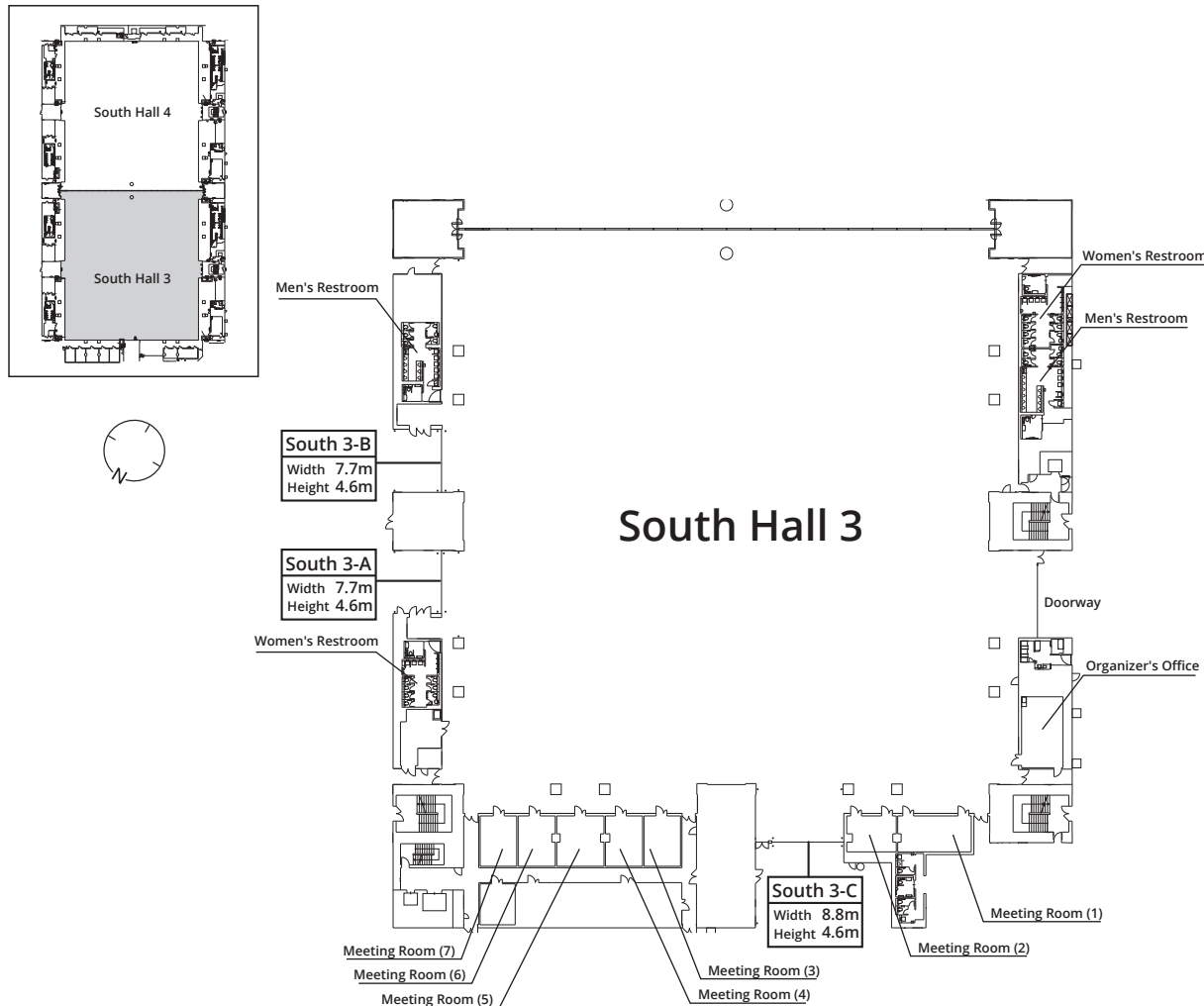

1. Building Facilities

◆Hall exhibition area	5,000 m ²
◆Ceiling height	13 to 18 m
◆Floor construction	Concrete
◆Floor load	2 t/m ²
◆Anchor bolt placement	Possible (Max depth 60 mm, Max size 16 ø)
◆Freight entrances	3 locations
◆No. of pits	10 main pits 2 subsidiary pits

[Side rooms]

1F Organizer's Office (44 m ²)	
2F Meeting Room (1) (39 m ²)	Meeting Room (2) (25 m ²)
Meeting Room (3) (27 m ²)	Meeting Room (4) (27 m ²)
Meeting Room (5) (35 m ²)	Meeting Room (6) (27 m ²)
Meeting Room (7) (27 m ²)	

Total Rooms: 8

*Note Side room areas are calculated based on the internal dimensions.

2. Electrical Facilities*Accessed from electrical service pits in the floor

◆Transformer substations	SS43
◆Transformer capacity	Power 750kVA × 1 500kVA × 1 500kVA (400v) × 1
	Lighting 500kVA × 1 300kVA × 3
◆Hall ceiling lighting	LED lighting

3. Communication Facilities* Accessed from subsidiary electrical pits in the floor

◆TV broadcast outlets	36
◆Communication facility outlets	TEL:66 LAN:36
◆Communication lines	Analog lines INS 64, high-speed broadband data links

4. Broadcast Facilities* Installed in the organizer's office

◆Input	1 microphone, 1 cassette player, 1 CD player with MD, 1 CD rack 1 AUX (Note: A separate mixer amp is required when using as a microphone input)
◆Intercom	May broadcast to or receive from any hall

5. Machinery

	Outlets inside the exhibition hall	Outlets outside the exhibition hall
Water supply valves Water pressure 2~4Kg/cm ² (0.19~0.39 MPa) (Maximum flow rate 35m ³ /h)	8 locations 1 meter/1 line Main mechanical pit terminal (25ø × 1 BV/location) 3F Maintenance space header (50ø × 1 BV/location)	None
Drainage outlets	Connect to drainpipes in plumbing and wiring pit.	None
Compressed air valves and pipe diameter	4 locations 3F Maintenance space (100ø × 1 BFV/location)	1 lines (1 locations/1 line) Truck yard side, wall-mounted (100ø × 1 BFV/location)
Coolant water valves and pipe diameter	4 locations 3F Maintenance space (100ø × 1 BFV/location)	1 lines (1 locations/1 line) Truck yard side, wall-mounted (100ø × 1 BFV/location)
Secondary fire hydrants and diameter	None	None

*It is prohibited to pipe Compressed air and Coolant water at the same pit.

6. Sanitary Facilities

◆Hall Restrooms

	Men's Restrooms (1 locations)	Women's Restrooms (1 locations)
	Truck yard side	Truck yard side
Toilet stalls (Western style)	5 (★1)	7 (★1)
Urinals	8	0
Wash basins	5	3
Wheelchair accessible toilet	1	1
Baby bed	1	1

* ★...Number of ostomate support toilets
included in a total

◆Kitchenette

Inside the organizer's office	Next to the police waiting room (shared with South Hall 4)	Total
1	1	2

7. Ventilation Equipment

◆Air conditioners	16 per hall		
◆Air conditioning capabilities			
Cooling	4,936 MJ/h	Supplied air (SA)	288,000 m ³ /h
Outside air (OA)	38,800 m ³ /h	Heating	1,763 MJ/h
Recycled air (RA)	288,000 m ³ /h	Exhaust air (EA)	32,800 m ³ /h
Humidification	276.8 kg/h		

8. Fire Prevention Equipment

◆Indoor fire extinguishers	7 locations
◆Sprinkler system	Sprinkler heads mounted on the lower ceiling of the main hall and the ceiling of other related rooms
◆Fire alarm system	<ul style="list-style-type: none"> Automatic fire alarm system: Fire detectors mounted on the lower ceiling of the main hall and other related rooms Fire alarm system: Mounted on the walls of the main hall (manually operated with a push button)
◆Smoke control system	<ul style="list-style-type: none"> Main hall: Smoke windows installed in the upper areas of the hall Organizer's offices: Smoke control openings installed (forced smoke control by fans)
◆Fire extinguishers	9 dry chemical extinguishers, 6 fortified liquid extinguishers
◆AED (Automated External Defibrillator)	Organizer's office

9. Other Facilities Inside the Hall

◆Garbage disposal	1 location
-------------------	------------

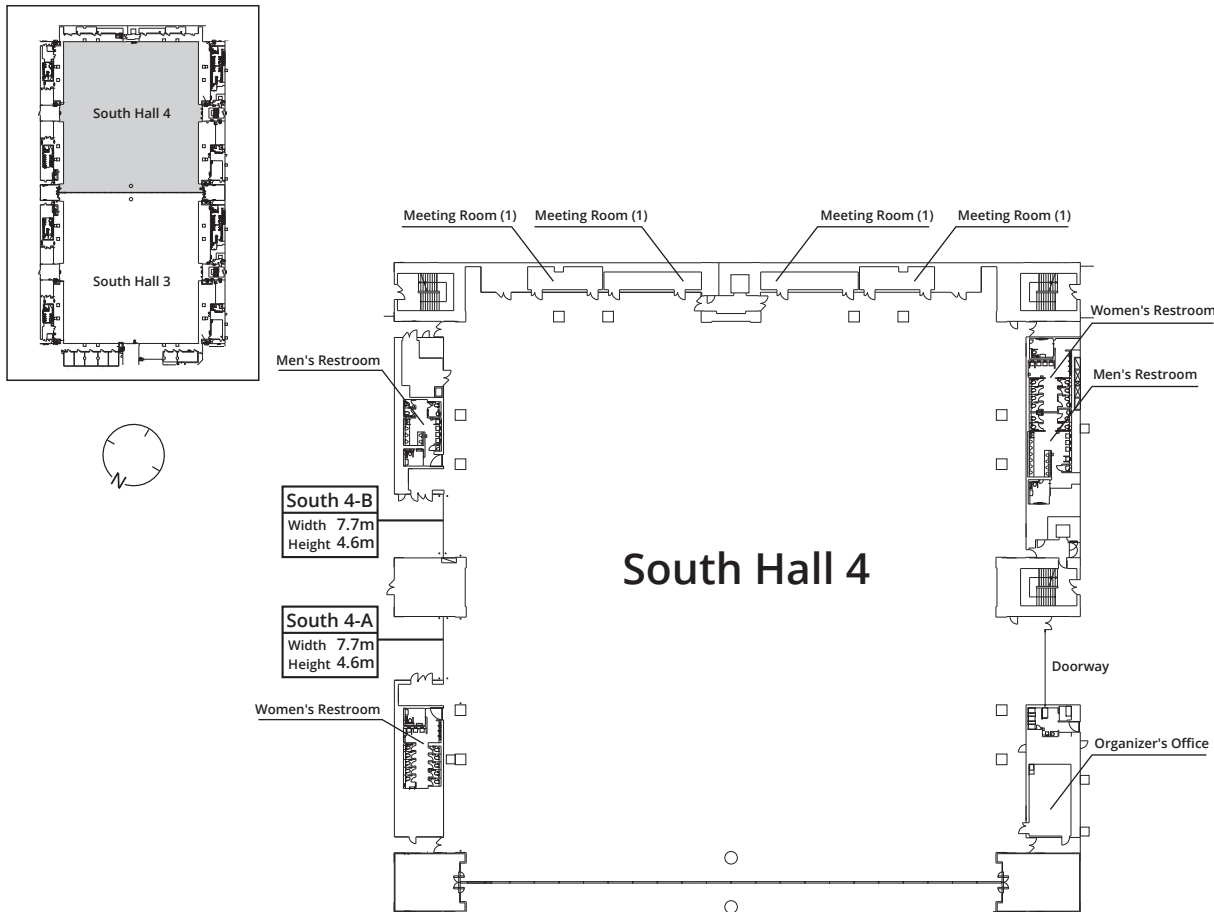

1. Building Facilities

◆Hall exhibition area	5,000 m ²
◆Ceiling height	13 to 18 m
◆Floor construction	Concrete
◆Floor load	2 t/m ²
◆Anchor bolt placement	Possible (Max depth 60 mm, Max size 16 ø)
◆Freight entrances	2 locations
◆No. of pits	10 main pits 2 subsidiary pits

[Side rooms]

1F Organizer's Office (44 m ²)	
2F Meeting Room (1) (24 m ²)	Meeting Room (2) (25 m ²)
Meeting Room (3) (25 m ²)	Meeting Room (4) (24 m ²)
Meeting Room (5) (21 m ²)	Meeting Room (6) (19 m ²)
Meeting Room (7) (19 m ²)	Meeting Room (8) (19 m ²)
Total Rooms: 9	

[*Note] Side room areas are calculated based on the internal dimensions.

2. Electrical Facilities *Accessed from electrical service pits in the floor

◆Transformer substations	SS44
◆Transformer capacity	Power 750kVA × 1 500kVA × 1 500kVA (400v) × 1
	Lighting 500kVA × 1 300kVA × 3
◆Hall ceiling lighting	LED lighting

3. Communication Facilities * Accessed from subsidiary electrical pits in the floor

◆TV broadcast outlets	36
◆Communication facility outlets	TEL:66 LAN:36
◆Communication lines	Analog lines INS 64, high-speed broadband data links

4. Broadcast Facilities * Installed in the organizer's office

◆Input	1 microphone, 1 cassette player, 1 CD player with MD, 1 CD rack 1 AUX (Note: A separate mixer amp is required when using as a microphone input)
◆Intercom	May broadcast to or receive

5. Machinery

	Outlets inside the exhibition hall	Outlets outside the exhibition hall
Water supply valves Water pressure 2~4Kg/cm ² (0.19~0.39 MPa) (Maximum flow rate 35m ³ /h)	8 locations 1 meter/1 line Main mechanical pit terminal (25ø × 1 BV/location) 3F Maintenance space header (50ø × 1 BV/location)	None
Drainage outlets	Connect to drainpipes in plumbing and wiring pit.	None
Compressed air valves and pipe diameter	4 locations 3F Maintenance space (100ø × 1 BFV/location)	1 lines (1 locations/1 line) Truck yard side, wall-mounted (100ø × 1 BFV/location)
Coolant water valves and pipe diameter	4 locations 3F Maintenance space (100ø × 1 BFV/location)	1 lines (1 locations/1 line) Truck yard side, wall-mounted (100ø × 1 BFV/location)
Secondary fire hydrants and diameter	None	None

*It is prohibited to pipe Compressed air and Coolant water at the same pit.

6. Sanitary Facilities

◆Hall Restrooms

	Men's Restrooms (1 locations)	Women's Restrooms (1 locations)
	Truck yard side	Truck yard side
Toilet stalls (Western style)	3 (★1)	10 (★1)
Urinals	6	0
Wash basins	4	3
Wheelchair accessible toilet	1	1
Baby bed	1	1

* ★...Number of ostomate support toilets
included in a total

◆Kitchenette

Inside the organizer's office	Next to the police waiting room (shared with South Hall 3)	Total
1	1	2

7. Ventilation Equipment

◆Air conditioners	16 per hall		
◆Air conditioning capabilities			
Cooling	4,936 MJ/h	Supplied air (SA)	288,000 m ³ /h
Outside air (OA)	38,800 m ³ /h	Heating	1,763 MJ/h
Recycled air (RA)	288,000 m ³ /h	Exhaust air (EA)	30,500 m ³ /h
Humidification	276.8 kg/h		

8. Fire Prevention Equipment

◆Indoor fire extinguishers	7 locations
◆Sprinkler system	Sprinkler heads mounted on the lower ceiling of the main hall and the ceiling of other related rooms
◆Fire alarm system	<ul style="list-style-type: none"> Automatic fire alarm system: Fire detectors mounted on the lower ceiling of the main hall and other related rooms Fire alarm system: Mounted on the walls of the main hall (manually operated with a push button)
◆Smoke control system	<ul style="list-style-type: none"> Main hall: Smoke windows installed in the upper areas of the hall Organizer's offices: Smoke control openings installed (forced smoke control by fans)
◆Fire extinguishers	9 dry chemical extinguishers, 6 fortified liquid extinguishers
◆AED (Automated External Defibrillator)	<ul style="list-style-type: none"> Organizer's office

9. Other Facilities Inside the Hall

◆Garbage disposal	1 location
-------------------	------------



M E M O

Tokyo Big Sight Inc.

3-11-1 Ariake, Koto-ku, Tokyo, 135-0063
Tel: +81-3-5530-1111 Fax: +81-3-5530-1222
URL: <http://www.bigsight.jp/>

Sales Promotion Dpt.	Tel: +81-3-5530-1340
Sales Division 1	Tel: +81-3-5530-1326
Sales Division 2	Tel: +81-3-5530-1327