

# For visitor use the wheelchair

## Information of the way to Tokyo Big Sight from the Station

Entrance of Tokyo Big Sight located in 2nd floor of the Conference Tower.  
Please check the route from nearby station to Tokyo Big Sight by this map.

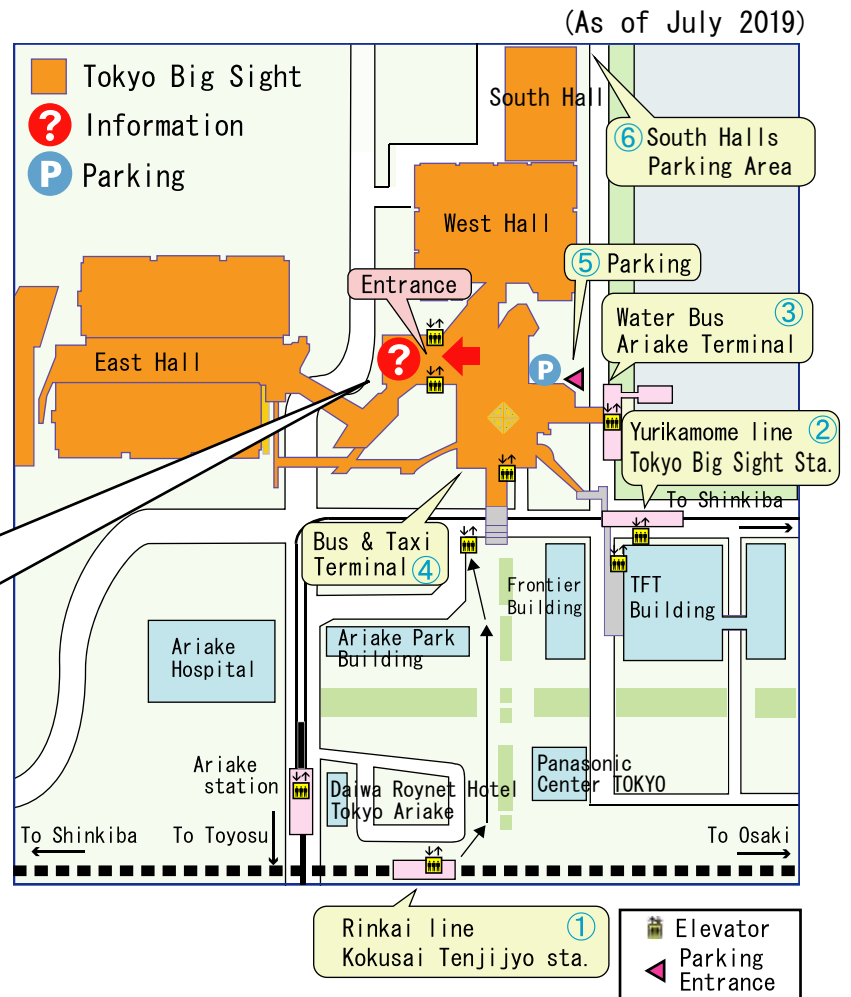
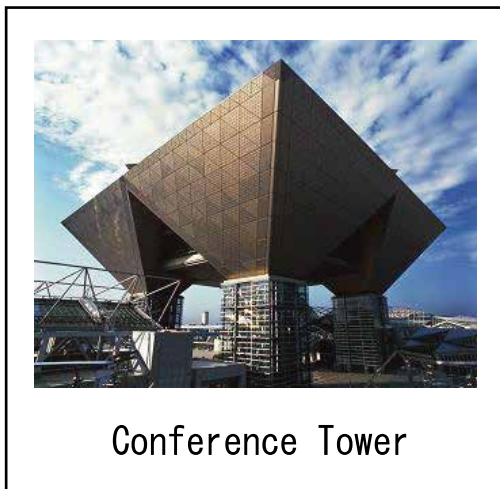

### From each transportation

- ① Rinkai Line "Kokusai Tenjijyo" sta. (1F)
- ② Yurikamome "Tokyo Big Sight" sta. (2F)
- ③ Water Bus "Ariake Terminal". (1F)
- ④ Bus & Taxi terminal. (1F)

※ When you reach entrance, and have some questions,  
Please ask information desk. (Entrance Hall 2F)

### Parking area

- ⑤ Conference Tower. (B1F)
- ⑥ South Halls Parking Area

# Information of Tokyo Big Sight

## Conference Tower

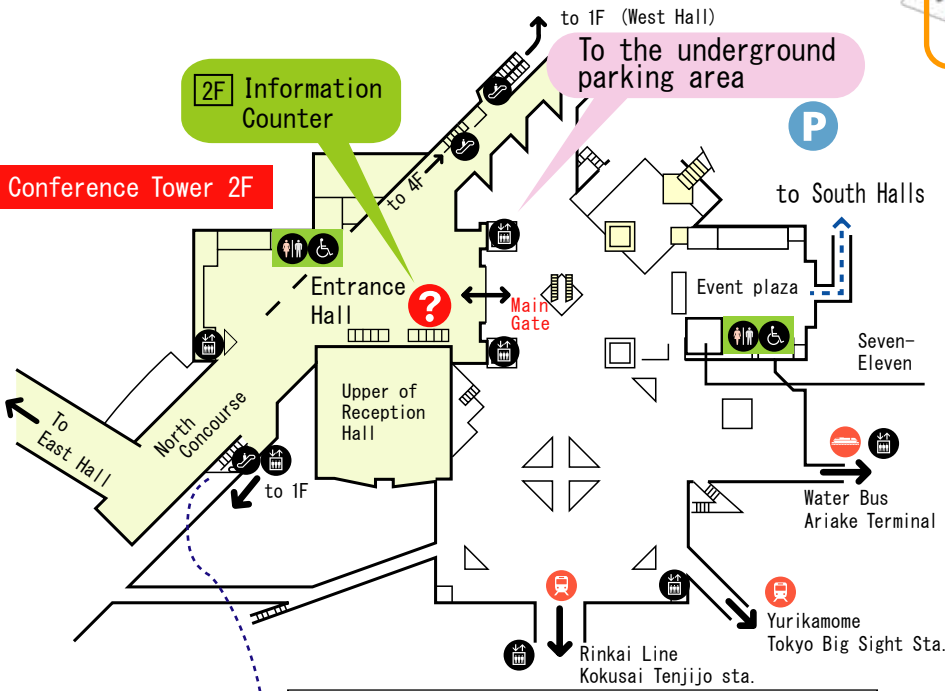
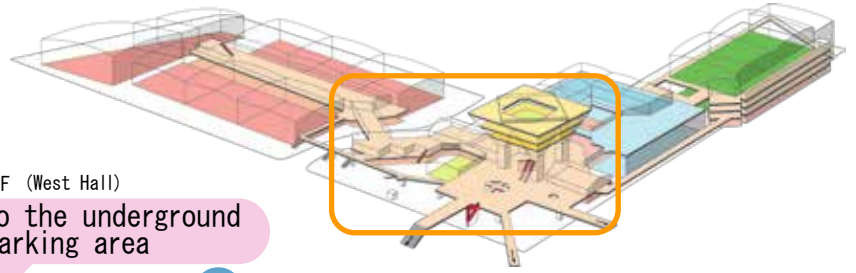

### Conference Tower 8F

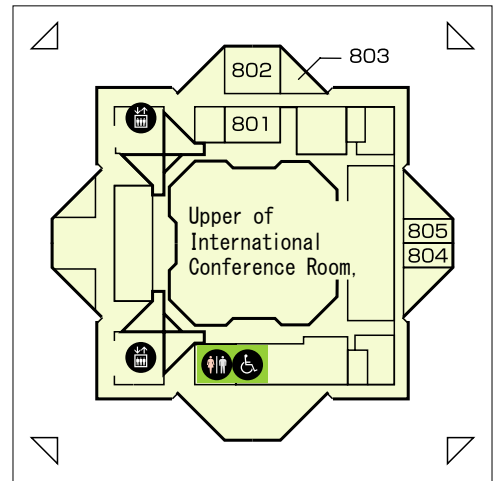

### Conference Tower 1F

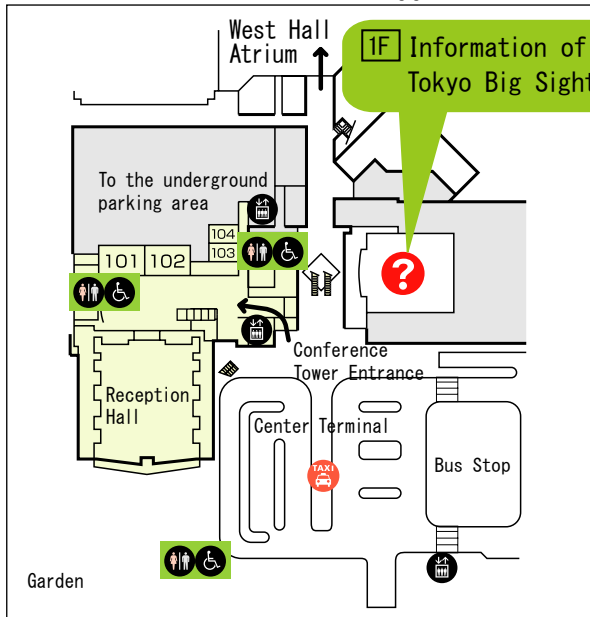
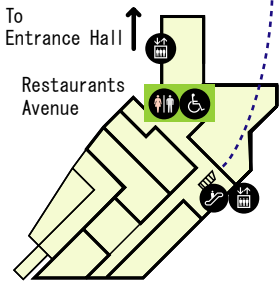

### Conference Tower 7F

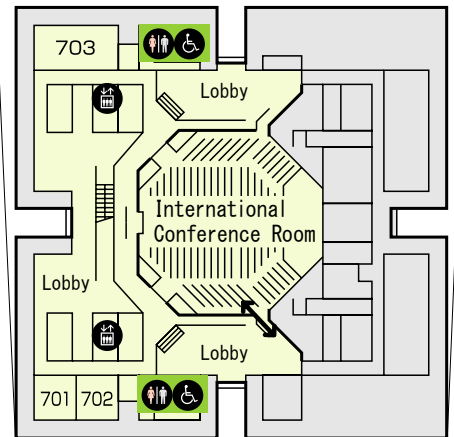

### Conference Tower 6F

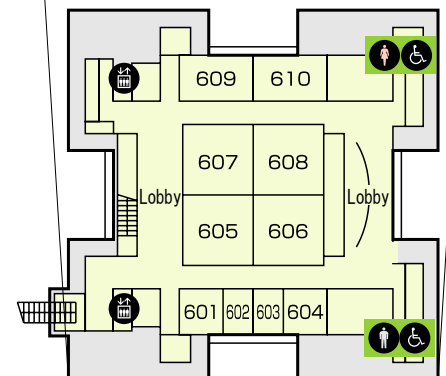

- ?** Rental of Wheelchair (Rental fee:free)
- 2F** Information Counter (Entrance Hall)
- 1F** Information of Tokyo Big Sight Inc.
- ※ Preorder cannot be done. (open 9:00-17:00)

- Entrance
- Elevator
- Escalator (※)
- Restroom (※)
- (※) Accessible facility

# Information of Tokyo Big Sight

## East Hall

※ Open during exhibitions.

※ Entrance of each Hall is 1F.  
(They will change depend on the exhibitions.)

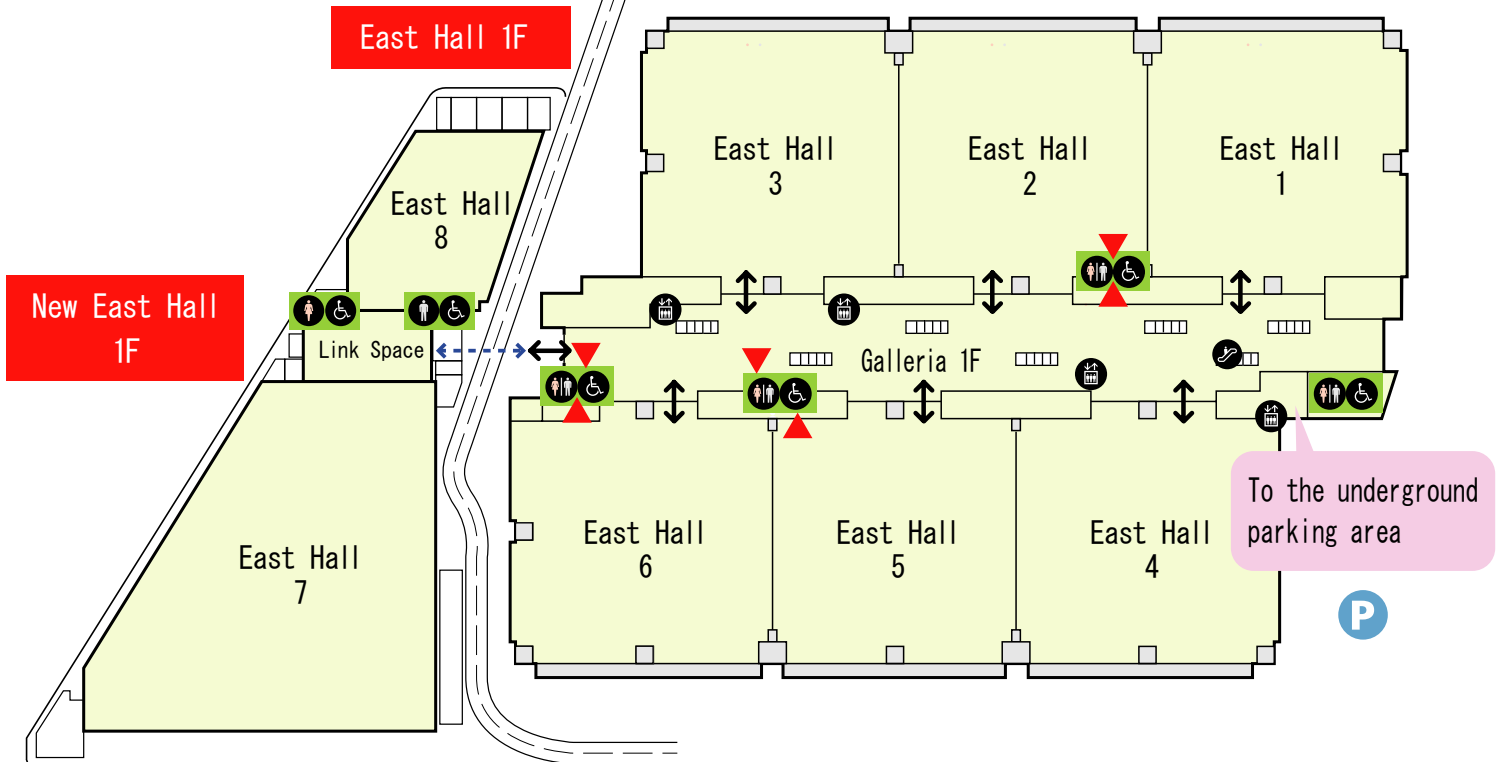
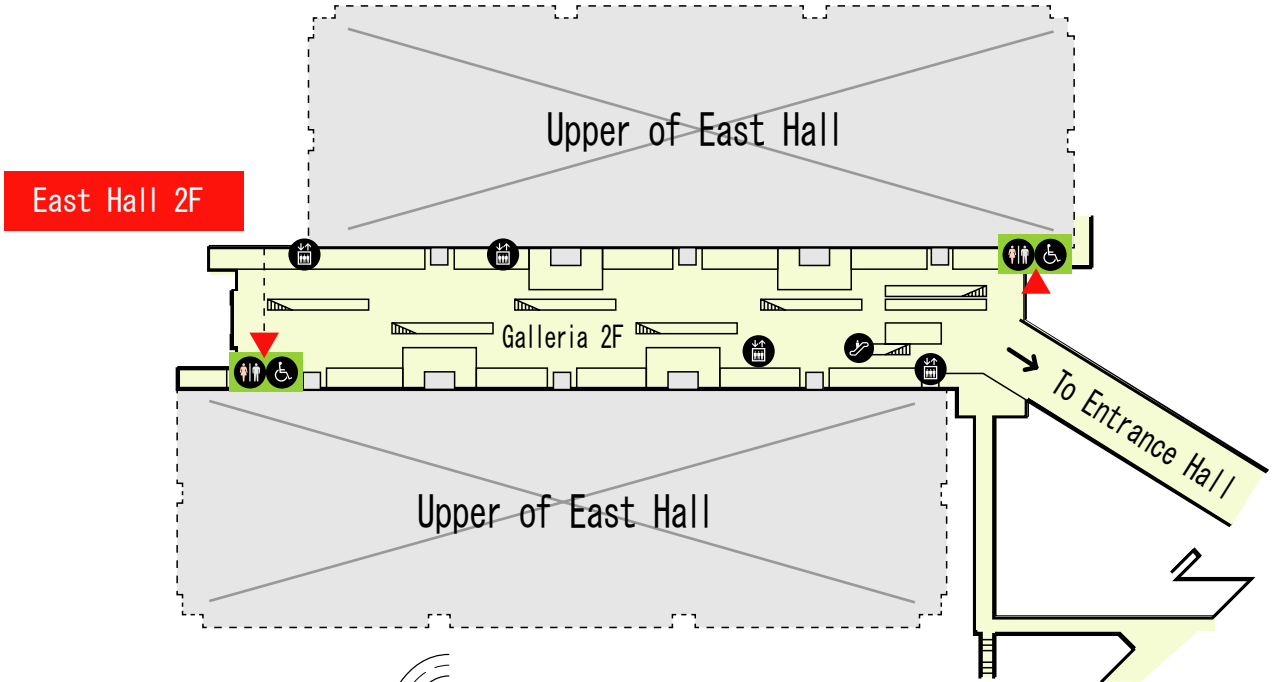
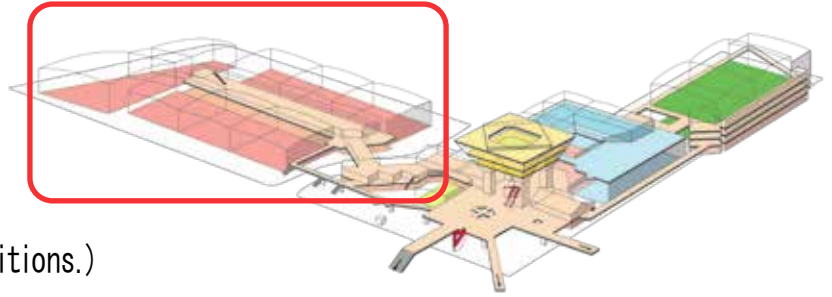

↔	Entrance		Restroom (※)
	Elevator	(※)	Accessible facility
	Escalator (※)	▲ ▼	Direction of Entrance

# Information of Tokyo Big Sight

## West Hall

※ Open during exhibitions.

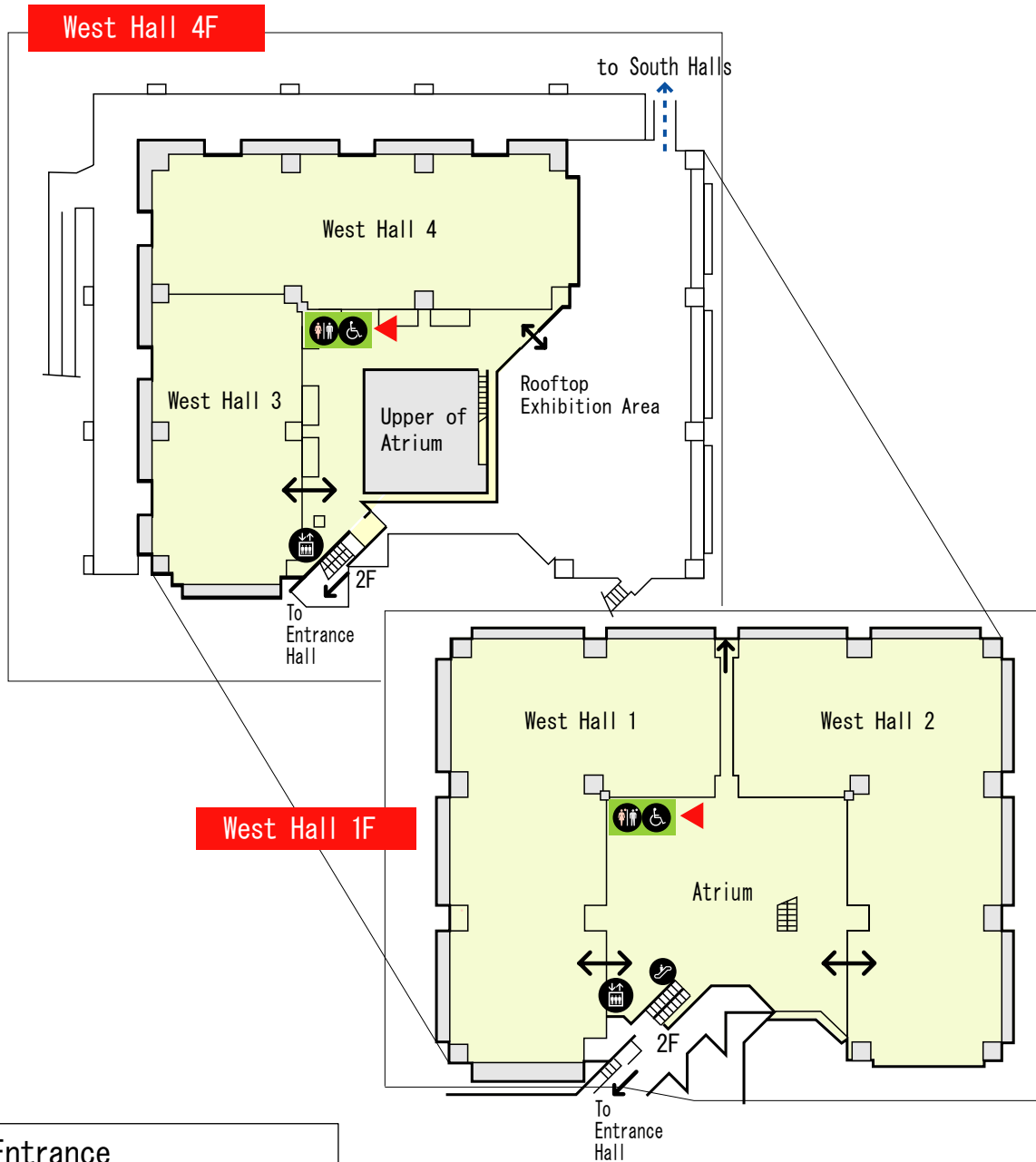
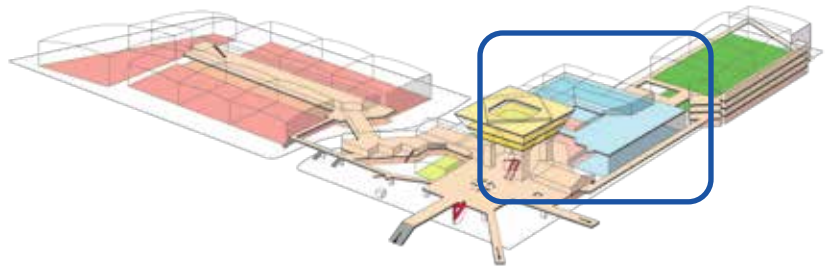

- ↔ Entrance
- ⬆️ Elevator
- ⬆️ Escalator (※)
- ♿ Restroom (※)
- (※) Accessible facility
- ◀▶ Direction of Entrance

# Information of Tokyo Big Sight

## South Hall

※ Open during exhibitions.

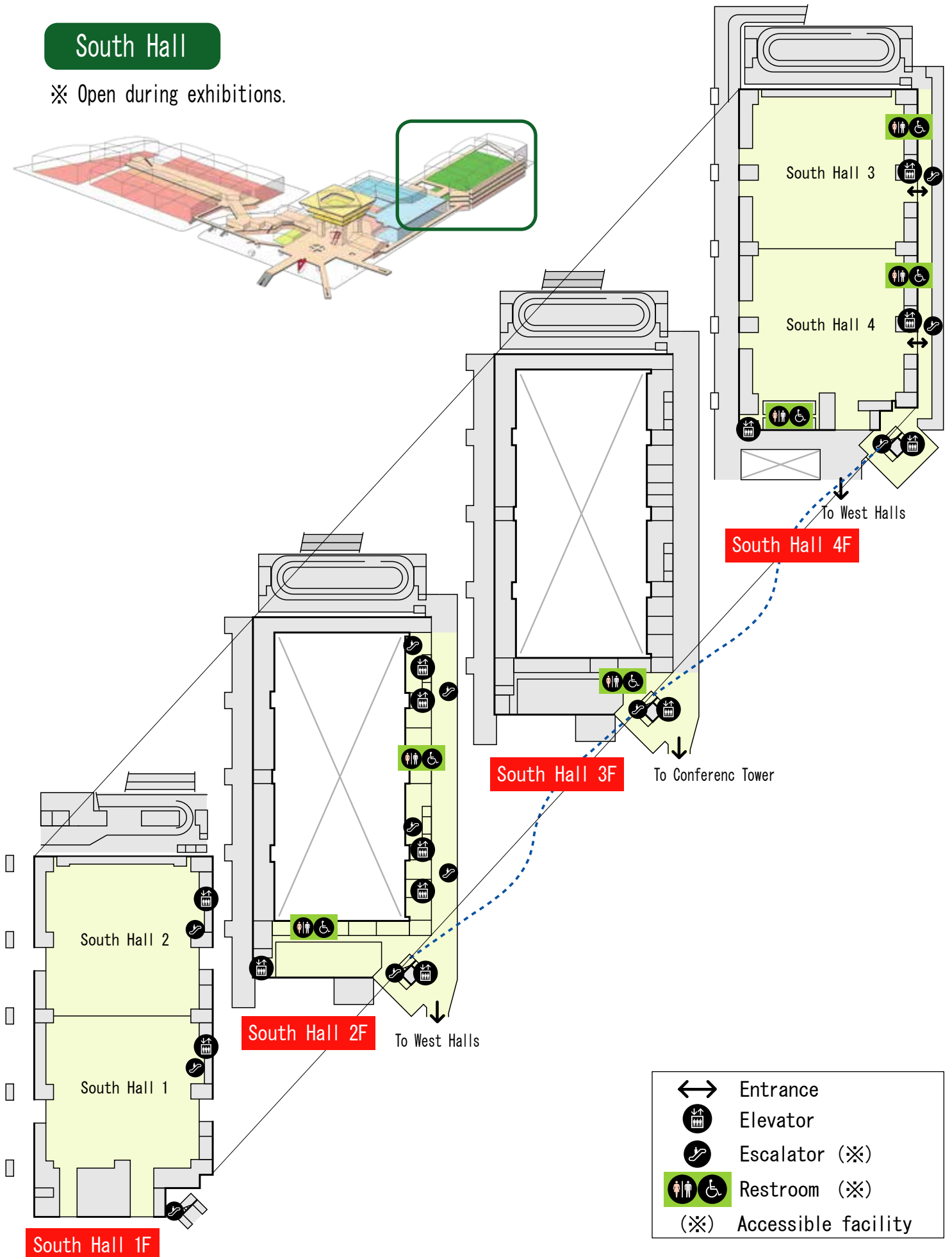
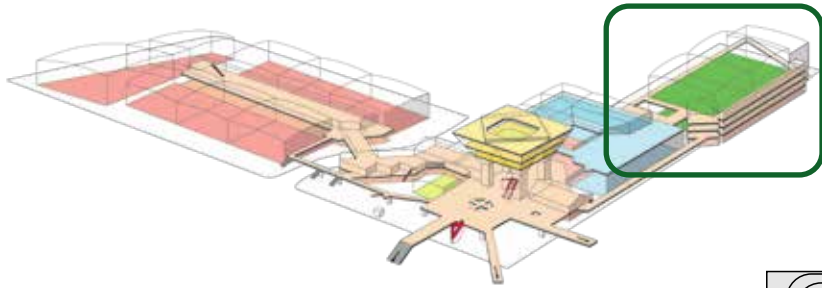

	Entrance
	Elevator
	Escalator (※)
	Restroom (※)
	(※) Accessible facility

(As of July 2019)